



TRACT AREA = 4.978 ACRES (214,656 S.F.)

COMP. NO.	NO.	DATE	DESCRIPTION
1	1	06/04/15	PRELIMINARY
2	2	06/04/15	FINAL

DATE: 06/04/15

SITE ADDRESS:
 3090 HOLLY SPRINGS ROAD
 MARIETTA, GA. 30062
 TAX ID # 16047900050 & 160479000420
 DB 10245 PG 248 & DB 12559 PG 65

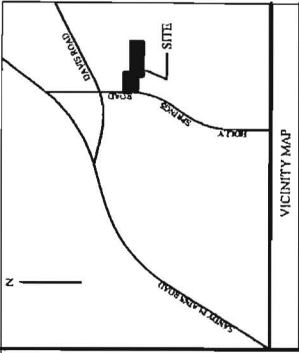

**LUP-23
(2015)**

**WITHDRAWN
WITHOUT
PREJUDICE**

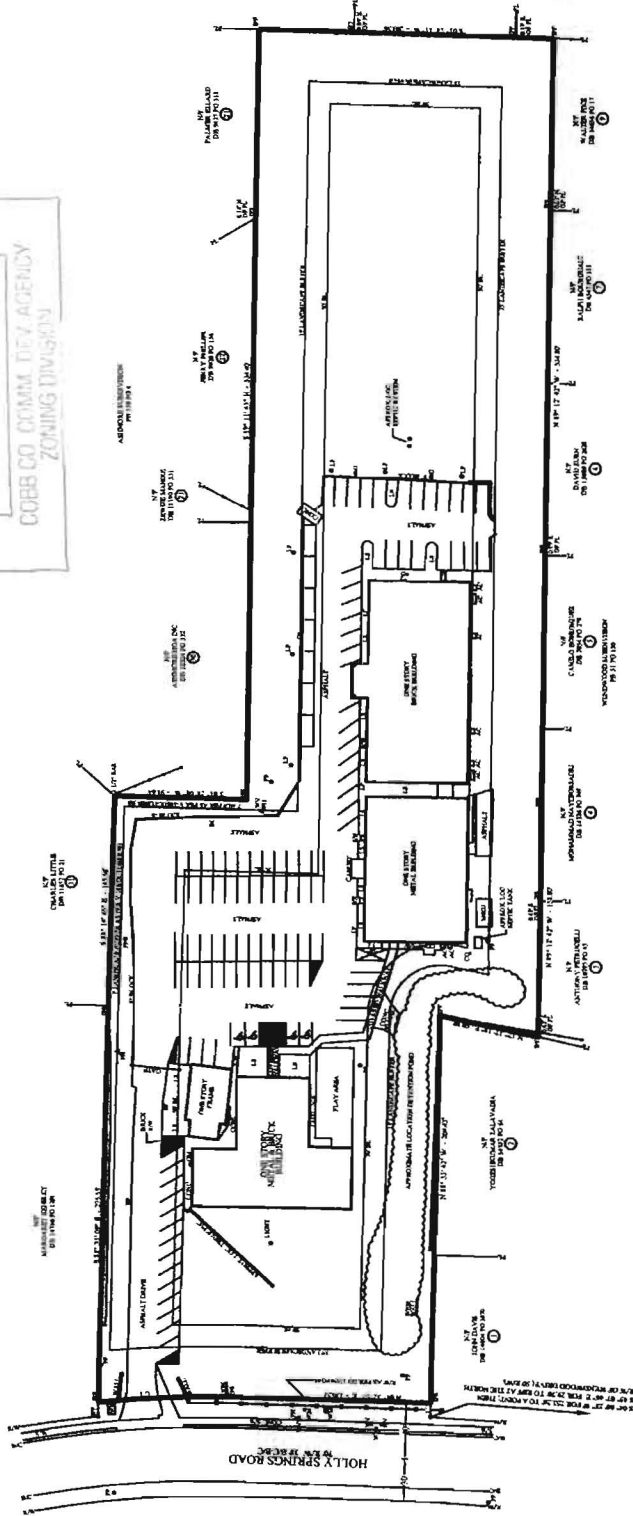

THIS PLAN HAS BEEN PREPARED BY THE ENGINEER AND ARCHITECT IN ACCORDANCE WITH THE PROFESSIONAL SEAL AND LICENSE OF THE ENGINEER AND ARCHITECT IN THE STATE OF GEORGIA. THE ENGINEER AND ARCHITECT HAVE CONDUCTED VISUAL INSPECTIONS OF THE SITE AND HAVE FOUND THAT THE INFORMATION SUBMITTED TO THEM IS TRUE AND CORRECT. THE ENGINEER AND ARCHITECT DO NOT WARRANT THE ACCURACY OF ANY INFORMATION NOT SUBMITTED TO THEM.

THIS PLAN HAS BEEN PREPARED BY THE ENGINEER AND ARCHITECT IN ACCORDANCE WITH THE PROFESSIONAL SEAL AND LICENSE OF THE ENGINEER AND ARCHITECT IN THE STATE OF GEORGIA. THE ENGINEER AND ARCHITECT HAVE CONDUCTED VISUAL INSPECTIONS OF THE SITE AND HAVE FOUND THAT THE INFORMATION SUBMITTED TO THEM IS TRUE AND CORRECT. THE ENGINEER AND ARCHITECT DO NOT WARRANT THE ACCURACY OF ANY INFORMATION NOT SUBMITTED TO THEM.



GRAPHIC SCALE IN FEET
 0 40 80 120

PROJECT	LEGACY CHRISTIAN SCHOOL, INC.
DATE	JUN 04 2015
SCALE	1" = 50'
PLAN NO.	1-1
SECTION	3RD SECTION
LOCATION	LAND LOT 479, 1668 DISTRICT, COBBLER COUNTY, GEORGIA
ENGINEER	PAUL LEE CONSULTING ENGINEERING ASSOCIATES, INC.
ARCHITECT	PAUL LEE CONSULTING ENGINEERING ASSOCIATES, INC.
PROJECT ADDRESS	3090 HOLLY SPRINGS ROAD, MARIETTA, GEORGIA 30062
PHONE	(770) 425-2710
WEBSITE	www.paullee.com

APPLICANT: Legacy Christian School, Inc.

PHONE#: (678) 640-4498 **EMAIL:** heidimilton@comcast.net

REPRESENTATIVE: Adam J. Rozen

PHONE#: (770) 422-7016 **EMAIL:** arozen@slhb-law.com

TITLEHOLDER: Elim Church of Korean Presbyterian Church in America, Inc.

PROPERTY LOCATION: East side of Holly Springs Road, south of Davis Road (3090 Holly Springs Road).

ACCESS TO PROPERTY: Holly Springs Road

PHYSICAL CHARACTERISTICS TO SITE: _____

CONTIGUOUS ZONING/DEVELOPMENT

PETITION NO: LUP-23

HEARING DATE (PC): 08-04-15

HEARING DATE (BOC): 08-18-15

PRESENT ZONING: R-20

PROPOSED ZONING: Land Use Permit

PROPOSED USE: Preschool

SIZE OF TRACT: 5.0 acres

DISTRICT: 16

LAND LOT(S): 479

PARCEL(S): 5,42

TAXES: PAID X **DUE** _____

COMMISSION DISTRICT: 3

WITHDRAWN WITHOUT PREJUDICE

NORTH:

SOUTH:

EAST:

WEST:

OPPOSITION: NO. OPPOSED **PETITION NO:** _____ **SPOKESMAN** _____

PLANNING COMMISSION RECOMMENDATION

APPROVED _____ **MOTION BY** _____

REJECTED _____ **SECONDED** _____

HELD _____ **CARRIED** _____

BOARD OF COMMISSIONERS DECISION

APPROVED _____ **MOTION BY** _____

REJECTED _____ **SECONDED** _____

HELD _____ **CARRIED** _____

STIPULATIONS:

