

Z-2
(2014)

CONTINUED

GEORGIA
STATE

2013 NOV -5 PM 3:50
COBB COUNTY ZONING DIVISION

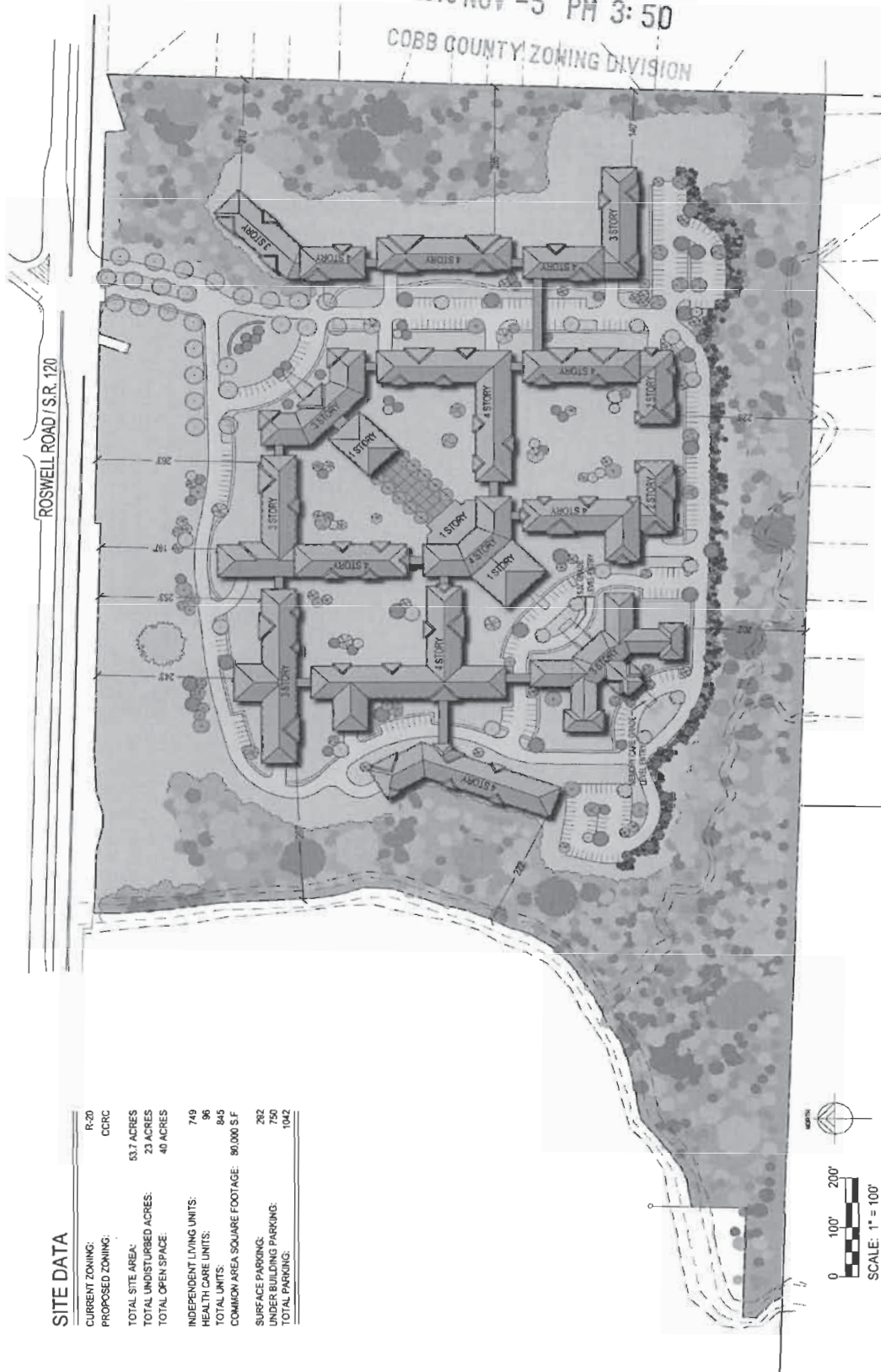

SITE DATA

CURRENT ZONING:	R-20
PROPOSED ZONING:	CCRC
TOTAL SITE AREA:	53.7 ACRES
TOTAL UNDISTURBED ACRES:	23 ACRES
TOTAL OPEN SPACE:	40 ACRES
INDEPENDENT LIVING UNITS:	749
HEALTH CARE UNITS:	96
TOTAL UNITS:	845
COMMON AREA SQUARE FOOTAGE:	80,000 S.F.
SURFACE PARKING:	292
UNDER BUILDING PARKING:	750
TOTAL PARKING:	1042

**ISAKSON LIVING
SITE PLAN**

EAST COBB COUNTY, GEORGIA

4 NOVEMBER 2013

Lantz--Boggio Architects, P.C.



APPLICANT: Isakson Living Communities, LLC

PETITION NO: Z-2

REPRESENTATIVE: J. Kevin Moore 770-429-1499
Moore, Ingram, Johnson & Steele, LLP

HEARING DATE (PC): 02-04-14

HEARING DATE (BOC): 02-18-14

TITLEHOLDER: Wylene S. Tritt

PRESENT ZONING: R-20

PROPOSED ZONING: CCRC

PROPERTY LOCATION: South side of Roswell Road, across from
Providence Road, and west of Robinson Road
(3540 Roswell Road).

PROPOSED USE: Continuing Care
Retirement Facility

ACCESS TO PROPERTY: Roswell Road

SIZE OF TRACT: 53.7 acres

DISTRICT: 16

PHYSICAL CHARACTERISTICS TO SITE: Single-family house
and wooded acreage

LAND LOT(S): 965, 966

PARCEL(S): 1

TAXES: PAID X **DUE** _____

COMMISSION DISTRICT: 2

CONTIGUOUS ZONING/DEVELOPMENT

*****CONTINUED*****

- NORTH:** LRO/Office condominiums
- SOUTH:** R-20/Hidden Hollow; R-15/Robinson Walk Subdivisions
- EAST:** R-15/Robinson Walk; RA-4/Wyntergreen and Glenside Subdivisions
- WEST:** R-20/Cobb County Park - Fullers Park

OPPOSITION: NO. OPPOSED **PETITION NO:** _____ **SPOKESMAN** _____

PLANNING COMMISSION RECOMMENDATION

APPROVED _____ **MOTION BY** _____

REJECTED _____ **SECONDED** _____

HELD _____ **CARRIED** _____

BOARD OF COMMISSIONERS DECISION

APPROVED _____ **MOTION BY** _____

REJECTED _____ **SECONDED** _____

HELD _____ **CARRIED** _____

STIPULATIONS:

