

**MARCH 19, 2013 ZONING HEARING  
“OTHER BUSINESS”  
COMMISSION DISTRICT 4**

**ITEM # 8**

**PURPOSE**

To consider a Settlement of Litigation for Bankhead C & D Transfer Station, LLC regarding rezoning application Z-42 of 2011 and Special Land Use Permit application SLUP-10 (Bankhead C & D Transfer Station, LLC) of 2011, for property located on the southwest side of Veterans Memorial Highway, east of Discovery Boulevard in Land Lot 282 and 286 of the 18<sup>th</sup> District.

**BACKGROUND**

The applicant's petition for a Rezoning and for a Special Land Use Permit (SLUP) for a municipal solid waste transfer station was denied by the Board of Commissioners on May 15, 2012. The applicant filed a lawsuit in Superior Court challenging the Board of Commissioners' decision. Prior to this case going to court, mediation occurred per standing orders of the Superior Court of Cobb County. Based on the mediation discussions, the applicant submitted a proposed settlement of litigation letter, which is attached as Exhibit A. The Board of Commissioners' decision is attached as Exhibit B, with the staff recommendations attached as Exhibit C.

**FUNDING**

N/A

**RECOMMENDATION**

The Board of Commissioners conduct a Public Hearing and consider the Settlement of Litigation proposal.

**ATTACHMENTS**

Proposed Settlement of Litigation letter (Exhibit A)  
Zoning Decision (Exhibit B)  
Staff report from original rezoning and SLUP application (Exhibit C)

**SAMS, LARKIN & HUFF**

A LIMITED LIABILITY PARTNERSHIP

GARVIS L. SAMS, JR.  
JOEL L. LARKIN  
PARKS F. HUFF  
JAMES A. BALLI

SUITE 100  
376 POWDER SPRINGS STREET  
MARIETTA, GEORGIA 30064-3448

770•422•7016  
TELEPHONE  
770•426•6583  
FACSIMILE

JUSTIN H. MEEKS

SAMSLARKINHUFF.COM

January 17, 2013

**VIA EMAIL**  
**AND HAND DELIVERY**

Joseph B. Atkins, Esq., Assistant County Attorney  
Cobb County Attorney's Office  
100 Cherokee Street, Suite 350  
Marietta, GA 30090-9698

Re: Bankhead C&D Transfer Station, LLC v. Cobb County, Georgia;  
Cobb Superior Court Civil Action File No. 12-1-5685-51

Dear Joe:

As you know, this firm represents Bankhead C&D Transfer Station, LLC ("Bankhead") concerning the above-captioned litigation. Recently, the parties and counsel participated in a mediation conference which was facilitated by Mediator, Senior Judge G. Conley Ingram. The Mediation Conference occurred on December 14, 2012 and was suspended, after reaching a tentative settlement, with the concurrence of the parties and counsel in order to allow Bankhead to open a dialogue with the Georgia Department of Transportation ("GDOT") regarding a potential reversal of its letter to Cobb County, dated April 18, 2012 ("GDOT letter").

With respect to the foregoing, the GDOT letter was predicated upon a misunderstanding that Bankhead operated as a Construction and Demolition ("C&D") landfill which, upon being co-located with another waste disposal operation, would be required to meet certain separation guidelines from public airport facilities pursuant to requirements of the Federal Aviation Administration's Advisory Circular ("FAA Circular"). As we explained to GDOT's Deputy Commissioner, Todd Long, P.E., Bankhead was never entitled nor approved as a landfill operation and has never operated in that capacity. Rather, Bankhead has always operated as a Transfer Station which has handled and proposes to continue handling both C&D and Municipal Solid Waste ("MSW").

**SAMS, LARKIN & HUFF**

A LIMITED LIABILITY PARTNERSHIP

**VIA EMAIL**  
**AND HAND DELIVERY**

Joseph B. Atkins, Esq., Assistant County Attorney  
Cobb County Attorney's Office  
January 17, 2013  
Page 2

---

Based upon GDOT's request to do so, Bankhead provided sufficient documentation ensuring that the requirements were adequately addressed thus precipitating our receipt of GDOT's most recent letter to Mr. Karl Von Hagel, Cobb County's Airport Manager, dated January 16, 2013, reversing its advisory recommendation contained within the April 18, 2012 GDOT letter.

By way of a chronological recap, you will recall that Bankhead's Rezoning and Special Land Use Permit Applications (the "Applications") were heard, considered and unanimously recommended for approval by the Cobb County Planning Commission on December 5, 2011 based upon Cobb County's Professional Staff's recommendation that the Applications be approved. Prior to the Planning Commission's recommendations for approval, Bankhead's proposal had been approved by the Atlanta Regional Commission ("ARC") as being in the best interest of the State of Georgia and the region and approved by the Georgia Regional Transportation Authority ("GRTA"). After the Applications were continued several times by the Board of Commissioners, the April 18, 2012 GDOT letter was submitted to the County and precipitated the basis for the County's staff's change in position with respect to its original recommendations for approval, thus forming the primary if not sole basis for denial of the Applications by the Cobb County Board of Commissioners, all of which led to the above-captioned litigation and the recent mediation of the case.

As a result of the mediation process and GDOT's reversal of position, this letter will confirm that the parties have agreed to settle the litigation and I have been authorized by Bankhead to submit this letter of agreeable stipulations which, if the settlement is approved and the Rezoning and Special Land Use Permit Applications are approved, shall become conditions and a part of the grant of the Rezoning and the Special Land Use Permit and binding upon the subject property thereafter. The referenced stipulations are as follows, to wit:

1. The stipulations and conditions set forth herein shall replace and supercede in full any and all prior stipulations and conditions in whatsoever form which are currently in place concerning the property which constitutes the subject matter of the above-referenced Applications.
2. The development of the subject property shall be in substantial conformity to the revised site plans prepared by Planners and Engineers Collaborative which were filed under separate cover on January 26, 2012. The future construction of any new buildings on the

**SAMS, LARKIN & HUFF**

A LIMITED LIABILITY PARTNERSHIP

**VIA EMAIL**  
**AND HAND DELIVERY**

Joseph B. Atkins, Esq., Assistant County Attorney  
Cobb County Attorney's Office  
January 17, 2013  
Page 3

---

subject property shall be accomplished only after review and approval by the District Commissioner. Any new building(s) added to the property shall be completed within one-hundred and eighty (180) days from the commencement of the construction of same.

3. The total site area of the subject property consists of 8.16 acres with an existing C&D Transfer Station which shall be modified to include MSW and potential recycling components.
4. Approval of the Applications shall be subject to GRTA's Notice of Decision, dated October 21, 2011 and ARC's Regional Review Finding, dated November 27, 2011.
5. Minor modifications to the within stipulations/conditions and the plans filed with the Applications and herewith may be reviewed and approved by the District Commissioner as needed or necessary during the Plan Review process and/or thereafter.
6. All setbacks and buffer areas (except those designated for CCCPC use) may be penetrated for purposes of detention, utilities and stormwater management as long as such encroachments satisfy Cobb County and the Metropolitan River Protection Act ("MRPA") regulations.
7. An agreement to comply with Cobb County Development Standards and Ordinances related to project improvements except as otherwise approved by the Board of Commissioners, the Cobb County Department of Transportation or the Cobb County Community Development Agency, as their respective authority may allow.
8. Compliance with recommendations of the CCCPC with respect to the Turner-Sewell Cemetery which is located on the subject property as follows:
  - a. The cemetery area has been surveyed by a qualified archaeologist who has identified the location of all gravesites and established the cemetery boundary as reflected in the Archaeological Reconnaissance prepared by R. S. Webb & Associates, dated July 17, 1997.
  - b. The reestablishment of a fifty foot (50') cemetery preservation buffer and conveying same to Cobb County in the form of a Conservation Easement.

**SAMS, LARKIN & HUFF**

A LIMITED LIABILITY PARTNERSHIP

**VIA EMAIL**  
**AND HAND DELIVERY**

Joseph B. Atkins, Esq., Assistant County Attorney  
Cobb County Attorney's Office  
January 17, 2013  
Page 4

---

- c. Relocating the existing six foot (6') high chain-link fence (with the inclusion of a gate) around the perimeter of the cemetery and/or constructing an additional fence so that the positioning of said fence encompasses the cemetery and the fifty foot (50') cemetery preservation buffer.
  - d. The installation of orange protective fence along the outside of the cemetery preservation buffer during any construction on the site.
  - e. With respect to that portion of the cemetery preservation buffer which may have been inadvertently cleared, replacing said buffer in full.
  - f. There is an existing twenty foot (20') easement to the cemetery and a parking easement at the cemetery gate. The cemetery shall remain accessible from dawn to dusk seven (7) days a week from Veterans Memorial Highway and continual access provided by way of key code gate.
  - g. Bankhead shall undertake whatever remedial measures are needful or necessary in order to ensure that the cemetery and its preservation buffer are not subject to erosion and/or stormwater management problems.
  - h. Bankhead shall undertake remedial measures in order to remove any and all dead trees from the cemetery's preservation buffer and to preserve the integrity of the existing fence and any new fencing.
9. The building which will be utilized in connection with the Transfer Station shall consist of an enclosed, Recovered Material Process Facility ("RMF").
10. All processing operations of the RMF shall be carried on inside the building, including the delivery of materials and the removal of same for transport.

**SAMS, LARKIN & HUFF**

A LIMITED LIABILITY PARTNERSHIP

**VIA EMAIL  
AND HAND DELIVERY**

Joseph B. Atkins, Esq., Assistant County Attorney  
Cobb County Attorney's Office  
January 17, 2013  
Page 5

---

11. There will be approximately forty-eight (48) truck trips per day to and from the subject property predicated upon the approval of the Applications. Additionally, it is anticipated that employee vehicular trips to and from the subject property will consist of approximately ten (10) trips per day.<sup>1</sup>
12. The hours of operation for the Transfer Station will be from 5:00 a.m. until 6:00 p.m. Monday through Friday and Saturday from 8:00 a.m. until 1:00 p.m. with the business being closed on Sundays.
13. The RMF facility shall be a "clean RMF" meaning that it shall not separate recyclable materials from general garbage and waste and shall accept source-separated recyclable materials.
14. The doors used to allow vehicles to deliver materials shall be closed except when active deliveries are occurring.
15. The RMF shall contain a dust and odor suppression system including overhead misters which will apply water and deodorizer periodically to control dust and odor within the building.
16. The RMF shall contain air dispersion exhaust fans and provide for the manual application of water provided from wash down stations within the building.
17. Any necessary repairs to the odor control systems shall be made within forty-eight (48) hours or notifications shall be provided to the County if the repairs can not be made within that time frame. In such an event, it will be necessary to obtain a temporary replacement system or secure approval from the Community Development Director for an extension of time in which to perform the necessary repair work.

---

<sup>1</sup> The route taken for the C & D component is from Veterans Memorial Highway to I-285 South to 85 South in order to access Safeguard C & D Landfill in Fairburn, Georgia. With respect to the MSW component, the routes are either from Veterans Memorial Highway West to Highway 278 towards Rockmart or from Veterans Memorial Highway to Discovery Boulevard to I-20 West then taking the Thornton Road exit towards Rockmart to the Grady Road Landfill.

**SAMS, LARKIN & HUFF**  
A LIMITED LIABILITY PARTNERSHIP

**VIA EMAIL**  
**AND HAND DELIVERY**

Joseph B. Atkins, Esq., Assistant County Attorney  
Cobb County Attorney's Office  
January 17, 2013  
Page 6

---

18. The tipping floor shall be washed out at least two (2) times per week or more if deemed necessary.
19. All liquid waste and waste water from inside the building shall be routed to the sanitary sewer with the plan to be approved by Cobb County during the Plan Review process.
20. There shall be no outdoor storage of trash or trucks which have trash in them.
21. The County Arborist shall approve a landscaping plan at Plan Review which will ensure a visual and noise abatement screen. Additionally, an agreement to form a Landscape Advisory Committee consisting of Bankhead, a representative from MIC, a representative from CCCPC and the Director of the Community Development Agency who shall facilitate decisions and be the final arbiter with respect to issues upon which Bankhead, MIC and CCCPC can not agree.

The Landscape Plan which shall be submitted during the Plan Review process shall include the planting of Leland Cypress trees along the northwestern property line from the perimeter of the Turner Sewell Cemetery going southwesterly along said property line and the planting of Leland Cypress trees (to the extent that topography allows for same) along the subject property's southeasterly property line. Said Leland Cypress trees shall consist of a five (5) gallon minimum and will be monitored for three (3) years to ensure adequate growth and health.

The construction of an eight foot (8') privacy fence to be erected along the southeastern side of the property beginning behind the existing office and continuing back to the southeast corner of the subject property. Additionally, the construction of an eight foot (8') privacy fence to be erected along the southwesterly side of the subject property, including the perimeter of the cemetery, which will also encompass the fifty foot (50') cemetery preservation buffer.

If, during construction, the dirt mound presently located on the northwest side of the subject property is disturbed, then an eight foot (8') fence shall be erected along with complementary Leland Cypress trees along said fence. Lastly, an eight foot (8') fence shall be constructed along the entire length of the rear property line with complementary Leland Cypress trees.

**SAMS, LARKIN & HUFF**

A LIMITED LIABILITY PARTNERSHIP

**VIA EMAIL**  
**AND HAND DELIVERY**

Joseph B. Atkins, Esq., Assistant County Attorney  
Cobb County Attorney's Office  
January 17, 2013  
Page 7

---

22. An agreement to designate an on-site project manager during construction and an on-site operational manager/supervisor during the operation of the RMF. The Operations Manager shall be on duty at all times while the facility is open for business.
23. An agreement to incorporate odor control measures such as odor neutralizing spray systems at each door, overhead odor neutralizing misters throughout the buildings and high velocity air dispersion exhaust fans.
24. Manual application of water shall be provided from the wash down stations from inside of the building with water and oil separators also included inside of the building.
25. The subject property shall be kept clear of debris at all times.
26. Bankhead shall be responsible for cleaning up any litter/debris on Veterans Memorial Highway which may inadvertently come off of trucks delivering to the site and this clean-up should occur at a minimum of once per week or more as needed or necessary.
27. Compliance with recommendations from the Cobb County Water System with respect to the availability of water and sewer to the subject property. This will include connecting the development to sewer which is located on an adjacent tract. Additionally, it will require the submission of an application for a revised Industrial Discharge Service Permit.
28. Compliance with recommendations from Stormwater Management Division with respect to hydrology, detention and downstream considerations, including the following:
  - a. The formulation of a Spill Prevention Plan notwithstanding the fact that no hazardous materials are planned for the site.
  - b. A revision to Bankhead's NPDES permit for purposes of discharge.



**SAMS, LARKIN & HUFF**  
A LIMITED LIABILITY PARTNERSHIP

**VIA EMAIL**  
**AND HAND DELIVERY**

Joseph B. Atkins, Esq., Assistant County Attorney  
Cobb County Attorney's Office  
January 17, 2013  
Page 8

---

- c. Compliance with MRPA Corridor Regulations.<sup>2</sup> If additional MRPA review is necessary, then said plans shall come back to the Board of Commissioners and the Landscape Advisory Committee for review.
  - d. The installation of an oil/water separator to treat stormwater as required by Cobb County.
  - e. The installation of curb and gutters on the northeast side of the entrance from Veterans Memorial Highway to the exiting office building. Additionally, the construction of two (2) new lanes on the property for the purposes of ingress and egress for a length of at least fifty feet (50') from the subject property's entrance.
29. Bankhead shall create and maintain a Vector Control Plan on the subject property which shall detail the program for domesticated animal control as well as rodent and insect extermination. An outside exterminating company shall be utilized to exterminate insects and rodents which includes exterminating sprays, poisonous baits and traps. Said service shall be provided on a monthly basis and increased as situations may warrant.
30. Compliance with recommendations of the Cobb County Department of Transportation as follows:
- a. The installation of sidewalk along the subject property's frontage on Veterans Memorial Highway.
  - b. The installation of a deceleration lane with a taper at the subject property's point of ingress/egress on Veterans Memorial Highway.
  - c. Securing approval from the Georgia Department of Transportation with respect to any encroachments or work done within the right-of-way of Veterans Memorial Highway which is a State right-of-way.

---

<sup>2</sup> The preponderance of the subject property is "grandfathered" with respect to impervious surfaces and vulnerability requirements.

**SAMS, LARKIN & HUFF**

A LIMITED LIABILITY PARTNERSHIP

**VIA EMAIL**  
**AND HAND DELIVERY**

Joseph B. Atkins, Esq., Assistant County Attorney  
Cobb County Attorney's Office  
January 17, 2013  
Page 9

---

The subject property is bordered by Heavy Industrial ("HI") and General Commercial ("GC") zoned and utilized properties and on the north by Veterans Memorial Highway, a major arterial right-of-way. It is surrounded by all manner of Heavy Industrial uses, including trucking transport facilities, heavy contractors, industrial manufacturers, a crane company and other industrial users. The settlement of litigation and the proposal to add MSW to the existing C&D Transfer Station is consistent with Cobb County's Comprehensive Land Use Plan and Future Land Use Map which reflect that the subject property is an industrial area. All of the objective criteria under the Cobb County Zoning Ordinance related to rezonings and Special Land Use Permits have been satisfied and the proposal by Bankhead is entirely appropriate particularly when considered in the context of development in which the subject property is situated.

It is my understanding that this proposal to settle the litigation, tentatively approved through mediation, will be heard and considered by the Cobb County Board of Commissioners on its "Other Business" Agenda immediately following the regularly scheduled zoning hearings on February 19, 2013. In that regard, the subject property will be posted in a timely fashion. Please do not hesitate to contact me should you, the County's professional staff, or members of the Cobb County Board of Commissioners require additional information or documentation prior to this proposed settlement of litigation being heard and considered for final action by the Board of Commissioners next month. With kind regards, I am

Very truly yours,

SAMS, LARKIN & HUFF, LLP

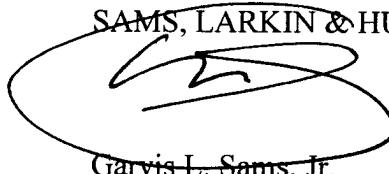
A handwritten signature in black ink, appearing to be "G. Sams", is written over the firm name "SAMS, LARKIN & HUFF, LLP". The signature is enclosed within a large, loopy oval shape.

Garvis L. Sams, Jr.  
[gsams@samslarkinhuff.com](mailto:gsams@samslarkinhuff.com)

GLS/dsj

**SAMS, LARKIN & HUFF**

A LIMITED LIABILITY PARTNERSHIP

**VIA EMAIL**  
**AND HAND DELIVERY**

Joseph B. Atkins, Esq., Assistant County Attorney  
Cobb County Attorney's Office  
January 17, 2013  
Page 10

---

cc: Members, Cobb County Board of Commissioners (via email and hand delivery)  
Mr. Robert L. Hosack, Jr., AICP, Director (via email and hand delivery)  
Mr. Dana Johnson, AICP, Manager Planning Division (via email and hand delivery)  
Mr. John P. Pederson, AICP, Manager, Zoning Division (via email and hand delivery)  
Mr. Jason Campbell, Planner II, Cobb County Community Development Agency  
(via email and hand delivery)  
Ms. Jane Stricklin, P.E. (via email)  
Mr. David Breaden, P.E. (via email)  
Ms. Karen King, Assistant County Clerk (via email)  
Ms. Lori Barton, Deputy County Clerk (via email)  
Ms. Helga Hong, CCCPC (via email)  
Mr. Kenneth J. Wood, P.E. LEED AP, Planner and Engineers Collaborative, Inc.  
(via email)  
Bankhead C&D Transfer Station, LLC (via email)

Keith Golden, P.E., Commissioner



**GEORGIA DEPARTMENT OF TRANSPORTATION**

One Georgia Center, 600 West Peachtree Street, NW  
Atlanta, Georgia 30308  
Telephone: (404) 631-1000

**Other Business Item 8  
Exhibit A**

January 17, 2013

Mr. Karl Von Hagel  
Airport Manager  
Cobb County Airport–McCollum Field  
1723 McCollum Pkwy, Bldg 100  
Kennesaw, GA 30144

Dear Mr. Von Hagel,

The Department is in receipt of correspondence from Bankhead C & D Transfer Station, dated January 8, 2013, providing additional documentation regarding proposed changes to the Bankhead C & D Transfer Station. As you are aware, the Department's interest lies in ensuring compliance with guidelines found in FAA's Advisory Circular (AC) 150/5200-33B, 'Hazardous Wildlife Attractants On or Near Airports.'

Our evaluation of the additional information provided confirmed the current facility does not meet FAA guidelines. Garbage is not currently received behind closed doors and the current facility is open on one or more sides.

However, according to the additional documentation provided, the current facility would "modify its existing buildings to accommodate an enclosed Recovered Material Processing Facility (RMF)," and would: receive garbage behind closed doors, remove all residue by enclosed vehicles, control odors by ventilation and filtration systems, process material via compaction—per follow up correspondence with Carla Sands, and will not: be open on one or more sides, store uncovered quantities of municipal solid waste outside, or use semi-trailers that leak or have trash clinging to the outside. The changes the Bankhead C & D Transfer Station is proposing would meet the requirements set forth in the FAA Advisory Circular.

The Department issues this letter to revise our guidance letter to Cobb County dated April 18, 2012. Based on the additional information reviewed, Bankhead's proposal, as described above, would meet the requirements set forth in FAA's Advisory Circular.

Since the Bankhead C & D Transfer facility currently does not meet requirements set forth in the FAA Advisory Circular, we strongly encourage the County to establish a monitoring program and mitigation measures as necessary to minimize any attractants to wildlife, until such time as the proposed changes are constructed and are in operation. This recommendation is to assure compatibility with nearby airport operations.

Please do not hesitate to contact me or Carla Sands, Acting Aviation Programs Manager, at (404) 631-1323 if you have any questions.

Sincerely,

Carol L. Comer, Director  
Division of Intermodal Programs

cc: Hon. Tim Lee, Cobb County  
Karl Von Hagel, Cobb County Airport Manager  
Doug Barrett, Fulton County Airport Manager  
Scott Seritt, FAA  
Todd Long, P.E., Deputy Commissioner



OVERALL TOTAL SITE AREA	8.15 ACRES
ZONING DISTRICT	COBB COUNTY
EXISTING ZONING	GC (GENERAL COMMERCIAL) (1.81 ACRES)
PROPOSED ZONING	HI (INDUSTRIAL) (6.34 ACRES)

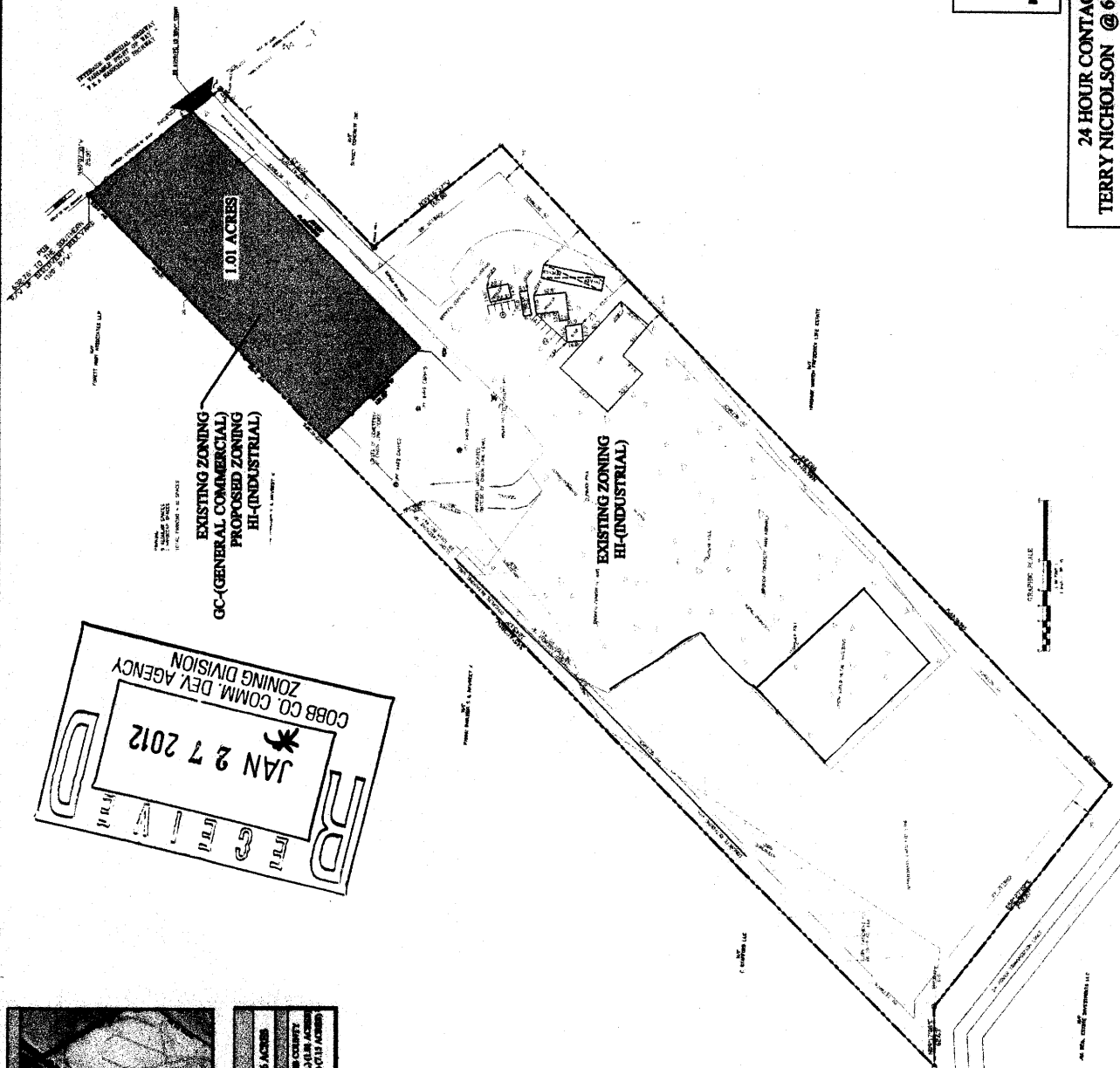
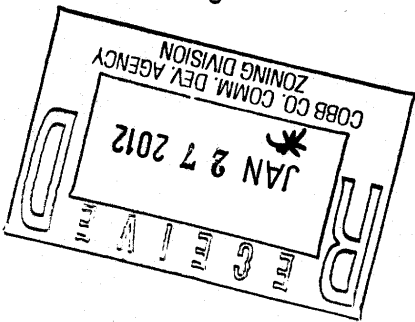

Other Business Item 8  
Exhibit A



24 HOUR CONTACT:  
TERRY NICHOLSON @ 678-296-1888

**BANKHEAD TRANSFER STATION**  
AN EXISTING INDUSTRIAL TRANSFER STATION  
BANKHEAD TRANSFER STATION, LLC  
1400 BANKHEAD INDUSTRIAL PARKWAY  
MARIETTA, GEORGIA 30067  
THE PLANNING AND ENGINEERING COLLABORATIVE

**REVISIONS:**

NO.	DATE	BY	DESCRIPTION
1	10/25/2011	WJC	INITIAL DESIGN
2	11/07/2011	WJC	REVISIONS

**REZONING SITE PLAN**  
SCALE: 1" = 50'  
DATE: SEPTEMBER 1, 2011  
PROJECT: 11107.00



1

\*For Garin's Sams Letter dated 1-26-12  
JPP

PAGE 7 OF 7

APPLICATION NO. Z-42

ORIGINAL DATE OF APPLICATION: 11-15-11

Other Business Item 8  
Exhibit B

APPLICANTS NAME: BANKHEAD C & D TRANSFER STATION, LLC

THE FOLLOWING REPRESENTS THE FINAL DECISIONS OF THE  
COBB COUNTY BOARD OF COMMISSIONERS

**BOC DECISION OF 05-15-12 ZONING HEARING:**

**BANKHEAD C & D TRANSFER STATION, LLC** (owner) requesting Rezoning from **GC** to **HI** for the purpose of a Transfer Station in Land Lot 282 of the 18<sup>th</sup> District. Located on the southwest side of Veterans Memorial Highway, east of Discovery Boulevard.

Following the public hearing held concurrently for Z-42'<sup>11</sup> and SLUP-10'<sup>11</sup> and after the vote on SLUP-10'<sup>11</sup>, the following motion was made:

MOTION: Motion by Thompson, second by Ott, to deny Rezoning request for Z-42'<sup>11</sup>.

VOTE: **ADOPTED** 4-0-1 (Birrell recused herself)

**NOTE:** The public hearings for Z-42 and SLUP-10 were held concurrently. Chairman Lee announced that Commissioner Birrell would recuse herself from voting on these petitions.

ORIGINAL DATE OF APPLICATION: 11-15-11APPLICANTS NAME: BANKHEAD C & D TRANSFER STATION, LLCTHE FOLLOWING REPRESENTS THE FINAL DECISIONS OF THE  
COBB COUNTY BOARD OF COMMISSIONERSOther Business Item 8  
Exhibit B**BOC DECISION OF 05 -15 -12 ZONING HEARING:**

**BANKHEAD C & D TRANSFER STATION, LLC** (owner) requesting a **Special Land Use Permit** for the purpose of Expanding Existing Transfer Station in Land Lots 282 and 286 of the 18<sup>th</sup> District. Located on the southwest side of Veterans Memorial Highway, east of Discovery Boulevard.

The public hearing was opened for Z-42<sup>'11</sup> and SLUP-10<sup>'11</sup> and Mr. Garvis L. Sams, Jr., Ms. Robin Meyer, Mr. Kevin Ross, and Mr. Daniel Hoover addressed the Board. Commissioner Thompson called Ms. Judy Skeel to the podium to offer her opinion as to whether a need exists for an additional municipal solid waste transfer station in this part of Cobb County. Following presentation and discussion, the following motion was made:

**MOTION:** Motion by Thompson, second by Ott, to **deny** Special Land Use Permit, ***with the following statement added to the record:***

*"In light of Ms. Skeel's testimony and in addition to the evidence that was presented during the public hearing, which I believe should be included in the official record as follows:*

*The Legacy by the River Line community is within 1000 feet of this facility and other homes along Veterans Memorial Highway and Oakdale Road are within 1/10 of a mile.*

*Bankhead C & D Transfer Station, LLC (BTS) has been illegally accepting municipal solid waste (MSW) without proper zoning and land use permits since 2010 and has been cited in January 2011 and April 2012 for ongoing violations.*

*Two major land use studies that were adopted by Cobb County within the last thirty (30) months pertaining to the River Line area of Mableton (namely the D.L. Hollowell-Veterans Memorial Livable Centers Initiative adopted in July 2010 and the River Line Master Plan adopted in November 2009). These studies contain numerous findings and recommendations, which appear to be inconsistent with the processing of MSW at the BTS facility. These studies include the following information:*

*SLUP-10 continued on next page*

ORIGINAL DATE OF APPLICATION: 11-15-11APPLICANTS NAME: BANKHEAD C & D TRANSFER STATION, LLCTHE FOLLOWING REPRESENTS THE FINAL DECISIONS OF THE  
COBB COUNTY BOARD OF COMMISSIONERSOther Business Item 8  
Exhibit B**BOC DECISION OF 05-15-12 ZONING HEARING (Continued):**

- *"Existing land use information indicates that the River Line study area is primarily residential in nature."*
- *"The desire to maintain industrial land in [River Line area] must be balanced with the need to create a high quality of life for people in what is essentially a residential area. Because the nature of industrial development in this area is of a poor quality and it sits on the banks of the environmentally sensitive Chattahoochee River, the appropriateness of retaining all of this land use should be evaluated."*
- *"If industrial use is maintained in the River Line area, it needs to be more compatible with the residential development."*
- *"Future development in the River Line area needs to be more consistent with the existing trend toward residential."*
- *"Shift land use away from industrial."*
- *"If industrial use is maintained, it [should be] a less noxious use that is more compatible with other uses and provides views of the river, access to the river, and connectivity along the river."*

VOTE: **ADOPTED 4-0-1** (Birrell recused herself)**NOTE:** The public hearings for Z-42 and SLUP-10 were held concurrently. Chairman Lee announced that Commissioner Birrell would recuse herself from voting on these petitions.



Z-42  
of  
2011

**PLANNERS AND ENGINEERS COLLABORATIVE**  
WE PROVIDE SOLUTIONS  
LANDSCAPE ARCHITECTURE • CIVIL ENGINEERING • LAND SURVEYING  
SUITE 100 • 1000 N. HUNTER STREET • ATLANTA, GEORGIA 30309 • PHONE: 404-525-1234 • FAX: 404-525-1235 • WWW.PECCALL.COM

**BANKHEAD TRANSFER STATION**  
AN EXISTING INDUSTRIAL TRANSFER STATION  
FOR  
1400 VETERANS MEMORIAL HIGHWAY  
MARIETTA, GEORGIA 30067  
PHONE: 678-296-1888

REVISIONS

NO. DATE

1 1-24-2012

2 1-24-2012

3 1-24-2012

4 1-24-2012

5 1-24-2012

6 1-24-2012

7 1-24-2012

8 1-24-2012

9 1-24-2012

10 1-24-2012

11 1-24-2012

12 1-24-2012

13 1-24-2012

14 1-24-2012

15 1-24-2012

16 1-24-2012

17 1-24-2012

18 1-24-2012

19 1-24-2012

20 1-24-2012

21 1-24-2012

22 1-24-2012

23 1-24-2012

24 1-24-2012

25 1-24-2012

26 1-24-2012

27 1-24-2012

28 1-24-2012

29 1-24-2012

30 1-24-2012

31 1-24-2012

32 1-24-2012

33 1-24-2012

34 1-24-2012

35 1-24-2012

36 1-24-2012

37 1-24-2012

38 1-24-2012

SHEET TITLE  
**SLUP PLAN**

SCALE: 1" = 50'

DATE: SEPTEMBER 1, 2011

PROJECT: 11107.00

THIS SEAL IS ONLY VALID IF COUNTER SIGNED  
AND DATED WITH AN ORIGINAL SIGNATURE

PROFESSIONAL SEAL  
TERRY NICHOLSON  
REGISTERED PROFESSIONAL ENGINEER  
STATE OF GEORGIA  
NO. 11107  
EXPIRATION DATE: 12/31/2012

11107.00

11107.00

11107.00

11107.00

11107.00

11107.00

11107.00

11107.00

11107.00

11107.00

11107.00

11107.00

11107.00

11107.00

11107.00

11107.00



24 HOUR CONTACT:  
**TERRY NICHOLSON @ 678-296-1888**

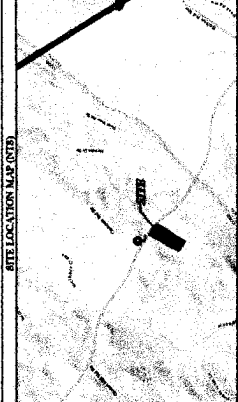
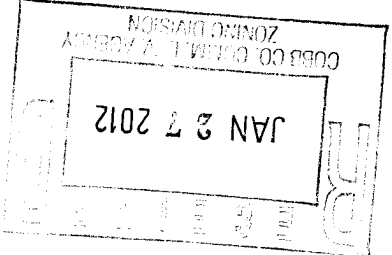
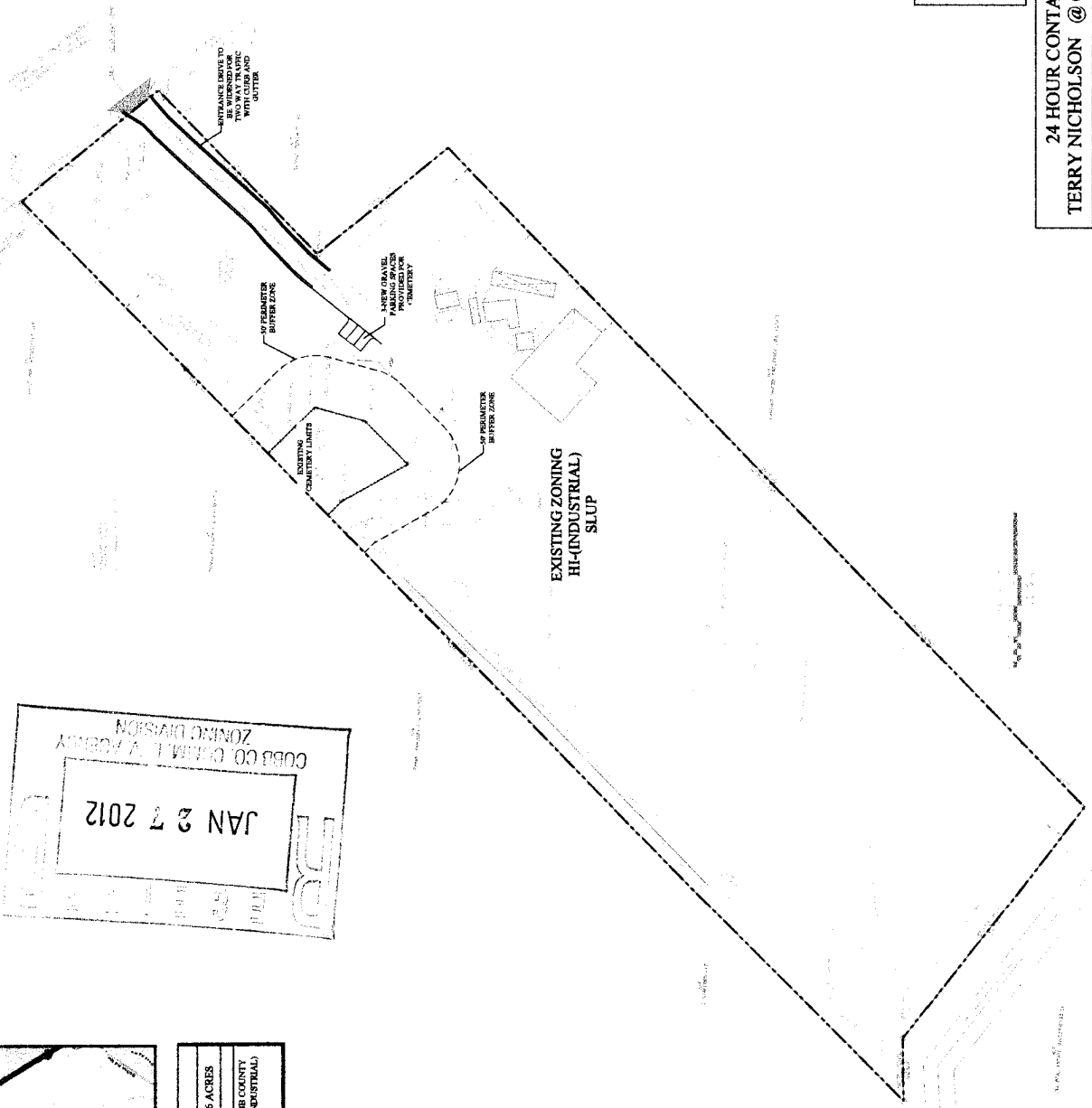

<b>SITE DATA:</b>	
OVERALL TOTAL SITE AREA	8.16 ACRES
ZONING	COBB COUNTY
ZONING JURISDICTION	SLUP, HI (INDUSTRIAL)
EXISTING ZONING	

**APPLICANT:** Bankhead C & D Transfer Station, LLC

(678) 296-1888

**REPRESENTATIVE:** Garvis L. Sams, Jr. (770) 422-7016

Sams, Larkin & Huff, LLP

**TITLEHOLDER:** Bankhead C & D Transfer Station, LLC

**PROPERTY LOCATION:** On the southwest side of Veterans

Memorial Highway, east of Discovery Boulevard.

**ACCESS TO PROPERTY:** Veterans Memorial Highway

**PHYSICAL CHARACTERISTICS TO SITE:** Drive for existing

transfer station

#### CONTIGUOUS ZONING/DEVELOPMENT

**NORTH:** CRC Developed Retail Center and HI/Undeveloped

**SOUTH:** HI/Developed Industrial Uses

**EAST:** HI/Developed Industrial Uses

**WEST:** CRC Developed Retail Center and HI/Undeveloped and Developed Industrial Uses

#### PETITION

**HEARING DATE (PC):** 11-01-2011

**HEARING DATE (BOC):** 11-15-2011

**PRESENT ZONING:** GC

**PROPOSED ZONING:** HI

**PROPOSED USE:** Transfer Station

**SIZE OF TRACT:** 1.81 acre

**DISTRICT:** 18

**LAND LOT(S):** 282

**PARCEL(S):** 8 (GC portion)

**TAXES: PAID** DELINQUENT **X\***

**COMMISSION DISTRICT:** 4

**\*As of April 18, 2012**

**OPPOSITION:** NO. OPPOSED **PETITION NO:** SPOKESMAN

#### PLANNING COMMISSION RECOMMENDATION

**APPROVED** MOTION BY

**REJECTED** SECONDED

**HELD** CARRIED

#### BOARD OF COMMISSIONERS DECISION

**APPROVED** MOTION BY

**REJECTED** SECONDED

**HELD** CARRIED

#### STIPULATIONS:

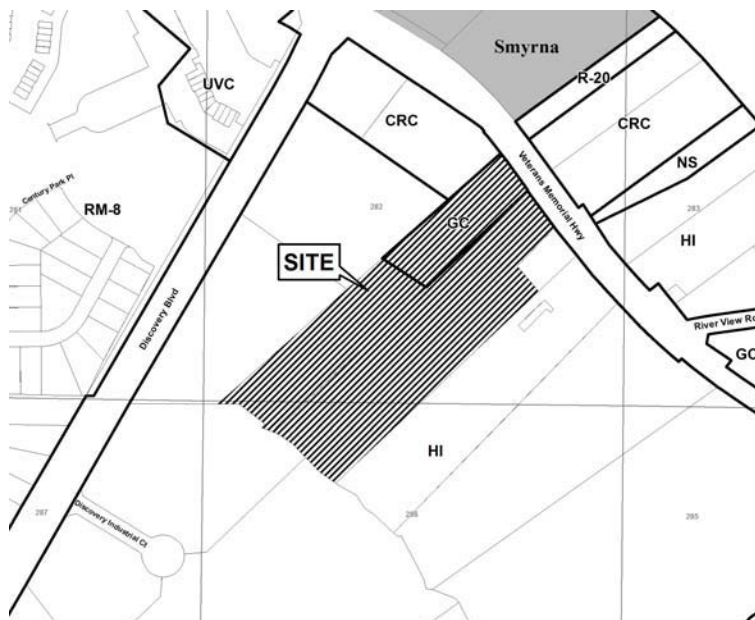

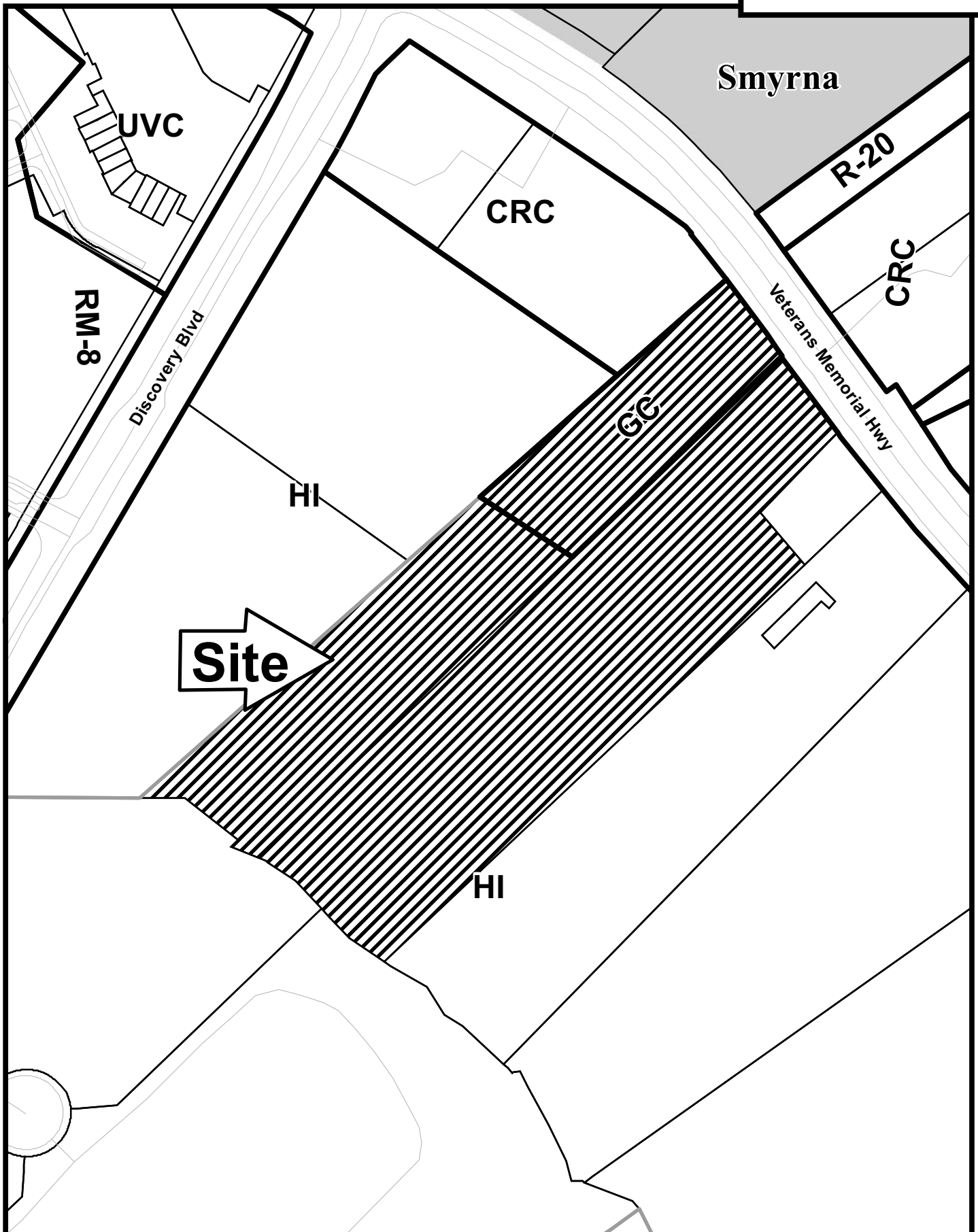

This map is provided for display and planning purposes only. It is not meant to be a legal description.

100 0 100  
Feet



City Boundary  
Zoning Boundary

**APPLICANT:** Bankhead C & D Transfer Station, LLC

**PETITION NO.:** Z-42

**PRESENT ZONING:** GC

**PETITION FOR:** HI

\*\*\*\*\*

**ZONING COMMENTS:**

**Staff Member Responsible:** Jason A. Campbell

Other Business Item 8  
Exhibit C

**Land Use Plan Recommendation:** Industrial

**Proposed Number of Buildings:** 3

The applicant is requesting rezoning to the Heavy Industrial category and a Special Land Use Permit to develop and operate a waste transfer station. The area for the rezoning actually contains the driveway to the larger overall property that has the buildings and equipment for the business. The GC zoning category is nonconforming and needs to be rezoned to the same HI as the overall property in order to add the additional use of municipal solid waste. The proposal is to add municipal solid waste to the existing construction and demolition transfer station. It is anticipated that the project will transfer 150,000 tons of waste annually. It is also anticipated that improvements to the subject property will be made (on the existing impervious footprint) which will include a Recovered Material Processing Facility ("RMF"). All processing operations of the RMF will be carried on inside the building, including the delivery of materials and the removal of same for transport. The applicant would employ technology to abate and control unpleasant odors, and to eliminate contaminated runoff. The proposed hours of operation for the waste transfer station and recycling facility will be Monday through Friday from 5:00 am to 6:00 pm, and on Saturday from 8:00 am to 1:00 p.m. The applicant previously had a Special Land Use Permit (SLUP-9) in 2004, but the subject property was not included in that request. The applicant has submitted a Statement of Intent and stipulation letter, which are attached for your review. The Georgia Regional Transportation Authority and the Atlanta Regional Commission have approved the applicant's request. The Georgia Department of Transportation (GDOT) represents the Federal Aviation Administration (FAA) in local matters, and they have sent a letter dated April 18, 2012 (see attached) regarding this application. The letter from GDOT recommends this request not be approved due to the negative effect the proposal may have on air navigation safety and liability for Fulton County Airport.

**Historic Preservation:** After consulting various county historic resources surveys, historic maps, archaeology surveys and Civil War trench location maps, staff finds that no known significant historic resources appear to be affected by this application. No further comment. No action by applicant requested at this time.

**Cemetery Preservation:** The Cobb Cemetery Preservation Commission is satisfied with the current stipulations that were placed on the cemetery land by Bessemer Properties in May 1996. We wish to continue the stipulations and ensure that there will be no parking in the cemetery buffer; also that access to the cemetery is not inhibited by persons parking in or along the cemetery access.

\*\*\*\*\*

**FIRE COMMENTS:**

**C/O:** Plans must be submitted to the Cobb County Fire Marshal's Office to initiate the Certificate of Occupancy process.

APPLICANT Bankhead C & D Transfer Station,LLC

PETITION NO. Z-042

PRESENT ZONING GC

PETITION FOR HI

\*\*\*\*\*

**WATER COMMENTS:**

NOTE: Comments reflect only what facilities were in existence at the time of this review.

Available at Development: ☒ Yes ☐ No

Fire Flow Test Required: ☒ Yes ☐ No

Other Business Item 8  
Exhibit C

Size / Location of Existing Water Main(s): 8" DI / S side Veterans Memorial Hwy

Additional Comments: Records show property as connected and active

Developer may be required to install/upgrade water mains, based on fire flow test results or Fire Department Code. This will be resolved in the Plan Review Process.

\*\*\*\*\*

**SEWER COMMENTS:**

NOTE: Comments reflect only what facilities were in existence at the time of this review.

In Drainage Basin: ☒ Yes ☐ No

At Development: ☐ Yes ☒ No

Approximate Distance to Nearest Sewer: Approximately 20' from NW property line

Estimated Waste Generation (in G.P.D.): **A D F=** TBD\* **Peak=** TBD\*

Treatment Plant: **South Cobb**

Plant Capacity: ☒ Available ☐ Not Available

Line Capacity: ☒ Available ☐ Not Available

Projected Plant Availability: ☒ 0 - 5 years ☐ 5 - 10 years ☐ over 10 years

Drw Sewers Required: ☐ Yes ☒ No

Off-site Easements Required: ☒ Yes\* ☐ No \*If off-site easements are required, Developer must submit easements to CCWS for review/approval as to form and stipulations prior to the execution of easements by the property owners. All easement acquisitions are the responsibility of the Developer

Flow Test Required: ☐ Yes ☒ No

Letter of Allocation issued: ☐ Yes ☒ No

Septic Tank Recommended by this Department: ☐ Yes ☒ No

Subject to Health Department Approval: ☐ Yes ☒ No

Additional CCWS Industrial Discharge Permit most likely required for tipping floor washdown  
Comments:

Developer will be responsible for connecting to the existing County water and sewer systems, installing and/or upgrading all outfalls and water mains, obtaining on and/or offsite easements, dedication of on and/or offsite water and sewer to Cobb County, as may be required. Rezoning does not guarantee water/sewer availability/capacity unless so stated in writing by the Cobb County Water System. Permit issuances subject to continued treatment plant compliance with EPD discharge requirements.

APPLICANT: Bankhead C & D Transfer Station, LLC

PETITION NO.: Z-42

PRESENT ZONING: GC

PETITION FOR: HI

\*\*\*\*\*

Other Business Item 8  
Exhibit C

**DRAINAGE COMMENTS**

FLOOD HAZARD: ☐ YES ☒ NO ☐ POSSIBLY, NOT VERIFIED

DRAINAGE BASIN: Chattahoochee River FLOOD HAZARD INFO: Zone X

- ☐ FEMA Designated 100 year Floodplain Flood.
- ☐ Flood Damage Prevention Ordinance DESIGNATED FLOOD HAZARD.
- ☒ Project subject to the Cobb County Flood Damage Prevention Ordinance Requirements.
- ☐ Dam Breach zone from (upstream) (onsite) lake – need to keep residential buildings out of hazard.

WETLANDS: ☐ YES ☒ NO ☐ POSSIBLY, NOT VERIFIED

Location: \_\_\_\_\_

- ☐ The Owner/Developer is responsible for obtaining any required wetland permits from the U.S. Army Corps of Engineer.

STREAMBANK BUFFER ZONE: ☒ YES ☐ NO ☐ POSSIBLY, NOT VERIFIED

- ☒ Metropolitan River Protection Area (within 2000' of Chattahoochee River) ARC (review 35' undisturbed buffer each side of waterway).
- ☐ Chattahoochee River Corridor Tributary Area – County review (\_\_\_\_\_ undisturbed buffer each side).
- ☒ Georgia Erosion-Sediment Control Law and County Ordinance – **County Review**/State Review.
- ☐ Georgia DNR Variance may be required to work in 25 foot streambank buffers.
- ☒ County Buffer Ordinance: **50'**, 75', 100' or 200' each side of creek channel.

**DOWNSTREAM CONDITION**

- ☐ Potential or Known drainage problems exist for developments downstream from this site.
- ☐ Stormwater discharges must be controlled not to exceed the capacity available in the downstream storm drainage system.
- ☒ Minimize runoff into public roads.
- ☒ Minimize the effect of concentrated stormwater discharges onto adjacent properties.
- ☐ Developer must secure any R.O.W required to receive concentrated discharges where none exist naturally
- ☐ Existing Lake Downstream \_\_\_\_\_.  
Additional BMP's for erosion sediment controls will be required.
- ☐ Lake Study needed to document sediment levels.
- ☐ Stormwater discharges through an established residential neighborhood downstream.
- ☒ Project engineer must evaluate the impact of increased volume of runoff generated by the proposed project on downstream receiving stream.

APPLICANT: Bankhead C & D Transfer Station, LLC

PETITION NO.: Z-42

PRESENT ZONING: GC

PETITION FOR: HI

\*\*\*\*\*

Other Business Item 8  
Exhibit C

DRAINAGE COMMENTS CONTINUED

SPECIAL SITE CONDITIONS

- ☐ Provide comprehensive hydrology/stormwater controls to include development of out parcels.
- ☒ Submit all proposed site improvements to Plan Review.
- ☐ Any **spring activity** uncovered must be addressed by a qualified geotechnical engineer (PE).
- ☐ Structural fill \_\_\_\_\_ must be placed under the direction of a qualified registered Georgia geotechnical engineer (PE).
- ☒ Existing facility.
- ☒ Project must comply with the Water Quality requirements of the CWA-NPDES-NPS Permit and County Water Quality Ordinance.
- ☐ Water Quality/Quantity contributions of the existing lake/pond on site must be continued as baseline conditions into proposed project.
- ☐ Calculate and provide % impervious of project site.
- ☐ Revisit design; reduce pavement area to reduce runoff and pollution.

INSUFFICIENT INFORMATION

- ☒ No Stormwater controls shown.
- ☐ Copy of survey is not current – Additional comments may be forthcoming when current site conditions are exposed.
- ☒ No site improvements showing on exhibit.

ADDITIONAL COMMENTS

1. A Notice of Intent must be filed with the Georgia Environmental Protection Division for coverage under the NPDES General Permit to discharge stormwater associated with industrial activities. This facility will likely be classified under the Standard Industrial Classification (SIC) Code 4953 as a solid waste transfer operation. Any requirements associated with this permit must be addressed including the development of a written stormwater pollution prevention plan (SWPPP) for the site.
2. In addition to other best management practices (BMPs) that may be required for this site during Plan Review, the detention pond outlet control structure design should include a “snout type” device for any low flow orifices.
3. This site is located within the Chattahoochee River Corridor and is therefore subject to provisions of the Metropolitan River Protection Act.

**APPLICANT:** Bankhead C & D Transfer Station, LLC

**PETITION NO.:** Z-42

**PRESENT ZONING:** GC

**PETITION FOR:** HI

\*\*\*\*\*

**TRANSPORTATION COMMENTS**

Other Business Item 8  
Exhibit C

The following comments and recommendations are based on field investigation and office review of the subject rezoning case:

ROADWAY	AVERAGE DAILY TRIPS	ROADWAY CLASSIFICATION	SPEED LIMIT	JURISDICTIONAL CONTROL	MIN. R.O.W. REQUIREMENTS
Veterans Memorial Highway	21000	Arterial	45 mph	Georgia DOT	100'

*Based on 2010 traffic counting data taken by Georgia DOT (Veterans Memorial Highway)*

**COMMENTS AND OBSERVATIONS**

Veterans Memorial Highway is classified as an arterial and according to the available information the existing right-of-way does meet the minimum requirements for this classification.

**RECOMMENDATIONS**

Recommend installing sidewalk along the road frontage.

Recommend removing existing unused driveway apron.

Recommend a deceleration lane at the main access driveway.

GDOT permits will be required for all work encroaching upon state right-of-way.

Recommend applicant be required to meet all Cobb County Development Standards and Ordinances related to project improvements.



## STAFF RECOMMENDATIONS

### **Z-42 BANKHEAD C & D TRANSFER STATION, LLC**

- A. It is Staff's opinion that the applicant's rezoning proposal will permit a use that is suitable in view of the use and development of adjacent and nearby properties. Other properties in the area are zoned HI and developed with industrial uses.
- B. It is Staff's opinion that the applicant's rezoning proposal may have an adverse affect on the usability of adjacent or nearby property. The property has had a transfer station and is adding another component (municipal solid waste). The Georgia Regional Transportation Authority has issued findings that support the applicant's request and the Atlanta Regional Commission has approved the applicant's request. However, the Georgia Department of Transportation issued a letter April 18, 2012 that recommends this request not be approved due to the negative effect the proposal may have on air navigation safety and liability for Fulton County Airport.
- C. It is Staff's opinion that the applicant's rezoning proposal will not result in a use which would cause an excessive or burdensome use of existing streets, transportation facilities, utilities, or schools. This opinion can be supported by the departmental comments contained in this analysis.
- D. It is Staff's opinion that the applicant's rezoning proposal is in conformity with the policy and intent of the *Cobb County Comprehensive Plan*, which delineates this property as being in the Industrial land use category. The proposed use is allowed as a special exception with a Special Land Use Permit (SLUP) in the Heavy Industrial land use category (SLUP-10 for this use is being considered concurrently with this reasoning application). However, the Georgia Department of Transportation issued a letter April 18, 2012 that recommends this request not be approved due to the negative effect the proposal may have on air navigation safety and liability for Fulton County Airport.
- E. It is Staff's opinion that there are existing and changing conditions affecting the use and development of the property which give supporting grounds for denying the applicant's rezoning proposal. The property is currently used as a construction and demolition transfer station and is adding the municipal solid waste component to its business. However, the Georgia Department of Transportation issued a letter April 18, 2012 that recommends this request not be approved due to the negative effect the proposal may have on air navigation safety and liability for Fulton County Airport.

Based on the above analysis, Staff recommends DENIAL.

**The recommendations made by the Planning and Zoning Staff are only the opinions of the Planning and Zoning Staff and are by no means the final decision. The Cobb County Board of Commissioners makes the final decisions on all Rezoning and Land Use Permits at an advertised public hearing.**

**ZONING IMPACT STATEMENT FOR THE REZONING  
APPLICATION OF BANKHEAD C & D TRANSFER STATION, LLC**

COMES NOW, BANKHEAD C & D TRANSFER STATION, LLC,  
and, pursuant to §134-121(a)(7) of the Cobb County Zoning Ordinance, files this  
Zoning Impact Statement, as follows:

SEP - 1 2011

- A. The zoning proposal will permit a use of the property which is suitable in the context of development and existing zonings along this section of the Veterans Memorial Highway Corridor.
- B. The zoning proposal will have no adverse effect or impact upon the existing uses or usability of adjacent or nearby properties, most of which are industrial and commercial developments located within the confines of an industrial area under Cobb County's Future Land Use Map.
- C. The subject property to be affected by the zoning proposal has no reasonable economic use as currently zoned in that the fair market value of same falls below the range of values of similarly zoned and situated properties with equivalent utility. Additionally, the present owner of the subject property is suffering a significant economic detriment by virtue of the continuation of the present nonconforming classification of GC.

SEP - 1 2011

- D. The zoning proposal will have no adverse impact upon the existing County infrastructure including, but not limited to, existing streets, transportation facilities, utilities or schools.
- E. The zoning proposal is located within an industrial area and is consistent with those uses and purposes contemplated under Cobb County's Comprehensive Land Use Plan and Future Land Use Map.
- F. There is no substantial relationship between the existing zoning classification of GC which limits the property in terms of its present utilization and the public health, safety and general welfare. Additionally, considered in the context of development along this section of the Veterans Memorial Highway Corridor, there are no established land use planing principles or political considerations which would vitiate the zoning proposal.

Respectfully submitted, this the 1<sup>st</sup> day of September, 2011.

SAMS, LARKIN & HUFF, LLP

By: 

GARVIS L. SAMS, JR.  
Attorney for Applicant  
Ga. Bar No. 623950

Other Business Item 8  
Exhibit C

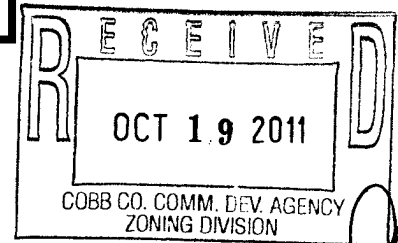

**STATEMENT OF INTENT**

**OF**

**BANKHEAD C & D TRANSFER STATION, LLC**

**Special Land Use Permit Application (SLUP – 10)  
For an 8.16 Acre Tract of Land located in  
Land Lot 282 & 286, 18<sup>th</sup> District, 2<sup>nd</sup> Section,  
Cobb County, Georgia**

**Submitted for the Applicant by:**

**Garvis L. Sams, Jr.  
Sams, Larkin & Huff, LLP  
Suite 100  
376 Powder Springs Street  
Marietta, GA 30064  
(770) 422-7016  
[gsams@samslarkinhuff.com](mailto:gsams@samslarkinhuff.com)**

## I. INTRODUCTION

This Application seeks a Special Land Use Permit ("SLUP") to allow for the expansion of an existing Construction and Demolition (C & D) transfer station to include Municipal Solid Waste ("MSW"). The proposed expansion to include MSW is located on a 8.16 acre tract of land located on Veterans Memorial Highway in Land Lots 282 & 286 of the 18<sup>th</sup> District, 2<sup>nd</sup> Section, Cobb County, Georgia ("subject property"). The subject property is zoned Heavy Industrial ("HI") and is delineated as "Industrial" on Cobb County's Future Land Use Map ("FLUM"). Both the zoning district of HI and the FLUM designation allow for the uses which presently exist and those proposed with the SLUP pursuant to § 134-37 and § 134-231 of the Cobb County Zoning Ordinance.

A preponderance of the subject property is developed with the existing C & D Transfer Station and is "grandfathered" under the Metropolitan Protection Act ("MRPA") requirements as it lies within the Chattahoochee River MRPA Corridor. The subject property is surrounded on the south, east and west by a variety of Heavy Industrial uses, including heavy contractors, a trucking transport company, a crane company, and industrial manufacturers to name but a few. It is also located in close proximity to major, regional transportation corridors such as Interstate 285, South Cobb Drive and Veterans Memorial Highway from which the present C & D Transfer Station operates.

The Applicant plans to modify its existing buildings to accommodate an enclosed Recovered Material Processing Facility ("RMF"). On the subject property the trash collection trucks will discharge their loads in order for the trash can be relocated onto larger vehicles (see Cobb County Code of Ordinances Code § 102-5, where a "Transfer Station" is defined as a "facility used to transfer solid waste from one transportation vehicle to another for transportation to a disposal facility or processing operation."). The combination of a C & D and MSW Transfer

Station provides for a number of benefits. It will reduce the truck traffic on the County's highways by serving as a waste delivery consolidation point. Generally speaking, for every five (5) vehicles which enter the facility, only one is needed to haul waste on the final leg of the disposal journey. It has beneficial effects upon emissions, energy use and road wear and tear. It will also lower collection costs, as crews spend less time traveling to and from distant disposal sites and more time collecting waste, reducing the costs for labor, fuel and collection and vehicle maintenance. There are presently only five (5) private transfer stations now operating in Cobb County. The Applicant anticipates that the Waste Transfer Station with the added MSW component will receive approximately 150,000 tons of solid waste per year (12,500 tons per month) in roughly nine (9) truck loads leaving the facility per day.

The Applicant proposes the following hours of operation for the combined C & D and MSW Facility.

The Applicant proposes that the hours of operation for the facility shall be as follows:

Monday through Friday: 5:00 a.m. until 6:00 p.m.

Saturday: 8:00 a.m. until 1:00 p.m.

Sunday: Closed

Further, the facility will comply with all applicable federal, state and local requirements, including the County's Solid Waste Ordinance which "regulates the storage, collection, transportation and disposal of solid waste within the unincorporated areas of Cobb County". Cobb County Code of Ordinances, § 102-1, et seq.

All processing operations of the RMF shall be carried on inside of the building, including the delivery of materials and the removal of same for transport with the facility constituting a "clean RMF", meaning that it shall not separate recyclable materials from general garbage and waste and shall accept source separated recyclable materials. Additionally, the doors to the

facility used to allow vehicles to deliver materials shall be closed except when active deliveries are occurring. The RMF will also contain a dust and odor suppression system, including overhead misters which will apply water and deodorizer periodically to control dust and odor within the building, air disbursement exhaust fans and will provide for manual application of water provided from wash down stations within the building.

In addition to the foregoing, the Applicant will agree to make any necessary repairs to the odor control systems within forty-eight (48) hours or notify the County if repairs cannot be made within that time frame. In that event, it will be incumbent upon the Applicant to obtain a temporary replacement system or secure approval from the Community Development Director for an extension of time in which to repair. The RMF will also contain a tipping floor where recyclable materials will be dumped and it will be washed down at least two (2) times per week with all liquid waste and wastewater from inside the building being routed to the sanitary sewer with the plan to be approved by the County during the Plan Review Process. There will be no outdoor storage of trash or trucks which have trash in them and the Applicant will be responsible for the installation of an oil/water separator to treat stormwater as required by the County. Operationally, the RMF will designate an on-site project manager during construction and an on-site operational manager/supervisor during the operation of the facility.

Recently, the Board of Commissioners ("BOC") voted to approve a settlement of litigation to approve SLUP-6 (1999 S&S Investment Company) to allow for a Recycling Recovery Facility and Transfer Stations. The staff report recommending "approval" and upon which the BOC's ultimate decision after litigation was commenced was presumably based could have easily been describing the subject property when it stated in pertinent part, as follows:

"The Applicant's property has been zoned Heavy Industrial without any rezoning conditions or stipulations since the Zoning Code and Zoning Map were adopted in 1972. The Applicant's property is located in an area predominately zoned and used for Heavy Industrial uses. The Applicant's property has been designated as Industrial by the Cobb County Comprehensive Land Use Plan since it was adopted. The Heavy Industrial zoning category and the Industrial Future Land Use category provides [sic] for the most intensive land uses in Cobb County. There are uses that may contain large scale outdoor storage, uses that may be noisy, uses that may cause vibrations, uses that may operate constantly, uses that may generate heavy truck traffic, uses that may emit odors and/or emissions and uses that may require federal and/or state permits. Industrial uses on adjacent and nearby properties include warehouses, trucking companies, heavy contractors, manufacturing and distributors. The Applicant's proposal is located within close proximity to major regional transportation corridors such as Veterans Memorial Highway, South Cobb Drive and Interstate 285. The Applicant's property is located within the boundaries of the *Industrial Land Inventory and Protection Policy* which is a study that the Cobb County Planning Division generated to protect industrial property in the County. There are other Waste Transfer Stations in the County that are situated much closer to residential properties than this proposal. Those Waste Transfer Stations have employed various measures to substantially reduce negative impacts on nearby properties; these measures have included odor and noise abatement systems and heavy landscaping. Based on the above analysis, **STAFF RECOMMENDS APPROVAL** subject to the following:

- Site plan received by the Zoning Division.
- Applicant incorporate odor control measures such as odor neutralizing spray systems at each door, overhead odor neutralizing misters throughout the building and high velocity air dispersion exhaust fans; all transfers . . . take place inside the buildings, with a tipping floor to be cleaned at least once daily;
- All liquid waste from inside the building be routed to sanitary sewer, with plan to be approved by Water System engineers at Plan Review;
- An Arborist approved landscape plan at Plan Review that would ensure a visual and noise abatement screen with [sic] five-years of land disturbance.
- Fire Department Comments;
- Water and Sewer Comments and Recommendations;
- Development of regional impact from ARC and GRTA;
- Applicant meet all state permitting requirements;
- Stormwater Management Comments and Recommendations;
- and,
- DOT Comments and Recommendations."



For the same reasons and the reasons stated herein, the BOC should approve this requested SLUP-10 as well.

In addition to the existing C & D component and the proposed MSW component, the Applicant's proposal includes plans for a Recycling Center as a part of the proposed facility consistent with Cobb County's stated desire to encourage the recycling of materials:

"The goal of the citizens of Cobb County is to cooperate by reducing their waste and by 'Reusing, Recycling and Composting', both at home and at work. Everyone must be involved in reducing waste generation and disposal." Draft of Cobb County Comprehensive Solid Waste Management Plan (2009-2019), P.ES-2.

The County's goal is designed to promote sustainability and to divert renewable waste away from landfills. In fact, a 2006 study revealed "that nearly 2.6 million tons – or approximately forty percent (40%) of the municipal solid waste Georgians throw away per year are recyclable material with existing end markets within the state."

To address that issue, the Applicant proposes the recycling component within the RMF within which paper, aluminum/steel cans, plastic and glass (materials which would otherwise become solid waste) are collected, separated and ultimately reused or returned to use in the form of new materials or products. Data indicates that the type of recyclable materials which the Applicant intends to focus upon collectively make up approximately Fifty-One Percent (51%) of Cobb County's waste composition. Draft Comprehensive Solid Waste Management Plan at P.2-4.

## **II. CRITERIA TO BE APPLIED TO SPECIAL LAND USE PERMITS**

**A. Whether or not there will be a significant adverse effect on the neighborhood or area in which the proposed use will be located.**

The subject property is bordered on its east, south and west sides by HI zoned and utilized properties and on the north by Veterans Memorial Highway, a major arterial right of way. It is surrounded by all manner of Heavy Industrial uses, including trucking transport facilities, heavy contractors, industrial manufacturers, a crane company and all manner of industrial users to name just a few. The "neighborhood" or area in which the proposed expansion to the existing use will be located was specifically designed to contain large scale outdoor storage uses that may be noisy, uses that may cause vibration, uses that may operate constantly, uses that may generate heavy truck traffic, uses that may emit odors and/or emissions and uses that may require federal and/or state permits. Therefore, the proposed expansion to the existing use is consistent with uses on adjacent and nearby properties and will have no adverse effect upon them.

**B. Whether or not the use is otherwise compatible with the neighborhood.**

The neighborhood within which the subject property is located is zoned HI and has a designation of Industrial on the County's FLUM. As referred to previously, both the zoning district and the land use category are specifically designed to contain large-scale outdoor storage uses that may be noisy, uses that may cause vibrations, uses that may operate constantly, uses that may generate heavy truck traffic, uses that may omit odors and/or emissions and uses that may require federal and/or state permits. Given these facts and the reality that the area already consists of Heavy Industrial uses like warehouses, heavy contractors, trucking companies, a crane company and a veritable plethora of Industrial users, the proposed use is compatible with the neighborhood.

**C. Whether or not the use proposed will result in a nuisance as defined under state law.**

The proposed use will not result in a nuisance, either public or private, as that term is defined by Georgia law. The expansion of the proposed C & D with an MSW component will be enclosed. Moreover, the Heavy Industrial area in which the subject property is located specifically allows and is compatible with uses which create noise, smoke, dust, odor or vibrations. Finally, the proposed expansion to the existing use is located in close proximity to Interstate 285, South Cobb Drive and Veterans Memorial Highway, limiting heavy truck traffic on minor roadways.

**D. Whether or not quiet enjoyment of surrounding property will be adversely affected.**

The surrounding properties consist exclusively of Heavy Industrial uses and are used in a manner similar to that which the Applicant proposes. Further, the proposed use is located in close proximity to Interstate 285, South Cobb Drive and Veterans Memorial Highway, limiting heavy truck traffic on minor roadways.

**E. Whether or not property values of surrounding property will be adversely affected.**

The surrounding properties consist exclusively of Heavy Industrial uses and are used in a manner similar to that which the Applicant proposes. Therefore, the values of surrounding properties will not be adversely affected.

**F. Whether or not adequate provisions are made for parking and traffic considerations.**

The proposal will meet the County's parking requirements. The Heavy Industrial area in which the subject property is located was specifically designed for uses which may generate heavy truck traffic, given its proximity to Interstate 285, South Cobb Drive and Veterans Memorial Highway. The Applicant also notes that the proposal will be

reviewed as a Development of Regional Impact ("DRI") by both the Atlanta Regional Commission ("ARC") and the Georgia Regional Transportation Authority ("GRTA"). Traffic impacts will be considered during this process and additional improvements is presently being added.

**G. Whether or not the site or intensity of the use is appropriate.**

The subject property consists of over eight (8) acres of land. The Applicant proposes utilizing the existing footprint to modify the existing building to a Recovered Material Processing Facility ("RMF"). Total impervious coverage is only sixty-six percent (66%) of the site. The size of the property is more than adequate to accommodate the proposed expansion to the existing use.

**H. Whether or not special or unique conditions overcome the Board of Commissioners' general presumption that residential neighborhoods should not allow non-compatible business uses.**

The area at issue is not residential and the proposed use is entirely compatible with existing contiguous Heavy Industrial uses.

**I. Whether or not adequate provisions are made regarding hours of operation.**

The hours of operation will mirror those of existing Heavy Industrial uses on adjacent and nearby properties as mentioned above.

**J. Whether or not adequate controls and limits are placed on commercial and business deliveries.**

Deliveries to the subject property will be commensurate in number and type to existing deliveries on adjacent and nearby Heavy Industrial properties.

**K. Whether or not adequate landscape plans are incorporated to ensure appropriate transition.**

Not applicable in view of the fact that the subject property is surrounded by HI properties.

**L. Whether or not the public health, safety, welfare or moral concerns of the surrounding neighborhood will be adversely affected.**

The surrounding "neighborhood" consists of Heavy Industrial uses, all of which are comparable to the use proposed.

**M. Whether the Application complies with any applicable specific requirement set forth in this chapter for a Special Land Use Permit for particular types of uses.**

The application meets all of the requirements for a Special Land Use Permit pursuant to § 134-37 and all required information has been supplied.

**N. Whether the Applicant has provided sufficient information to allow a full consideration of all relevant factors.**

The Applicant has addressed all issues raised by law. The Applicant also remains available to respond to any questions or issues raised by the County's professional staff or by Members of the Planning Commission or Board of Commissioners.

**III. PRESERVATION OF CONSTITUTIONAL RIGHTS**

The Zoning Ordinance of Cobb County, Georgia lacks adequate standards for the Board of County Commissioners to exercise its power to issue Special Land Use Permits. In essence, the standards are not sufficient to contain the discretion of the Board of Commissioners and to provide the Courts with a reasonable basis for judicial review. Because the stated standards (individually and collectively) are too vague and uncertain to provide reasonable guidance to the Board of Commissioners, the Zoning Ordinance violates the Fifth and Fourteenth Amendments

of the Constitution of the United States in matters of zoning. The Zoning Resolution also violates Article I, Section III, Paragraph 1; and Article 1, Paragraphs 1 and 2 of the Constitution of the State of Georgia, 1983.

The Board of Commissioners is granted the power to zone pursuant to Article IX, Section II, Paragraph 4 of the Constitution of the State of Georgia, 1983. It is a power which must be fairly exercised. Based on this element of fairness, the Zoning Ordinance of Cobb County, Georgia violates Article IX, Section II, Paragraph 4 of the Constitution of the State of Georgia, 1983.

The Zoning Ordinances presently in effect is contrary to the best interests of the health and welfare of the citizens of Cobb County, Georgia, and constitutes an arbitrary and capricious act. As a result, the Zoning Ordinance is in violation of Article I, Section III, Paragraph 1 of the Constitution of the State of Georgia; and Article I, Section II, Paragraph 3 of the Constitution of the State of Georgia, 1983. Furthermore, the Zoning Ordinance violates the due process clause and equal protection clauses of the Fifth and Fourteenth Amendments to the Constitution of the United States of America.

In addition, the Zoning Ordinance is unconstitutional in that it renders the subject property unusable and destroys its marketability. Therefore, the Zoning Ordinance constitutes a taking of the Applicant's property without just and adequate compensation and without due process of law in violation of the Fifth and Fourteenth Amendments to the United States Constitution and in violation of Article I, Section I, Paragraph 1 and Article I, Section III, Paragraph 1(a) of the Constitution of Georgia.

The failure to approve the requested Special Land Use Permit for the subject property would constitute the taking of property without due process and without the payment of adequate compensation in violation of Article I, Section I, Paragraph 1 of the Constitution of the State of

Georgia, 1983; and the Fifth and Fourteenth Amendments of the Constitution of the United States.

Failure to grant the Application for the Special Land Use Permit would be contrary to the best interests of the health and welfare of the citizens of Cobb County, Georgia, and would further constitute an arbitrary and capricious act. As such, failure to grant the application would constitute a violation of Article I, Section I, Paragraph 1 of the Constitution of the State of Georgia, 1983; and Article I, Section III, Paragraph 1 of the Constitution of the State of Georgia; and Article I, Section II, Paragraph 3 of the Constitution of the State of Georgia, 1983, together with the due process clause and equal protection clauses of the Fifth and Fourteenth Amendments to the Constitution of the United States of America..

Any limitation on the time for presentation of the issues before the Board of Commissioners who have the power to zone and rezone is a violation of the guarantees of free speech under Article I, Section I, Paragraph 5 of the Constitution of the State of Georgia, 1983 and the First Amendment of the Constitution of the United States of America. Further, said limitations are in violation of the right to petition and assemble, in violation of Article I, Section I, Paragraph IX of the Constitution of the State of Georgia, 1983 and the First Amendment of the Constitution of the United States of America as well as the due process clauses of the Constitution of Georgia, 1983 and the Constitution of the United States of America.

The Zoning Ordinance of Cobb County, Georgia is unlawful, null and void in that its adoption and map adoption/maintenance did not comply with the requirements of its predecessor ordinance and/or the Zoning Procedures Law, O.C.G.A. § 36-66-1, et seq.

#### IV. CONCLUSION

Based upon the foregoing reasons, the Applicant respectfully requests that the Special Land Use Permit at issue be approved and the Applicant also solicits any comments from staff or other officials of Cobb County so that such recommendations or input may be incorporated as conditions of approval of the Application.

Respectfully submitted, this the 17<sup>th</sup> day of October, 2011.

SAMS, LARKIN & HUFF, LLP

By: 

GARVIS L. SAMS, JR.  
Attorney for Applicant

Suite 100  
376 Powder Springs Street  
Marietta, GA 30064  
(770) 422-7016  
[gsams@samslarkinhuff.com](mailto:gsams@samslarkinhuff.com)



**SAMS, LARKIN & HUFF**  
A LIMITED LIABILITY PARTNERSHIP

GARVIS L. SAMS, JR.  
JOEL L. LARKIN  
PARKS F. HUFF  
JAMES A. BALLI

SUITE 100  
376 POWDER SPRINGS STREET  
MARIETTA, GEORGIA 30064-3448

770-422-7016  
TELEPHONE  
770-426-6583  
FACSIMILE

MELISSA P. HAISTEN  
JUSTIN H. MEEKS

[SAMSLARKINHUFF.COM](http://SAMSLARKINHUFF.COM)

January 26, 2012

**VIA E-MAIL AND HAND DELIVERY**

Mr. John P. Pederson, AICP, Manager  
Cobb County Community Development Agency  
Zoning Division  
1150 Powder Springs Road, Suite 400  
Marietta, GA 30064

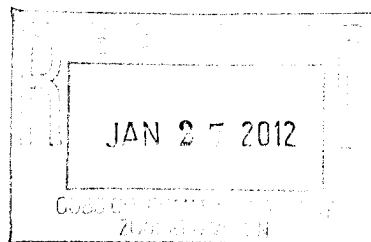

Re: Application of Bankhead C & D Transfer Station, LLC to Rezone a 0.30 Acre  
Tract from GC to HI (No. Z-42)

Application of Bankhead C & D Transfer Station, LLC for a Special Land Use  
Permit (No. SLUP-10)

Dear John:

You will recall that this firm represents Bankhead C & D Transfer Station, LLC ("Bankhead") concerning the above-captioned Applications for Rezoning and for a Special Land Use Permit ("SLUP"). The Applications were heard, considered and unanimously recommended for approval by the Planning Commission on December 5, 2011. Thereafter, the Applications were continued by the Board of Commissioners and are now scheduled to be heard by the Board at its next regularly scheduled zoning hearing on February 21, 2012. As you know, Bankhead's proposal has been approved by the Atlanta Regional Commission ("ARC") as being in the best interest of the State of Georgia and the region. Additionally, the Georgia Regional Transportation Authority ("GRTA") approved the proposal as has the Cobb County's professional staff.

During the pendency of the Applications, we have continued our dialogue with representatives of the Mableton Improvement Coalition ("MIC"), representatives of the Cobb County Cemetery Preservation Commission ("CCCPC"), representatives of the Riverline Historic Area ("RLHA"), the County staff and area business and property owners. In that regard, I have been authorized by Bankhead to submit this revised letter of agreeable stipulations which, if the rezoning and SLUP Applications are approved as submitted, shall become conditions and a part of the grant of the rezoning and SLUP and binding upon the subject property thereafter. The referenced revised stipulations are as follows, to wit:

**SAMS, LARKIN & HUFF**  
A LIMITED LIABILITY PARTNERSHIP

**VIA E-MAIL AND HAND DELIVERY**

Mr. John P. Pederson, AICP, Manager  
Cobb County Community Development Agency  
January 26, 2012  
Page 2

1. The revised stipulations and conditions set forth herein shall replace and supercede in full any and all prior stipulations and conditions in whatsoever form which are currently in place concerning the property which constitutes the subject matter of the above-captioned Rezoning and SLUP Applications.
2. The development of the subject property shall be in substantial conformity to the revised site plans prepared by Planners and Engineers Collaborative which are being filed concurrently herewith. The future construction of any buildings on the subject property shall be accomplished only after review and approval by the District Commissioner. Any new building(s) added to the property shall be completed within one-hundred and eighty (180) days from the commencement of the construction of same.
3. The total site area of the subject property consists of 8.16 acres with an existing Construction & Demolition ("C&D") Transfer Station which shall be modified and/or rebuilt to include Municipal Solid Waste ("MSW") and Recycling components consistent with the Statement of Intent which was submitted under separate cover on October 19, 2011, said Statement of Intent being incorporated herein and made a part hereof by reference.
4. Approval of the Rezoning and SLUP Applications shall be subject to GRTA's Notice of Decision, dated October 21, 2011 and ARC's Regional Review Finding, dated November 27, 2011.
5. Minor modifications to the within stipulations/conditions and the plans filed with the Applications and herewith may be reviewed and approved by the District Commissioner as needed or necessary during the Plan Review process and/or thereafter.
6. All setbacks and buffer areas (except those designated for CCCPC use) may be penetrated for purposes of detention, utilities and stormwater management as long as such encroachments satisfy Cobb County and the Metropolitan River Protection Act ("MRPA") regulations.
7. An agreement to comply with Cobb County Development Standards and Ordinances related to project improvements except as otherwise approved by the Board of Commissioners, the Cobb County Department of Transportation or the Cobb County Community Development Agency, as their respective authority may allow.

**SAMS, LARKIN & HUFF**  
A LIMITED LIABILITY PARTNERSHIP

**VIA E-MAIL AND HAND DELIVERY**

Mr. John P. Pederson, AICP, Manager  
Cobb County Community Development Agency  
January 26, 2012  
Page 3

8. Compliance with recommendations of the CCCPC with respect to the Turner-Sewell Cemetery which is located on the subject property as follows:
  - a. The cemetery area has been surveyed by a qualified archaeologist who has identified the location of all gravesites and established the cemetery boundary as reflected in the Archaeological Reconnaissance prepared by R. S. Webb & Associates, dated July 17, 1997.
  - b. The reestablishment of a fifty foot (50') cemetery preservation buffer and conveying same to Cobb County in the form of a Conservation Easement.
  - c. Relocating the existing six foot (6') high chain-link fence (with the inclusion of a gate) around the perimeter of the cemetery and/or constructing an additional fence so that the positioning of said fence encompasses the cemetery and the fifty foot (50') cemetery preservation buffer.
  - d. The installation of orange protective fence along the outside of the cemetery preservation buffer during any construction on the site.
  - e. With respect to that portion of the cemetery preservation buffer which may have been inadvertently cleared, replacing said buffer in full.
  - f. There is an existing twenty foot (20') easement to the cemetery and a parking easement at the cemetery gate. The cemetery shall remain accessible from dawn to dusk seven (7) days a week from Veterans Memorial Highway and continual access provided by way of key code gate.
  - g. Bankhead shall undertake whatever remedial measures are needful or necessary in order to ensure that the cemetery and its preservation buffer are not subject to erosion and/or stormwater management problems.
  - h. Bankhead shall undertake remedial measures in order to remove any and all dead trees from the cemetery's preservation buffer and to preserve the integrity of the existing fence and any new fencing.
9. The building which will be utilized in connection with the Transfer Station shall consist of an enclosed, Recovered Material Process Facility ("RMF").

**SAMS, LARKIN & HUFF**  
A LIMITED LIABILITY PARTNERSHIP

**VIA E-MAIL AND HAND DELIVERY**

Mr. John P. Pederson, AICP, Manager  
Cobb County Community Development Agency  
January 26, 2012  
Page 4

10. All processing operations of the RMF shall be carried on inside the building, including the delivery of materials and the removal of same for transport.<sup>1</sup>
11. There will be approximately forty-eight (48) truck trips per day to and from the subject property predicated upon the approval of the Applications. Additionally, it is anticipated that employee vehicular trips to and from the subject property will consist of approximately ten (10) trips per day.<sup>2</sup>
12. The hours of operation for the Transfer Station will be from 5:00 a.m. until 6:00 p.m. Monday through Friday and Saturday from 8:00 a.m. until 1:00 p.m. with the business being closed on Sundays.
13. The RMF facility shall be a "clean RMF" meaning that it shall not separate recyclable materials from general garbage and waste and shall accept source-separated recyclable materials.
14. The doors used to allow vehicles to deliver materials shall be closed except when active deliveries are occurring.
15. The RMF shall contain a dust and odor suppression system including overhead misters which will apply water and deodorizer periodically to control dust and odor within the building.
16. The RMF shall contain air dispersion exhaust fans and provide for the manual application of water provided from wash down stations within the building.

---

<sup>1</sup> It is anticipated that the project will transfer 150,000 tons of waste annually.

<sup>2</sup> The route taken for the C & D component is from Veterans Memorial Highway to I-285 South to 85 South in order to access Safeguard C & D Landfill in Fairburn, Georgia. With respect to the MSW component, the routes are either from Veterans Memorial Highway West to Highway 278 towards Rockmart or from Veterans Memorial Highway to Discovery Boulevard to I-20 West then taking the Thornton Road exit towards Rockmart to the Grady Road Landfill.

**SAMS, LARKIN & HUFF**  
A LIMITED LIABILITY PARTNERSHIP

**VIA E-MAIL AND HAND DELIVERY**

Mr. John P. Pederson, AICP, Manager  
Cobb County Community Development Agency  
January 26, 2012  
Page 5

17. Any necessary repairs to the odor control systems shall be made within forty-eight (48) hours or notifications shall be provided to the County if the repairs can not be made within that time frame. In such an event, it will be necessary to obtain a temporary replacement system or secure approval from the Community Development Director for an extension of time in which to perform the necessary repair work.
18. The tipping floor where recyclable materials are dumped shall be washed out at least two (2) times per week or more if deemed necessary.
19. All liquid waste and waste water from inside the building shall be routed to the sanitary sewer with the plan to be approved by Cobb County during the Plan Review process.
20. There shall be no outdoor storage of trash or trucks which have trash in them.
21. The County Arborist shall approve a landscaping plan at Plan Review which will ensure a visual and noise abatement screen. Additionally, an agreement to form a Landscape Advisory Committee consisting of Bankhead, a representative from MIC, a representative from CCCPC and the Director of the Community Development Agency who shall facilitate decisions and be the final arbiter with respect to issues upon which Bankhead, MIC and CCCPC can not agree.

The Landscape Plan which shall be submitted during the Plan Review process shall include the planting of Leland Cypress trees along the northwestern property line from the perimeter of the Turner Sewell Cemetery going southwesterly along said property line and the planting of Leland Cypress trees (to the extent that topography allows for same) along the subject property's southeasterly property line. Said Leland Cypress trees shall consist of a five (5) gallon minimum and will be monitored for three (3) years to ensure adequate growth and health.

The construction of an eight foot (8') privacy fence to be erected along the southeastern side of the property beginning behind the existing office and continuing back to the southeast corner of the subject property. Additionally, the construction of an eight foot (8') privacy fence to be erected along the southwesterly side of the subject property, including the perimeter of the cemetery, which will also encompass the fifty foot (50') cemetery preservation buffer.

**SAMS, LARKIN & HUFF**  
A LIMITED LIABILITY PARTNERSHIP

**VIA E-MAIL AND HAND DELIVERY**

Mr. John P. Pederson, AICP, Manager  
Cobb County Community Development Agency  
January 26, 2012  
Page 6

If, during construction, the dirt mound presently located on the northwest side of the subject property is disturbed, then an eight foot (8') fence shall be erected along with complementary Leland Cypress trees along said fence. Lastly, an eight foot (8') fence shall be constructed along the entire length of the rear property line with complementary Leland Cypress trees.

22. An agreement to designate an on-site project manager during construction and an on-site operational manager/supervisor during the operation of the RMF. The Operations Manager shall be on duty at all times while the facility is open for business.
23. An agreement to incorporate odor control measures such as odor neutralizing spray systems at each door, overhead odor neutralizing misters throughout the buildings and high velocity air dispersion exhaust fans.
24. Manual application of water shall be provided from the wash down stations from inside of the building with water and oil separators also included inside of the building.
25. The subject property shall be kept clear of debris at all times.
26. Bankhead shall be responsible for cleaning up any litter/debris on Veterans Memorial Highway which may inadvertently come off of trucks delivering to the site and this clean-up should occur at a minimum of once per week or more as needed or necessary.
27. Compliance with recommendations from the Cobb County Water System with respect to the availability of water and sewer to the subject property. This will include connecting the development to sewer which is located on an adjacent tract. Additionally, it will require the submission of an application for a revised Industrial Discharge Service Permit.
28. Compliance with recommendations from Stormwater Management Division with respect to hydrology, detention and downstream considerations, including the following:
  - a. The formulation of a Spill Prevention Plan notwithstanding the fact that no hazardous materials are planned for the site.
  - b. A revision to Bankhead's NPDES permit for purposes of discharge.

**SAMS, LARKIN & HUFF**  
A LIMITED LIABILITY PARTNERSHIP

**VIA E-MAIL AND HAND DELIVERY**

Mr. John P. Pederson, AICP, Manager  
Cobb County Community Development Agency  
January 26, 2012  
Page 7

- c. Compliance with MRPA Corridor Regulations.<sup>3</sup>
  - d. The installation of an oil/water separator to treat stormwater as required by Cobb County.
  - e. The installation of curb and gutters on the northeast side of the entrance from Veterans Memorial Highway to the exiting office building. Additionally, the construction of two (2) new lanes on the property for the purposes of ingress and egress for a length of at least fifty feet (50') from the subject property's entrance.
29. Bankhead shall create and maintain a Vector Control Plan on the subject property which shall detail the program for domesticated animal control as well as rodent and insect extermination. An outside exterminating company shall be utilized to exterminate insects and rodents which includes exterminating sprays, poisonous baits and traps. Said service shall be provided on a monthly basis and increased as situations may warrant.
30. Compliance with recommendations of the Cobb County Department of Transportation as follows:
- a. The installation of sidewalk along the subject property's frontage on Veterans Memorial Highway.
  - b. The installation of a one-hundred fifty foot (150') deceleration lane with a fifty foot (50') taper at the subject property's point of ingress/egress on Veterans Memorial Highway.
  - c. Securing approval from the Georgia Department of Transportation with respect to any encroachments or work done within the right-of-way of Veterans Memorial Highway which is a State right-of-way.

---

<sup>3</sup> The preponderance of the subject property is "grandfathered" with respect to impervious surfaces and vulnerability requirements.

**SAMS, LARKIN & HUFF**  
A LIMITED LIABILITY PARTNERSHIP

**VIA E-MAIL AND HAND DELIVERY**

Mr. John P. Pederson, AICP, Manager  
Cobb County Community Development Agency  
January 26, 2012  
Page 8

The subject property is bordered by HI and GC zoned and utilized properties and on the north by Veterans Memorial Highway, a major arterial right-of-way. It is surrounded by all manner of Heavy Industrial uses, including trucking transport facilities, heavy contractors, industrial manufacturers, a crane company and other industrial users. The proposal to add MSW and Recycling components to an existing C & D Transfer Station is consistent with Cobb County's Comprehensive Land Use Plan and Future Land Use Map which reflect that the property is in an Industrial area under the Future Land Use Map. The proposal by Bankhead is entirely appropriate considered in the context of development in which the subject property is situated.

Please do not hesitate to call should you or your staff have any questions or require additional information or documentation prior to the Application being heard and considered for final action by the Board of Commissioners next month. With kind regards, I am

Very truly yours,

SAMS, LARKIN & HUFF, LLP

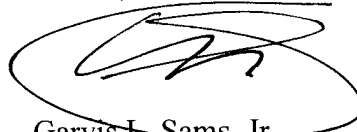

Garvis L. Sams, Jr.  
[gsams@samslarkinhuff.com](mailto:gsams@samslarkinhuff.com)

GLS, Jr./dsj  
Attachment

cc: Members, Cobb County Board of Commissioners (via email & hand delivery w/attachment)  
Mr. Robert L. Hosack, Jr., AICP, Director (via email and hand delivery w/attachment)  
Mr. Dana Johnson, AICP, Manager Planning Division (via email and hand delivery w/attachment)  
Mr. Jason Campbell, Planner II  
Cobb County Community Development Agency (via email and hand delivery w/attachment)  
Mr. Ken Suddreth, Director  
Smyrna Community Development Agency (via email w/attachment)  
Ms. Jane Stricklin, P.E. (via email w/attachment)



**VIA E-MAIL AND HAND DELIVERY**

Mr. John P. Pederson, AICP, Manager  
Cobb County Community Development Agency  
January 26, 2012  
Page 9

Mr. David Breaden, P.E. (via email w/attachment)  
Ms. Karen King, Assistant County Clerk (via email w/attachment)  
Ms. Lori Presnell, Deputy County Clerk (via email w/attachment)  
Mr. Ben Clopper, Mableton Improvement Coalition (via email w/attachment)  
Mrs. Helga Hong, CCCPC (via email w/attachment)  
Ms. Robin Meyer, MIC (via email w/attachment)  
Ms. Roberta Cook, RLHA (via email w/attachment)  
Mr. Kenneth J. Wood, P.E., LEED AP  
Planners and Engineers Collaborative, Inc. (via email w/attachment)  
Mr. Terry Nicholson, Bankhead C & D Transfer Station, LLC (via email w/attachment)

Keith Golden, P.E., Commissioner



GEORGIA DEPARTMENT OF TRANSPORTATION

One Georgia Center, 600 West Peachtree Street, NW  
Atlanta, Georgia 30308  
Telephone: (404) 631-1000

Other Business Item 8  
Exhibit C

April 18, 2012

Mr. Karl Von Hagel  
Airport Manager  
Cobb County Airport – McCollum Field  
1723 McCollum Pkwy, Bldg 100  
Kennesaw, GA 30144

Dear Mr. Von Hagel,

We understand Bankhead C & D Transfer Station, LLC has submitted a Statement of Intent to the Cobb County Zoning Division for consideration of expanding the existing Construction and Demolition Transfer Facility to include an enclosed Municipal Solid Waste Transfer Facility. Per the County's request for further review, our evaluation and recommendation follows and is given so as to ensure the safe operation of the airport is not compromised by incompatible land use.

Our analysis shows the existing C&D Transfer Station is located approximately 5,500 linear feet from the threshold of Fulton County Airport's Runway 26. It is also approximately 2,000 feet from the Fulton County Airport's proposed North Terminal Area, which is slated for imminent development.

According to the Federal Aviation Administration's Advisory Circular (AC) 150/5200-33B, "Hazardous Wildlife Attractants on or Near Airports" Section 2-2.d, enclosed waste transfer stations are generally deemed compatible with airports provided they are not on airport property or within the Runway Protection Zone (RPZ). However, Section 2-2.h states "a C&D landfill co-located with another waste disposal operation should be located outside of the separations identified in Sections 1-2 through 1-4." The referenced sections identify a preferred recommendation of a five mile separation between the waste disposal facility and the closest aircraft operating area. However, it also gives consideration to a 10,000 foot separation.

The proposed facility expansion meets the requirements set forth in Section 2-2.d but fails to meet the stipulation stated in Section 2-2.h regarding co-location of facilities. Since the proposal is a request to co-locate an enclosed Municipal Solid Waste Transfer Facility with an existing Construction and Demolition Transfer Facility and does not meet the guidelines set forth by the FAA the Department does not recommend approval of this request.

Cobb County is reviewing a proposal that has the potential if not sited properly to create an adverse safety and liability impact to an airport and airport sponsor (Fulton County) outside of its jurisdiction. Although Cobb County and its airport will not be directly affected by this request, we urge Cobb County to consider the bearing their decision has on the safety and operation of the Fulton County Airport.

While the Department does not recommend approval of this specific location, there are other alternatives that may be considered. A relocation of the co-located facility outside of the 10,000 foot separation area is one option. Please contact Carla Sands, Airport Development Engineer, at (404) 505-4866 if you have any further questions.

Sincerely,

Carol L. Comer, Director  
Division of Intermodal Programs

cc: Hon. Tim Lee, Cobb County  
Doug Barrett, Fulton County Airport Manager  
Scott Seritt, FAA

Other Business Item 8  
Exhibit C

BANKHEAD TRANSFER STATION  
AN EXISTING INDUSTRIAL TRANSFER STATION  
FOR  
BANKHEAD TRANSFER STATION, I.L.C.  
1490 VETERANS MEMORIAL HIGHWAY  
MARLBTON, GEORGIA 30126  
PHONE: 678-296-1888

REVIS

NO.	DATE	BY
-1	1-25-2012	PBC



--	--	--	--	--	--

[illegible][illegible]



It is the property of the student and is not to be used for any other purpose.

IT IS NOT TO BE USED ON ANY OTHER PROJECTS.  
RETURNED UPON REQUEST. © 1999

SLTS

PLA

SCALE: 1" = 1'

DATE: SEPT  
PROJECT: 1110'

THIS SEAL IS ONLY VALID  
AND DATED WITH AN



1

1

---

\_\_\_\_\_

1

$$1.2 \times 10^{-17} \text{ mol L}^{-1} \text{ s}^{-1} \quad 1.0 \times 10^{-17} \text{ mol L}^{-1} \text{ s}^{-1} \quad 1.0 \times 10^{-17} \text{ mol L}^{-1} \text{ s}^{-1}$$

*Journal of Management Education* 36(1) 7-18  
© The Author(s) 2011  
Reprints and permissions:  
<http://www.sagepub.com/journalsPermissions.nav>

**24 HOUR CONTACT:**  
**TERRY NICHOLSON @ 678-296-1888**

**811**  
Know what's below.  
Call before you dig.

COBB COUNTY CLERK'S OFFICE  
ZONING DIVISION  
JAN 27 2012

**SITE DATA:**  
OVERALL TOTAL SITE AREA 8.16 ACRES  
ZONING  
ZONING AND DIRECTION COMB COUNTY  
EXISTING ZONING SLUP, HI (INDUSTRIAL)

**EXISTING ZONING  
HI-(INDUSTRIAL)  
SLUP**

**APPLICANT:** Bankhead C & D Transfer Station, LLC  
(678) 296-1888

**REPRESENTATIVE:** Garvis L. Sams, Jr. (770) 422-7016  
Sams, Larkin & Huff, LLP

**TITLEHOLDER:** Bankhead C & D Transfer Station, LLC

**PROPERTY LOCATION:** On the southwest side of Veterans  
Memorial Highway, east of Discovery Boulevard

**ACCESS TO PROPERTY:** Veterans Memorial Highway

**PHYSICAL CHARACTERISTICS TO SITE:** Existing transfer  
station

**CONTIGUOUS ZONING/DEVELOPMENT**

**NORTH:** CRC Developed Retail Center and HI/Undeveloped  
**SOUTH:** HI/Developed Industrial Uses  
**EAST:** HI/Developed Industrial Uses  
**WEST:** CRC Developed Retail Center and HI/Undeveloped and Developed Industrial Uses

**OPPOSITION:** NO. OPPOSED        **PETITION NO:**        **SPOKESMAN**       

**PLANNING COMMISSION RECOMMENDATION**

**APPROVED**        **MOTION BY**       

**REJECTED**        **SECONDED**       

**HELD**        **CARRIED**       

**BOARD OF COMMISSIONERS DECISION**

**APPROVED**        **MOTION BY**       

**REJECTED**        **SECONDED**       

**HELD**        **CARRIED**       

**STIPULATIONS:**

**HEARING DATE (PC):** 11-01-2011

**HEARING DATE (BOC):** 11-15-2011

**PRESENT ZONING:** GC & HI

**PROPOSED ZONING:** Special Land  
Use Permit

**PROPOSED USE:** Expanding Existing  
Transfer Station

**SIZE OF TRACT:** 8.16 acres

**DISTRICT:** 18

**LAND LOT(S):** 282, 286

**PARCEL(S):** 8

**TAXES: PAID**        **DELINQUENT** X\*

**COMMISSION DISTRICT:** 4

**\*As of April 18, 2012**

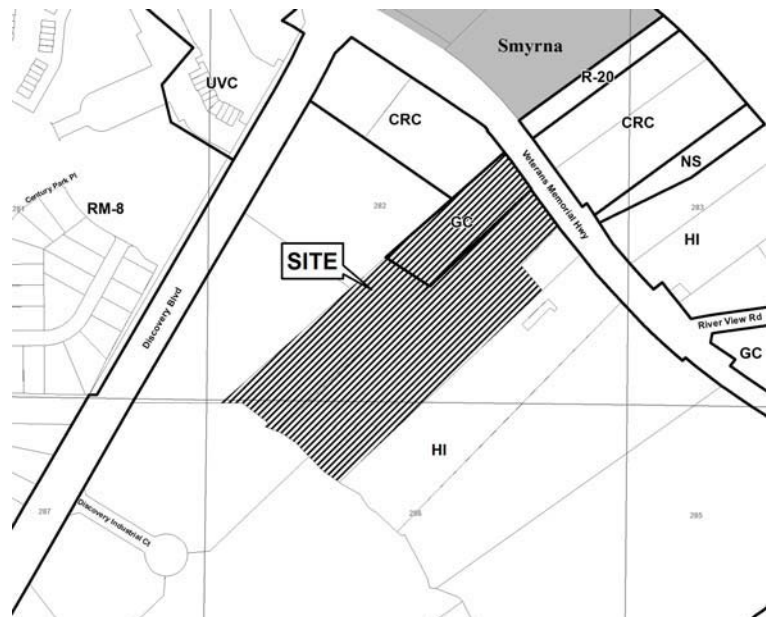

# SLUP-10

Other Business Item 8  
Exhibit C

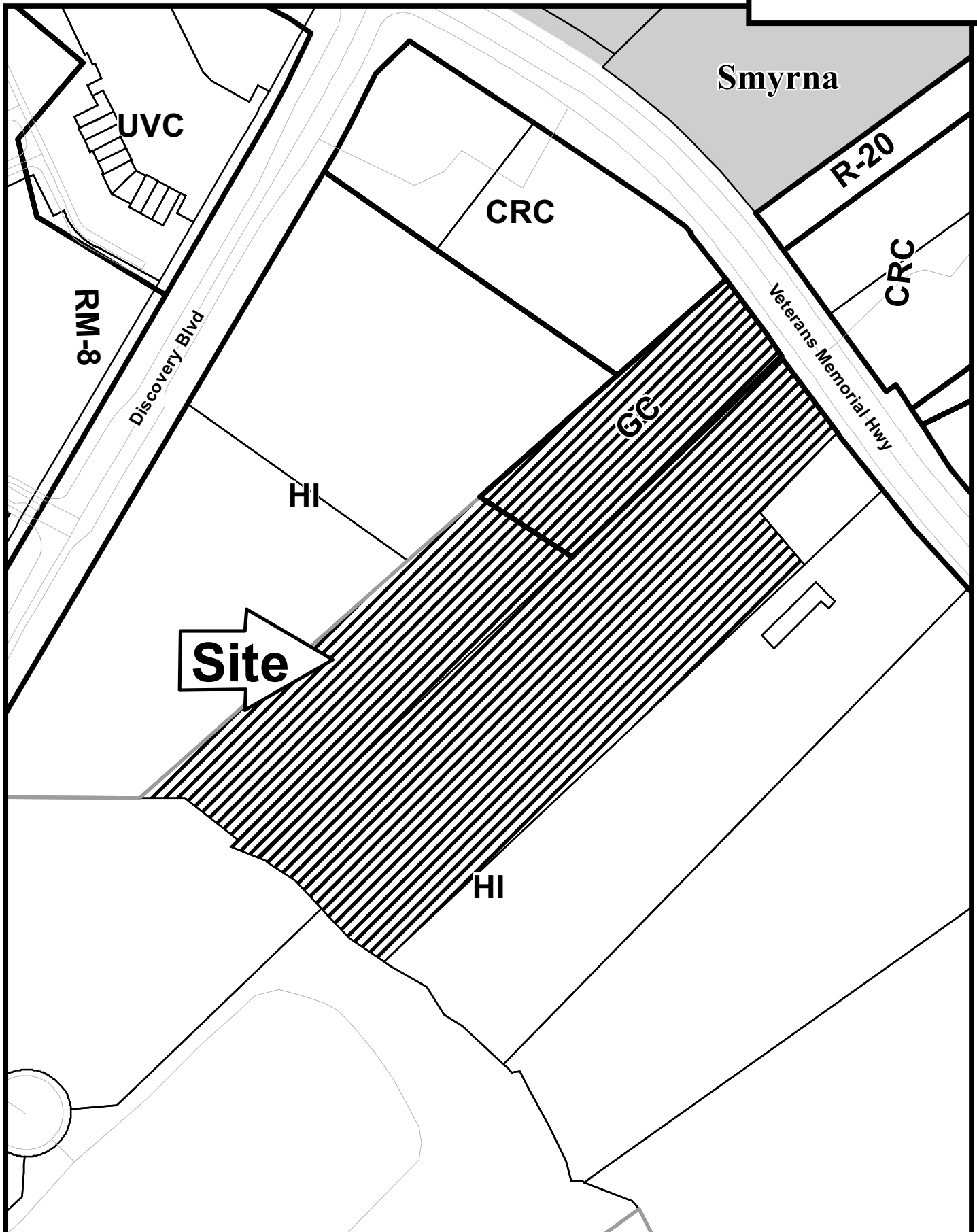

This map is provided for display and planning purposes only. It is not meant to be a legal description.

100 0 100  
Feet



City Boundary  
Zoning Boundary

**APPLICANT:** Bankhead C & D Transfer Station, LLC

**PETITION NO.:** SLUP-10

**PRESENT ZONING:** GC & HI

**PETITION FOR:** SLUP

\*\*\*\*\*

Other Business Item 8  
Exhibit C

**PLANNING COMMENTS:** **Staff Member Responsible:** Jason A. Campbell

The applicant is requesting a Special Land Use Permit to develop and operate a waste transfer station that accepts municipal solid waste (msw). The proposal is to add municipal solid waste to the existing construction and demolition transfer station. It is anticipated that the project will transfer 150,000 tons of waste annually. All processing operations will be carried on inside the building, including the delivery of materials and the removal of same for transport. The applicant would employ technology to abate and control unpleasant odors, and to eliminate contaminated runoff. The proposed hours of operation for the waste transfer station and recycling facility will be Monday through Friday from 5:00 am to 6:00 pm, and on Saturday from 8:00 am to 1:00 p.m. The applicant has a Special Land Use Permit (SLUP-9 of 2004) for construction and demolition transfer only. The applicant has submitted a Statement of Intent and stipulation letter, which are attached for review. The Georgia Regional Transportation Authority and the Atlanta Regional Commission have approved the applicant's request. The Georgia Department of Transportation (GDOT) represents the Federal Aviation Administration (FAA) in local matters, and they have sent a letter dated April 18, 2012 (see attached) regarding this application. The letter from GDOT recommends this request not be approved due to the negative effect the proposal may have on air navigation safety and liability for Fulton County Airport.

**Historic Preservation:** No comments.

**Cemetery Preservation:** The Cobb Cemetery Preservation Commission is satisfied with the current stipulations that were placed on the cemetery land by Bessemer Properties in May 1996. We wish to continue the stipulations and ensure that there will be no parking in the cemetery buffer; also that access to the cemetery is not inhibited by persons parking in or along the cemetery access.

\*\*\*\*\*

**WATER & SEWER COMMENTS:**

Connection to sanitary sewer required for wash down of tipping floor. Industrial Discharge Permit issued by CCWS most likely required.

**APPLICANT:** Bankhead C & D Transfer Station, LLC

**PRESENT ZONING:** GC & HI

**PETITION NO.:** SLUP-10

**PETITION FOR:** SLUP

\*\*\*\*\*

Other Business Item 8  
Exhibit C

**TRAFFIC COMMENTS:**

- Recommend installing sidewalk along the road frontage.
- Recommend removing existing unused driveway apron.
- Recommend a deceleration lane at the main access driveway.
- GDOT permits will be required for all work encroaching upon state right-of-way.
- Recommend applicant be required to meet all Cobb County Development Standards and Ordinances related to project improvements.

\*\*\*\*\*

**FIRE DEPARTMENT COMMENTS:**

**NO COMMENTS:** After analyzing the information presented for a Preliminary Review, the Cobb County Fire Marshal’s Office is confident that all other items can be addressed during the Plan Review Stage.

APPLICANT: Bankhead C & D Transfer Station, LLC

PETITION NO.: SLUP-10

PRESENT ZONING: GC & HI

PETITION FOR: SLUP

\*\*\*\*\*

Other Business Item 8  
Exhibit C

**DRAINAGE COMMENTS**

FLOOD HAZARD: ☐ YES ☒ NO ☐ POSSIBLY, NOT VERIFIED

DRAINAGE BASIN: Chattahoochee River FLOOD HAZARD INFO: Zone X

- ☐ FEMA Designated 100 year Floodplain Flood.
- ☐ Flood Damage Prevention Ordinance DESIGNATED FLOOD HAZARD.
- ☒ Project subject to the Cobb County Flood Damage Prevention Ordinance Requirements.
- ☐ Dam Breach zone from (upstream) (onsite) lake – need to keep residential buildings out of hazard.

WETLANDS: ☐ YES ☒ NO ☐ POSSIBLY, NOT VERIFIED

Location: \_\_\_\_\_

- ☐ The Owner/Developer is responsible for obtaining any required wetland permits from the U.S. Army Corps of Engineer.

STREAMBANK BUFFER ZONE: ☒ YES ☐ NO ☐ POSSIBLY, NOT VERIFIED

- ☒ Metropolitan River Protection Area (within 2000' of Chattahoochee River) ARC (review 35' undisturbed buffer each side of waterway).
- ☐ Chattahoochee River Corridor Tributary Area – County review (\_\_\_\_\_ undisturbed buffer each side).
- ☒ Georgia Erosion-Sediment Control Law and County Ordinance – **County Review**/State Review.
- ☐ Georgia DNR Variance may be required to work in 25 foot streambank buffers.
- ☒ County Buffer Ordinance: **50'**, 75', 100' or 200' each side of creek channel.

**DOWNSTREAM CONDITION**

- ☐ Potential or Known drainage problems exist for developments downstream from this site.
- ☐ Stormwater discharges must be controlled not to exceed the capacity available in the downstream storm drainage system.
- ☒ Minimize runoff into public roads.
- ☒ Minimize the effect of concentrated stormwater discharges onto adjacent properties.
- ☐ Developer must secure any R.O.W required to receive concentrated discharges where none exist naturally
- ☐ Existing Lake Downstream \_\_\_\_\_.  
Additional BMP's for erosion sediment controls will be required.
- ☐ Lake Study needed to document sediment levels.
- ☐ Stormwater discharges through an established residential neighborhood downstream.
- ☒ Project engineer must evaluate the impact of increased volume of runoff generated by the proposed project on downstream receiving stream.



APPLICANT: Bankhead C & D Transfer Station, LLC

PETITION NO.: SLUP-10

PRESENT ZONING: GC & HI

PETITION FOR: SLUP

\*\*\*\*\*

Other Business Item 8  
Exhibit C

DRAINAGE COMMENTS CONTINUED

SPECIAL SITE CONDITIONS

- ☐ Provide comprehensive hydrology/stormwater controls to include development of out parcels.
- ☒ Submit all proposed site improvements to Plan Review.
- ☐ Any **spring activity** uncovered must be addressed by a qualified geotechnical engineer (PE).
- ☐ Structural fill \_\_\_\_\_ must be placed under the direction of a qualified registered Georgia geotechnical engineer (PE).
- ☒ Existing facility.
- ☒ Project must comply with the Water Quality requirements of the CWA-NPDES-NPS Permit and County Water Quality Ordinance.
- ☐ Water Quality/Quantity contributions of the existing lake/pond on site must be continued as baseline conditions into proposed project.
- ☐ Calculate and provide % impervious of project site.
- ☐ Revisit design; reduce pavement area to reduce runoff and pollution.

INSUFFICIENT INFORMATION

- ☒ No Stormwater controls shown.
- ☐ Copy of survey is not current – Additional comments may be forthcoming when current site conditions are exposed.
- ☒ No site improvements showing on exhibit.

ADDITIONAL COMMENTS

1. A Notice of Intent must be filed with the Georgia Environmental Protection Division for coverage under the NPDES General Permit to discharge stormwater associated with industrial activities. This facility will likely be classified under the Standard Industrial Classification (SIC) Code 4953 as a solid waste transfer operation. Any requirements associated with this permit must be addressed including the development of a written stormwater pollution prevention plan (SWPPP) for the site.
2. In addition to other best management practices (BMPs) that may be required for this site during Plan Review, the detention pond outlet control structure design should include a “snout type” device for any low flow orifices.
3. This site is located within the Chattahoochee River Corridor and is therefore subject to provisions of the Metropolitan River Protection Act.

**STAFF RECOMMENDATIONS****SLUP-10      BANKHEAD TRANSFER STATION, LLC**

The applicant's property has been used as a transfer station and is seeking to add the additional use of municipal solid waste to its operation. The property is within the Industrial land use category and is zoned Heavy Industrial (with the exception of a small portion currently zoned GC that is the subject of rezoning request Z-42 being considered concurrently with this SLUP application). The applicant's property is located in an area that is predominantly zoned and used for Heavy Industrial uses. The applicant's current designation as Industrial on the *Cobb County Comprehensive Plan* makes the request for the rezoning of the GC portion compatible with the overall zoning and proposed use of the property. These land use and zoning designations provide for the most intense land uses in Cobb County. Those uses may contain large-scale outdoor storage, uses that may be noisy, may cause vibrations, operate constantly, generate heavy truck traffic, emit odors and/or emissions and may require federal and/or state permits. The applicant's proposal will be located within close proximity to major regional transportation corridors such as Veterans Memorial Highway, Discovery Boulevard and River View Road. The Georgia Regional Transportation Authority has issued findings that support the applicant's request and the Atlanta Regional Commission has approved the applicant's request. There are other waste transfer stations in the county that are situated much closer to residential properties than this proposal. Those waste transfer stations have employed various measures to substantially reduce negative effects on nearby properties; these measures have included odor and noise abatement systems and heavy landscaping. The Georgia Department of Transportation (GDOT) represents the Federal Aviation Administration (FAA) in local matters, and they have sent a letter dated April 18, 2012 (see attached) regarding this application. The letter from GDOT recommends this request not be approved due to the negative effect the proposal may have on air navigation safety and liability for Fulton County Airport.

Based on the above analysis, Staff recommends DENIAL.

**The recommendations made by the Planning and Zoning Staff are only the opinions of the Planning and Zoning Staff and are by no means the final decision. The Cobb County Board of Commissioners makes the final decisions on all Rezoning and Land Use Permits at an advertised public hearing.**

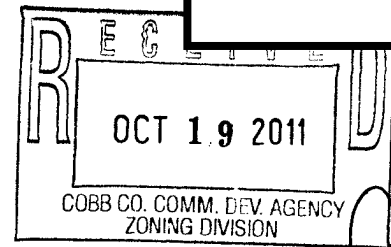

**STATEMENT OF INTENT**

**OF**

**BANKHEAD C & D TRANSFER STATION, LLC**

**Special Land Use Permit Application (SLUP – 10)  
For an 8.16 Acre Tract of Land located in  
Land Lot 282 & 286, 18<sup>th</sup> District, 2<sup>nd</sup> Section,  
Cobb County, Georgia**

**Submitted for the Applicant by:**

**Garvis L. Sams, Jr.  
Sams, Larkin & Huff, LLP  
Suite 100  
376 Powder Springs Street  
Marietta, GA 30064  
(770) 422-7016  
[gsams@samslarkinhuff.com](mailto:gsams@samslarkinhuff.com)**

## I. INTRODUCTION

This Application seeks a Special Land Use Permit ("SLUP") to allow for the expansion of an existing Construction and Demolition (C & D) transfer station to include Municipal Solid Waste ("MSW"). The proposed expansion to include MSW is located on a 8.16 acre tract of land located on Veterans Memorial Highway in Land Lots 282 & 286 of the 18<sup>th</sup> District, 2<sup>nd</sup> Section, Cobb County, Georgia ("subject property"). The subject property is zoned Heavy Industrial ("HI") and is delineated as "Industrial" on Cobb County's Future Land Use Map ("FLUM"). Both the zoning district of HI and the FLUM designation allow for the uses which presently exist and those proposed with the SLUP pursuant to § 134-37 and § 134-231 of the Cobb County Zoning Ordinance.

A preponderance of the subject property is developed with the existing C & D Transfer Station and is "grandfathered" under the Metropolitan Protection Act ("MRPA") requirements as it lies within the Chattahoochee River MRPA Corridor. The subject property is surrounded on the south, east and west by a variety of Heavy Industrial uses, including heavy contractors, a trucking transport company, a crane company, and industrial manufacturers to name but a few. It is also located in close proximity to major, regional transportation corridors such as Interstate 285, South Cobb Drive and Veterans Memorial Highway from which the present C & D Transfer Station operates.

The Applicant plans to modify its existing buildings to accommodate an enclosed Recovered Material Processing Facility ("RMF"). On the subject property the trash collection trucks will discharge their loads in order for the trash can be relocated onto larger vehicles (see Cobb County Code of Ordinances Code § 102-5, where a "Transfer Station" is defined as a "facility used to transfer solid waste from one transportation vehicle to another for transportation to a disposal facility or processing operation.". The combination of a C & D and MSW Transfer

Station provides for a number of benefits. It will reduce the truck traffic on the County's highways by serving as a waste delivery consolidation point. Generally speaking, for every five (5) vehicles which enter the facility, only one is needed to haul waste on the final leg of the disposal journey. It has beneficial effects upon emissions, energy use and road wear and tear. It will also lower collection costs, as crews spend less time traveling to and from distant disposal sites and more time collecting waste, reducing the costs for labor, fuel and collection and vehicle maintenance. There are presently only five (5) private transfer stations now operating in Cobb County. The Applicant anticipates that the Waste Transfer Station with the added MSW component will receive approximately 150,000 tons of solid waste per year (12,500 tons per month) in roughly nine (9) truck loads leaving the facility per day.

The Applicant proposes the following hours of operation for the combined C & D and MSW Facility.

The Applicant proposes that the hours of operation for the facility shall be as follows:

Monday through Friday: 5:00 a.m. until 6:00 p.m.

Saturday: 8:00 a.m. until 1:00 p.m.

Sunday: Closed

Further, the facility will comply with all applicable federal, state and local requirements, including the County's Solid Waste Ordinance which "regulates the storage, collection, transportation and disposal of solid waste within the unincorporated areas of Cobb County". Cobb County Code of Ordinances, § 102-1, et seq.

All processing operations of the RMF shall be carried on inside of the building, including the delivery of materials and the removal of same for transport with the facility constituting a "clean RMF", meaning that it shall not separate recyclable materials from general garbage and waste and shall accept source separated recyclable materials. Additionally, the doors to the

facility used to allow vehicles to deliver materials shall be closed except when active deliveries are occurring. The RMF will also contain a dust and odor suppression system, including overhead misters which will apply water and deodorizer periodically to control dust and odor within the building, air disbursement exhaust fans and will provide for manual application of water provided from wash down stations within the building.

In addition to the foregoing, the Applicant will agree to make any necessary repairs to the odor control systems within forty-eight (48) hours or notify the County if repairs cannot be made within that time frame. In that event, it will be incumbent upon the Applicant to obtain a temporary replacement system or secure approval from the Community Development Director for an extension of time in which to repair. The RMF will also contain a tipping floor where recyclable materials will be dumped and it will be washed down at least two (2) times per week with all liquid waste and wastewater from inside the building being routed to the sanitary sewer with the plan to be approved by the County during the Plan Review Process. There will be no outdoor storage of trash or trucks which have trash in them and the Applicant will be responsible for the installation of an oil/water separator to treat stormwater as required by the County. Operationally, the RMF will designate an on-site project manager during construction and an on-site operational manager/supervisor during the operation of the facility.

Recently, the Board of Commissioners ("BOC") voted to approve a settlement of litigation to approve SLUP-6 (1999 S&S Investment Company) to allow for a Recycling Recovery Facility and Transfer Stations. The staff report recommending "approval" and upon which the BOC's ultimate decision after litigation was commenced was presumably based could have easily been describing the subject property when it stated in pertinent part, as follows:

“The Applicant’s property has been zoned Heavy Industrial without any rezoning conditions or stipulations since the Zoning Code and Zoning Map were adopted in 1972. The Applicant’s property is located in an area predominately zoned and used for Heavy Industrial uses. The Applicant’s property has been designated as Industrial by the Cobb County Comprehensive Land Use Plan since it was adopted. The Heavy Industrial zoning category and the Industrial Future Land Use category provides [sic] for the most intensive land uses in Cobb County. There are uses that may contain large scale outdoor storage, uses that may be noisy, uses that may cause vibrations, uses that may operate constantly, uses that may generate heavy truck traffic, uses that may emit odors and/or emissions and uses that may require federal and/or state permits. Industrial uses on adjacent and nearby properties include warehouses, trucking companies, heavy contractors, manufacturing and distributors. The Applicant’s proposal is located within close proximity to major regional transportation corridors such as Veterans Memorial Highway, South Cobb Drive and Interstate 285. The Applicant’s property is located within the boundaries of the *Industrial Land Inventory and Protection Policy* which is a study that the Cobb County Planning Division generated to protect industrial property in the County. There are other Waste Transfer Stations in the County that are situated much closer to residential properties than this proposal. Those Waste Transfer Stations have employed various measures to substantially reduce negative impacts on nearby properties; these measures have included odor and noise abatement systems and heavy landscaping. Based on the above analysis, **STAFF RECOMMENDS APPROVAL** subject to the following:

- Site plan received by the Zoning Division.
- Applicant incorporate odor control measures such as odor neutralizing spray systems at each door, overhead odor neutralizing misters throughout the building and high velocity air dispersion exhaust fans; all transfers . . . take place inside the buildings, with a tipping floor to be cleaned at least once daily;
- All liquid waste from inside the building be routed to sanitary sewer, with plan to be approved by Water System engineers at Plan Review;
- An Arborist approved landscape plan at Plan Review that would ensure a visual and noise abatement screen with [sic] five-years of land disturbance.
- Fire Department Comments;
- Water and Sewer Comments and Recommendations;
- Development of regional impact from ARC and GRTA;
- Applicant meet all state permitting requirements;
- Stormwater Management Comments and Recommendations;
- and,
- DOT Comments and Recommendations.”

For the same reasons and the reasons stated herein, the BOC should approve this requested SLUP-10 as well.

In addition to the existing C & D component and the proposed MSW component, the Applicant's proposal includes plans for a Recycling Center as a part of the proposed facility consistent with Cobb County's stated desire to encourage the recycling of materials:

"The goal of the citizens of Cobb County is to cooperate by reducing their waste and by 'Reusing, Recycling and Composting', both at home and at work. Everyone must be involved in reducing waste generation and disposal." Draft of Cobb County Comprehensive Solid Waste Management Plan (2009-2019), P.ES-2.

The County's goal is designed to promote sustainability and to divert renewable waste away from landfills. In fact, a 2006 study revealed "that nearly 2.6 million tons – or approximately forty percent (40%) of the municipal solid waste Georgians throw away per year are recyclable material with existing end markets within the state."

To address that issue, the Applicant proposes the recycling component within the RMF within which paper, aluminum/steel cans, plastic and glass (materials which would otherwise become solid waste) are collected, separated and ultimately reused or returned to use in the form of new materials or products. Data indicates that the type of recyclable materials which the Applicant intends to focus upon collectively make up approximately Fifty-One Percent (51%) of Cobb County's waste composition. Draft Comprehensive Solid Waste Management Plan at P.2-4.



## **II. CRITERIA TO BE APPLIED TO SPECIAL LAND USE PERMITS**

**A. Whether or not there will be a significant adverse effect on the neighborhood or area in which the proposed use will be located.**

The subject property is bordered on its east, south and west sides by HI zoned and utilized properties and on the north by Veterans Memorial Highway, a major arterial right of way. It is surrounded by all manner of Heavy Industrial uses, including trucking transport facilities, heavy contractors, industrial manufacturers, a crane company and all manner of industrial users to name just a few. The "neighborhood" or area in which the proposed expansion to the existing use will be located was specifically designed to contain large scale outdoor storage uses that may be noisy, uses that may cause vibration, uses that may operate constantly, uses that may generate heavy truck traffic, uses that may emit odors and/or emissions and uses that may require federal and/or state permits. Therefore, the proposed expansion to the existing use is consistent with uses on adjacent and nearby properties and will have no adverse effect upon them.

**B. Whether or not the use is otherwise compatible with the neighborhood.**

The neighborhood within which the subject property is located is zoned HI and has a designation of Industrial on the County's FLUM. As referred to previously, both the zoning district and the land use category are specifically designed to contain large-scale outdoor storage uses that may be noisy, uses that may cause vibrations, uses that may operate constantly, uses that may generate heavy truck traffic, uses that may omit odors and/or emissions and uses that may require federal and/or state permits. Given these facts and the reality that the area already consists of Heavy Industrial uses like warehouses, heavy contractors, trucking companies, a crane company and a veritable plethora of Industrial users, the proposed use is compatible with the neighborhood.

**C. Whether or not the use proposed will result in a nuisance as defined under state law.**

The proposed use will not result in a nuisance, either public or private, as that term is defined by Georgia law. The expansion of the proposed C & D with an MSW component will be enclosed. Moreover, the Heavy Industrial area in which the subject property is located specifically allows and is compatible with uses which create noise, smoke, dust, odor or vibrations. Finally, the proposed expansion to the existing use is located in close proximity to Interstate 285, South Cobb Drive and Veterans Memorial Highway, limiting heavy truck traffic on minor roadways.

**D. Whether or not quiet enjoyment of surrounding property will be adversely affected.**

The surrounding properties consist exclusively of Heavy Industrial uses and are used in a manner similar to that which the Applicant proposes. Further, the proposed use is located in close proximity to Interstate 285, South Cobb Drive and Veterans Memorial Highway, limiting heavy truck traffic on minor roadways.

**E. Whether or not property values of surrounding property will be adversely affected.**

The surrounding properties consist exclusively of Heavy Industrial uses and are used in a manner similar to that which the Applicant proposes. Therefore, the values of surrounding properties will not be adversely affected.

**F. Whether or not adequate provisions are made for parking and traffic considerations.**

The proposal will meet the County's parking requirements. The Heavy Industrial area in which the subject property is located was specifically designed for uses which may generate heavy truck traffic, given its proximity to Interstate 285, South Cobb Drive and Veterans Memorial Highway. The Applicant also notes that the proposal will be

reviewed as a Development of Regional Impact ("DRI") by both the Atlanta Regional Commission ("ARC") and the Georgia Regional Transportation Authority ("GRTA"). Traffic impacts will be considered during this process and additional improvements is presently being added.

**G. Whether or not the site or intensity of the use is appropriate.**

The subject property consists of over eight (8) acres of land. The Applicant proposes utilizing the existing footprint to modify the existing building to a Recovered Material Processing Facility ("RMF"). Total impervious coverage is only sixty-six percent (66%) of the site. The size of the property is more than adequate to accommodate the proposed expansion to the existing use.

**H. Whether or not special or unique conditions overcome the Board of Commissioners' general presumption that residential neighborhoods should not allow non-compatible business uses.**

The area at issue is not residential and the proposed use is entirely compatible with existing contiguous Heavy Industrial uses.

**I. Whether or not adequate provisions are made regarding hours of operation.**

The hours of operation will mirror those of existing Heavy Industrial uses on adjacent and nearby properties as mentioned above.

**J. Whether or not adequate controls and limits are placed on commercial and business deliveries.**

Deliveries to the subject property will be commensurate in number and type to existing deliveries on adjacent and nearby Heavy Industrial properties.

**K. Whether or not adequate landscape plans are incorporated to ensure appropriate transition.**

Not applicable in view of the fact that the subject property is surrounded by HI properties.

**L. Whether or not the public health, safety, welfare or moral concerns of the surrounding neighborhood will be adversely affected.**

The surrounding "neighborhood" consists of Heavy Industrial uses, all of which are comparable to the use proposed.

**M. Whether the Application complies with any applicable specific requirement set forth in this chapter for a Special Land Use Permit for particular types of uses.**

The application meets all of the requirements for a Special Land Use Permit pursuant to § 134-37 and all required information has been supplied.

**N. Whether the Applicant has provided sufficient information to allow a full consideration of all relevant factors.**

The Applicant has addressed all issues raised by law. The Applicant also remains available to respond to any questions or issues raised by the County's professional staff or by Members of the Planning Commission or Board of Commissioners.

**III. PRESERVATION OF CONSTITUTIONAL RIGHTS**

The Zoning Ordinance of Cobb County, Georgia lacks adequate standards for the Board of County Commissioners to exercise its power to issue Special Land Use Permits. In essence, the standards are not sufficient to contain the discretion of the Board of Commissioners and to provide the Courts with a reasonable basis for judicial review. Because the stated standards (individually and collectively) are too vague and uncertain to provide reasonable guidance to the Board of Commissioners, the Zoning Ordinance violates the Fifth and Fourteenth Amendments

of the Constitution of the United States in matters of zoning. The Zoning Resolution also violates Article I, Section III, Paragraph 1; and Article 1, Paragraphs 1 and 2 of the Constitution of the State of Georgia, 1983.

The Board of Commissioners is granted the power to zone pursuant to Article IX, Section II, Paragraph 4 of the Constitution of the State of Georgia, 1983. It is a power which must be fairly exercised. Based on this element of fairness, the Zoning Ordinance of Cobb County, Georgia violates Article IX, Section II, Paragraph 4 of the Constitution of the State of Georgia, 1983.

The Zoning Ordinances presently in effect is contrary to the best interests of the health and welfare of the citizens of Cobb County, Georgia, and constitutes an arbitrary and capricious act. As a result, the Zoning Ordinance is in violation of Article I, Section III, Paragraph 1 of the Constitution of the State of Georgia; and Article I, Section II, Paragraph 3 of the Constitution of the State of Georgia, 1983. Furthermore, the Zoning Ordinance violates the due process clause and equal protection clauses of the Fifth and Fourteenth Amendments to the Constitution of the United States of America.

In addition, the Zoning Ordinance is unconstitutional in that it renders the subject property unusable and destroys its marketability. Therefore, the Zoning Ordinance constitutes a taking of the Applicant's property without just and adequate compensation and without due process of law in violation of the Fifth and Fourteenth Amendments to the United States Constitution and in violation of Article I, Section I, Paragraph 1 and Article I, Section III, Paragraph 1(a) of the Constitution of Georgia.

The failure to approve the requested Special Land Use Permit for the subject property would constitute the taking of property without due process and without the payment of adequate compensation in violation of Article I, Section I, Paragraph 1 of the Constitution of the State of

Georgia, 1983; and the Fifth and Fourteenth Amendments of the Constitution of the United States.

Failure to grant the Application for the Special Land Use Permit would be contrary to the best interests of the health and welfare of the citizens of Cobb County, Georgia, and would further constitute an arbitrary and capricious act. As such, failure to grant the application would constitute a violation of Article I, Section I, Paragraph 1 of the Constitution of the State of Georgia, 1983; and Article I, Section III, Paragraph 1 of the Constitution of the State of Georgia; and Article I, Section II, Paragraph 3 of the Constitution of the State of Georgia, 1983, together with the due process clause and equal protection clauses of the Fifth and Fourteenth Amendments to the Constitution of the United States of America..

Any limitation on the time for presentation of the issues before the Board of Commissioners who have the power to zone and rezone is a violation of the guarantees of free speech under Article I, Section I, Paragraph 5 of the Constitution of the State of Georgia, 1983 and the First Amendment of the Constitution of the United States of America. Further, said limitations are in violation of the right to petition and assemble, in violation of Article I, Section I, Paragraph IX of the Constitution of the State of Georgia, 1983 and the First Amendment of the Constitution of the United States of America as well as the due process clauses of the Constitution of Georgia, 1983 and the Constitution of the United States of America.

The Zoning Ordinance of Cobb County, Georgia is unlawful, null and void in that its adoption and map adoption/maintenance did not comply with the requirements of its predecessor ordinance and/or the Zoning Procedures Law, O.C.G.A. § 36-66-1, et seq.

#### IV. CONCLUSION

Based upon the foregoing reasons, the Applicant respectfully requests that the Special Land Use Permit at issue be approved and the Applicant also solicits any comments from staff or other officials of Cobb County so that such recommendations or input may be incorporated as conditions of approval of the Application.

Respectfully submitted, this the 17<sup>th</sup> day of October, 2011.

SAMS, LARKIN & HUFF, LLP

By: 

GARVIS L. SAMS, JR.  
Attorney for Applicant

Suite 100  
376 Powder Springs Street  
Marietta, GA 30064  
(770) 422-7016  
[gsams@samslarkinhuff.com](mailto:gsams@samslarkinhuff.com)

**SAMS, LARKIN & HUFF**  
A LIMITED LIABILITY PARTNERSHIP

GARVIS L. SAMS, JR.  
JOEL L. LARKIN  
PARKS F. HUFF  
JAMES A. BALLI

SUITE 100  
376 POWDER SPRINGS STREET  
MARIETTA, GEORGIA 30064-3448

770-422-7016  
TELEPHONE  
770-426-6583  
FACSIMILE

MELISSA P. HAISTEN  
JUSTIN H. MEEKS

SAMSLARKINHUFF.COM

January 26, 2012

**VIA E-MAIL AND HAND DELIVERY**

Mr. John P. Pederson, AICP, Manager  
Cobb County Community Development Agency  
Zoning Division  
1150 Powder Springs Road, Suite 400  
Marietta, GA 30064

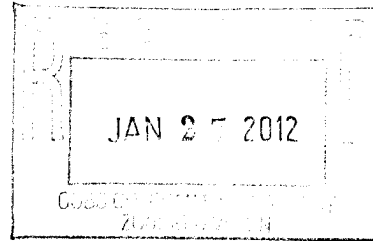

Re: Application of Bankhead C & D Transfer Station, LLC to Rezone a 0.30 Acre  
Tract from GC to HI (No. Z-42)

Application of Bankhead C & D Transfer Station, LLC for a Special Land Use  
Permit (No. SLUP-10)

Dear John:

You will recall that this firm represents Bankhead C & D Transfer Station, LLC ("Bankhead") concerning the above-captioned Applications for Rezoning and for a Special Land Use Permit ("SLUP"). The Applications were heard, considered and unanimously recommended for approval by the Planning Commission on December 5, 2011. Thereafter, the Applications were continued by the Board of Commissioners and are now scheduled to be heard by the Board at its next regularly scheduled zoning hearing on February 21, 2012. As you know, Bankhead's proposal has been approved by the Atlanta Regional Commission ("ARC") as being in the best interest of the State of Georgia and the region. Additionally, the Georgia Regional Transportation Authority ("GRTA") approved the proposal as has the Cobb County's professional staff.

During the pendency of the Applications, we have continued our dialogue with representatives of the Mableton Improvement Coalition ("MIC"), representatives of the Cobb County Cemetery Preservation Commission ("CCCPC"), representatives of the Riverline Historic Area ("RLHA"), the County staff and area business and property owners. In that regard, I have been authorized by Bankhead to submit this revised letter of agreeable stipulations which, if the rezoning and SLUP Applications are approved as submitted, shall become conditions and a part of the grant of the rezoning and SLUP and binding upon the subject property thereafter. The referenced revised stipulations are as follows, to wit:



**SAMS, LARKIN & HUFF**  
A LIMITED LIABILITY PARTNERSHIP

**VIA E-MAIL AND HAND DELIVERY**

Mr. John P. Pederson, AICP, Manager  
Cobb County Community Development Agency  
January 26, 2012  
Page 2

1. The revised stipulations and conditions set forth herein shall replace and supercede in full any and all prior stipulations and conditions in whatsoever form which are currently in place concerning the property which constitutes the subject matter of the above-captioned Rezoning and SLUP Applications.
2. The development of the subject property shall be in substantial conformity to the revised site plans prepared by Planners and Engineers Collaborative which are being filed concurrently herewith. The future construction of any buildings on the subject property shall be accomplished only after review and approval by the District Commissioner. Any new building(s) added to the property shall be completed within one-hundred and eighty (180) days from the commencement of the construction of same.
3. The total site area of the subject property consists of 8.16 acres with an existing Construction & Demolition ("C&D") Transfer Station which shall be modified and/or rebuilt to include Municipal Solid Waste ("MSW") and Recycling components consistent with the Statement of Intent which was submitted under separate cover on October 19, 2011, said Statement of Intent being incorporated herein and made a part hereof by reference.
4. Approval of the Rezoning and SLUP Applications shall be subject to GRTA's Notice of Decision, dated October 21, 2011 and ARC's Regional Review Finding, dated November 27, 2011.
5. Minor modifications to the within stipulations/conditions and the plans filed with the Applications and herewith may be reviewed and approved by the District Commissioner as needed or necessary during the Plan Review process and/or thereafter.
6. All setbacks and buffer areas (except those designated for CCCPC use) may be penetrated for purposes of detention, utilities and stormwater management as long as such encroachments satisfy Cobb County and the Metropolitan River Protection Act ("MRPA") regulations.
7. An agreement to comply with Cobb County Development Standards and Ordinances related to project improvements except as otherwise approved by the Board of Commissioners, the Cobb County Department of Transportation or the Cobb County Community Development Agency, as their respective authority may allow.

**SAMS, LARKIN & HUFF**  
A LIMITED LIABILITY PARTNERSHIP

**VIA E-MAIL AND HAND DELIVERY**

Mr. John P. Pederson, AICP, Manager  
Cobb County Community Development Agency  
January 26, 2012  
Page 3

8. Compliance with recommendations of the CCCPC with respect to the Turner-Sewell Cemetery which is located on the subject property as follows:
  - a. The cemetery area has been surveyed by a qualified archaeologist who has identified the location of all gravesites and established the cemetery boundary as reflected in the Archaeological Reconnaissance prepared by R. S. Webb & Associates, dated July 17, 1997.
  - b. The reestablishment of a fifty foot (50') cemetery preservation buffer and conveying same to Cobb County in the form of a Conservation Easement.
  - c. Relocating the existing six foot (6') high chain-link fence (with the inclusion of a gate) around the perimeter of the cemetery and/or constructing an additional fence so that the positioning of said fence encompasses the cemetery and the fifty foot (50') cemetery preservation buffer.
  - d. The installation of orange protective fence along the outside of the cemetery preservation buffer during any construction on the site.
  - e. With respect to that portion of the cemetery preservation buffer which may have been inadvertently cleared, replacing said buffer in full.
  - f. There is an existing twenty foot (20') easement to the cemetery and a parking easement at the cemetery gate. The cemetery shall remain accessible from dawn to dusk seven (7) days a week from Veterans Memorial Highway and continual access provided by way of key code gate.
  - g. Bankhead shall undertake whatever remedial measures are needful or necessary in order to ensure that the cemetery and its preservation buffer are not subject to erosion and/or stormwater management problems.
  - h. Bankhead shall undertake remedial measures in order to remove any and all dead trees from the cemetery's preservation buffer and to preserve the integrity of the existing fence and any new fencing.
9. The building which will be utilized in connection with the Transfer Station shall consist of an enclosed, Recovered Material Process Facility ("RMF").

**SAMS, LARKIN & HUFF**  
A LIMITED LIABILITY PARTNERSHIP

**VIA E-MAIL AND HAND DELIVERY**

Mr. John P. Pederson, AICP, Manager  
Cobb County Community Development Agency  
January 26, 2012  
Page 4

10. All processing operations of the RMF shall be carried on inside the building, including the delivery of materials and the removal of same for transport.<sup>1</sup>
11. There will be approximately forty-eight (48) truck trips per day to and from the subject property predicated upon the approval of the Applications. Additionally, it is anticipated that employee vehicular trips to and from the subject property will consist of approximately ten (10) trips per day.<sup>2</sup>
12. The hours of operation for the Transfer Station will be from 5:00 a.m. until 6:00 p.m. Monday through Friday and Saturday from 8:00 a.m. until 1:00 p.m. with the business being closed on Sundays.
13. The RMF facility shall be a "clean RMF" meaning that it shall not separate recyclable materials from general garbage and waste and shall accept source-separated recyclable materials.
14. The doors used to allow vehicles to deliver materials shall be closed except when active deliveries are occurring.
15. The RMF shall contain a dust and odor suppression system including overhead misters which will apply water and deodorizer periodically to control dust and odor within the building.
16. The RMF shall contain air dispersion exhaust fans and provide for the manual application of water provided from wash down stations within the building.

---

<sup>1</sup> It is anticipated that the project will transfer 150,000 tons of waste annually.

<sup>2</sup> The route taken for the C & D component is from Veterans Memorial Highway to I-285 South to 85 South in order to access Safeguard C & D Landfill in Fairburn, Georgia. With respect to the MSW component, the routes are either from Veterans Memorial Highway West to Highway 278 towards Rockmart or from Veterans Memorial Highway to Discovery Boulevard to I-20 West then taking the Thornton Road exit towards Rockmart to the Grady Road Landfill.

**SAMS, LARKIN & HUFF**  
A LIMITED LIABILITY PARTNERSHIP

**VIA E-MAIL AND HAND DELIVERY**

Mr. John P. Pederson, AICP, Manager  
Cobb County Community Development Agency  
January 26, 2012  
Page 5

17. Any necessary repairs to the odor control systems shall be made within forty-eight (48) hours or notifications shall be provided to the County if the repairs can not be made within that time frame. In such an event, it will be necessary to obtain a temporary replacement system or secure approval from the Community Development Director for an extension of time in which to perform the necessary repair work.
18. The tipping floor where recyclable materials are dumped shall be washed out at least two (2) times per week or more if deemed necessary.
19. All liquid waste and waste water from inside the building shall be routed to the sanitary sewer with the plan to be approved by Cobb County during the Plan Review process.
20. There shall be no outdoor storage of trash or trucks which have trash in them.
21. The County Arborist shall approve a landscaping plan at Plan Review which will ensure a visual and noise abatement screen. Additionally, an agreement to form a Landscape Advisory Committee consisting of Bankhead, a representative from MIC, a representative from CCCPC and the Director of the Community Development Agency who shall facilitate decisions and be the final arbiter with respect to issues upon which Bankhead, MIC and CCCPC can not agree.

The Landscape Plan which shall be submitted during the Plan Review process shall include the planting of Leland Cypress trees along the northwestern property line from the perimeter of the Turner Sewell Cemetery going southwesterly along said property line and the planting of Leland Cypress trees (to the extent that topography allows for same) along the subject property's southeasterly property line. Said Leland Cypress trees shall consist of a five (5) gallon minimum and will be monitored for three (3) years to ensure adequate growth and health.

The construction of an eight foot (8') privacy fence to be erected along the southeastern side of the property beginning behind the existing office and continuing back to the southeast corner of the subject property. Additionally, the construction of an eight foot (8') privacy fence to be erected along the southwesterly side of the subject property, including the perimeter of the cemetery, which will also encompass the fifty foot (50') cemetery preservation buffer.

**SAMS, LARKIN & HUFF**  
A LIMITED LIABILITY PARTNERSHIP

**VIA E-MAIL AND HAND DELIVERY**

Mr. John P. Pederson, AICP, Manager  
Cobb County Community Development Agency  
January 26, 2012  
Page 6

If, during construction, the dirt mound presently located on the northwest side of the subject property is disturbed, then an eight foot (8') fence shall be erected along with complementary Leland Cypress trees along said fence. Lastly, an eight foot (8') fence shall be constructed along the entire length of the rear property line with complementary Leland Cypress trees.

22. An agreement to designate an on-site project manager during construction and an on-site operational manager/supervisor during the operation of the RMF. The Operations Manager shall be on duty at all times while the facility is open for business.
23. An agreement to incorporate odor control measures such as odor neutralizing spray systems at each door, overhead odor neutralizing misters throughout the buildings and high velocity air dispersion exhaust fans.
24. Manual application of water shall be provided from the wash down stations from inside of the building with water and oil separators also included inside of the building.
25. The subject property shall be kept clear of debris at all times.
26. Bankhead shall be responsible for cleaning up any litter/debris on Veterans Memorial Highway which may inadvertently come off of trucks delivering to the site and this clean-up should occur at a minimum of once per week or more as needed or necessary.
27. Compliance with recommendations from the Cobb County Water System with respect to the availability of water and sewer to the subject property. This will include connecting the development to sewer which is located on an adjacent tract. Additionally, it will require the submission of an application for a revised Industrial Discharge Service Permit.
28. Compliance with recommendations from Stormwater Management Division with respect to hydrology, detention and downstream considerations, including the following:
  - a. The formulation of a Spill Prevention Plan notwithstanding the fact that no hazardous materials are planned for the site.
  - b. A revision to Bankhead's NPDES permit for purposes of discharge.

**SAMS, LARKIN & HUFF**  
A LIMITED LIABILITY PARTNERSHIP

**VIA E-MAIL AND HAND DELIVERY**

Mr. John P. Pederson, AICP, Manager  
Cobb County Community Development Agency  
January 26, 2012  
Page 7

- c. Compliance with MRPA Corridor Regulations.<sup>3</sup>
  - d. The installation of an oil/water separator to treat stormwater as required by Cobb County.
  - e. The installation of curb and gutters on the northeast side of the entrance from Veterans Memorial Highway to the exiting office building. Additionally, the construction of two (2) new lanes on the property for the purposes of ingress and egress for a length of at least fifty feet (50') from the subject property's entrance.
29. Bankhead shall create and maintain a Vector Control Plan on the subject property which shall detail the program for domesticated animal control as well as rodent and insect extermination. An outside exterminating company shall be utilized to exterminate insects and rodents which includes exterminating sprays, poisonous baits and traps. Said service shall be provided on a monthly basis and increased as situations may warrant.
30. Compliance with recommendations of the Cobb County Department of Transportation as follows:
- a. The installation of sidewalk along the subject property's frontage on Veterans Memorial Highway.
  - b. The installation of a one-hundred fifty foot (150') deceleration lane with a fifty foot (50') taper at the subject property's point of ingress/egress on Veterans Memorial Highway.
  - c. Securing approval from the Georgia Department of Transportation with respect to any encroachments or work done within the right-of-way of Veterans Memorial Highway which is a State right-of-way.

---

<sup>3</sup> The preponderance of the subject property is "grandfathered" with respect to impervious surfaces and vulnerability requirements.

**SAMS, LARKIN & HUFF**  
A LIMITED LIABILITY PARTNERSHIP

**VIA E-MAIL AND HAND DELIVERY**

Mr. John P. Pederson, AICP, Manager  
Cobb County Community Development Agency  
January 26, 2012  
Page 8

The subject property is bordered by HI and GC zoned and utilized properties and on the north by Veterans Memorial Highway, a major arterial right-of-way. It is surrounded by all manner of Heavy Industrial uses, including trucking transport facilities, heavy contractors, industrial manufacturers, a crane company and other industrial users. The proposal to add MSW and Recycling components to an existing C & D Transfer Station is consistent with Cobb County's Comprehensive Land Use Plan and Future Land Use Map which reflect that the property is in an Industrial area under the Future Land Use Map. The proposal by Bankhead is entirely appropriate considered in the context of development in which the subject property is situated.

Please do not hesitate to call should you or your staff have any questions or require additional information or documentation prior to the Application being heard and considered for final action by the Board of Commissioners next month. With kind regards, I am

Very truly yours,

SAMS, LARKIN & HUFF, LLP

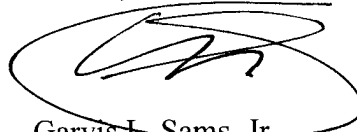

Garvis L. Sams, Jr.  
[gsams@samslarkinhuff.com](mailto:gsams@samslarkinhuff.com)

GLS, Jr./dsj  
Attachment

cc: Members, Cobb County Board of Commissioners (via email & hand delivery w/attachment)  
Mr. Robert L. Hosack, Jr., AICP, Director (via email and hand delivery w/attachment)  
Mr. Dana Johnson, AICP, Manager Planning Division (via email and hand delivery w/attachment)  
Mr. Jason Campbell, Planner II  
Cobb County Community Development Agency (via email and hand delivery w/attachment)  
Mr. Ken Suddreth, Director  
Smyrna Community Development Agency (via email w/attachment)  
Ms. Jane Stricklin, P.E. (via email w/attachment)

**SAMS, LARKIN & HUFF**  
A LIMITED LIABILITY PARTNERSHIP

**VIA E-MAIL AND HAND DELIVERY**

Mr. John P. Pederson, AICP, Manager  
Cobb County Community Development Agency  
January 26, 2012  
Page 9

Mr. David Breaden, P.E. (via email w/attachment)  
Ms. Karen King, Assistant County Clerk (via email w/attachment)  
Ms. Lori Presnell, Deputy County Clerk (via email w/attachment)  
Mr. Ben Clopper, Mableton Improvement Coalition (via email w/attachment)  
Mrs. Helga Hong, CCCPC (via email w/attachment)  
Ms. Robin Meyer, MIC (via email w/attachment)  
Ms. Roberta Cook, RLHA (via email w/attachment)  
Mr. Kenneth J. Wood, P.E., LEED AP  
Planners and Engineers Collaborative, Inc. (via email w/attachment)  
Mr. Terry Nicholson, Bankhead C & D Transfer Station, LLC (via email w/attachment)



Keith Golden, P.E., Commissioner



GEORGIA DEPARTMENT OF TRANSPORTATION

One Georgia Center, 600 West Peachtree Street, NW  
Atlanta, Georgia 30308  
Telephone: (404) 631-1000

Other Business Item 8  
Exhibit C

April 18, 2012

Mr. Karl Von Hagel  
Airport Manager  
Cobb County Airport – McCollum Field  
1723 McCollum Pkwy, Bldg 100  
Kennesaw, GA 30144

Dear Mr. Von Hagel,

We understand Bankhead C & D Transfer Station, LLC has submitted a Statement of Intent to the Cobb County Zoning Division for consideration of expanding the existing Construction and Demolition Transfer Facility to include an enclosed Municipal Solid Waste Transfer Facility. Per the County's request for further review, our evaluation and recommendation follows and is given so as to ensure the safe operation of the airport is not compromised by incompatible land use.

Our analysis shows the existing C&D Transfer Station is located approximately 5,500 linear feet from the threshold of Fulton County Airport's Runway 26. It is also approximately 2,000 feet from the Fulton County Airport's proposed North Terminal Area, which is slated for imminent development.

According to the Federal Aviation Administration's Advisory Circular (AC) 150/5200-33B, "Hazardous Wildlife Attractants on or Near Airports" Section 2-2.d, enclosed waste transfer stations are generally deemed compatible with airports provided they are not on airport property or within the Runway Protection Zone (RPZ). However, Section 2-2.h states "a C&D landfill co-located with another waste disposal operation should be located outside of the separations identified in Sections 1-2 through 1-4." The referenced sections identify a preferred recommendation of a five mile separation between the waste disposal facility and the closest aircraft operating area. However, it also gives consideration to a 10,000 foot separation.

The proposed facility expansion meets the requirements set forth in Section 2-2.d but fails to meet the stipulation stated in Section 2-2.h regarding co-location of facilities. Since the proposal is a request to co-locate an enclosed Municipal Solid Waste Transfer Facility with an existing Construction and Demolition Transfer Facility and does not meet the guidelines set forth by the FAA the Department does not recommend approval of this request.

Cobb County is reviewing a proposal that has the potential if not sited properly to create an adverse safety and liability impact to an airport and airport sponsor (Fulton County) outside of its jurisdiction. Although Cobb County and its airport will not be directly affected by this request, we urge Cobb County to consider the bearing their decision has on the safety and operation of the Fulton County Airport.

While the Department does not recommend approval of this specific location, there are other alternatives that may be considered. A relocation of the co-located facility outside of the 10,000 foot separation area is one option. Please contact Carla Sands, Airport Development Engineer, at (404) 505-4866 if you have any further questions.

Sincerely,

Carol L. Comer, Director  
Division of Intermodal Programs

cc: Hon. Tim Lee, Cobb County  
Doug Barrett, Fulton County Airport Manager  
Scott Seritt, FAA