

“ADDENDUM”
PRELIMINARY ZONING ANALYSIS

Planning Commission Hearing Date: August 7, 2012
Board of Commissioners Hearing Date: August 21, 2012

Due Date: July 6, 2012

Date Distributed/Mailed Out: June 25, 2012



Cobb County... Expect the Best!

Z-32
(2012)

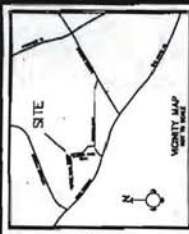

FIELD INFORMATION FOR THIS SURVEY WAS OBTAINED FROM A SURVEY OF RECORDS...
NO INFORMATION FOR THIS SURVEY WAS OBTAINED FROM A SURVEY OF RECORDS...
NO INFORMATION FOR THIS SURVEY WAS OBTAINED FROM A SURVEY OF RECORDS...

REMARKS:
(1) AS-BUILT PLANS, RECORDS, AND SURVEY DATA...
(2) ALL DIMENSIONS ARE IN FEET AND INCHES...
(3) ALL DIMENSIONS ARE IN FEET AND INCHES...

NO PART OF THIS SURVEY WAS OBTAINED FROM A SURVEY OF RECORDS...
NO PART OF THIS SURVEY WAS OBTAINED FROM A SURVEY OF RECORDS...
NO PART OF THIS SURVEY WAS OBTAINED FROM A SURVEY OF RECORDS...

NO PART OF THIS SURVEY WAS OBTAINED FROM A SURVEY OF RECORDS...
NO PART OF THIS SURVEY WAS OBTAINED FROM A SURVEY OF RECORDS...
NO PART OF THIS SURVEY WAS OBTAINED FROM A SURVEY OF RECORDS...

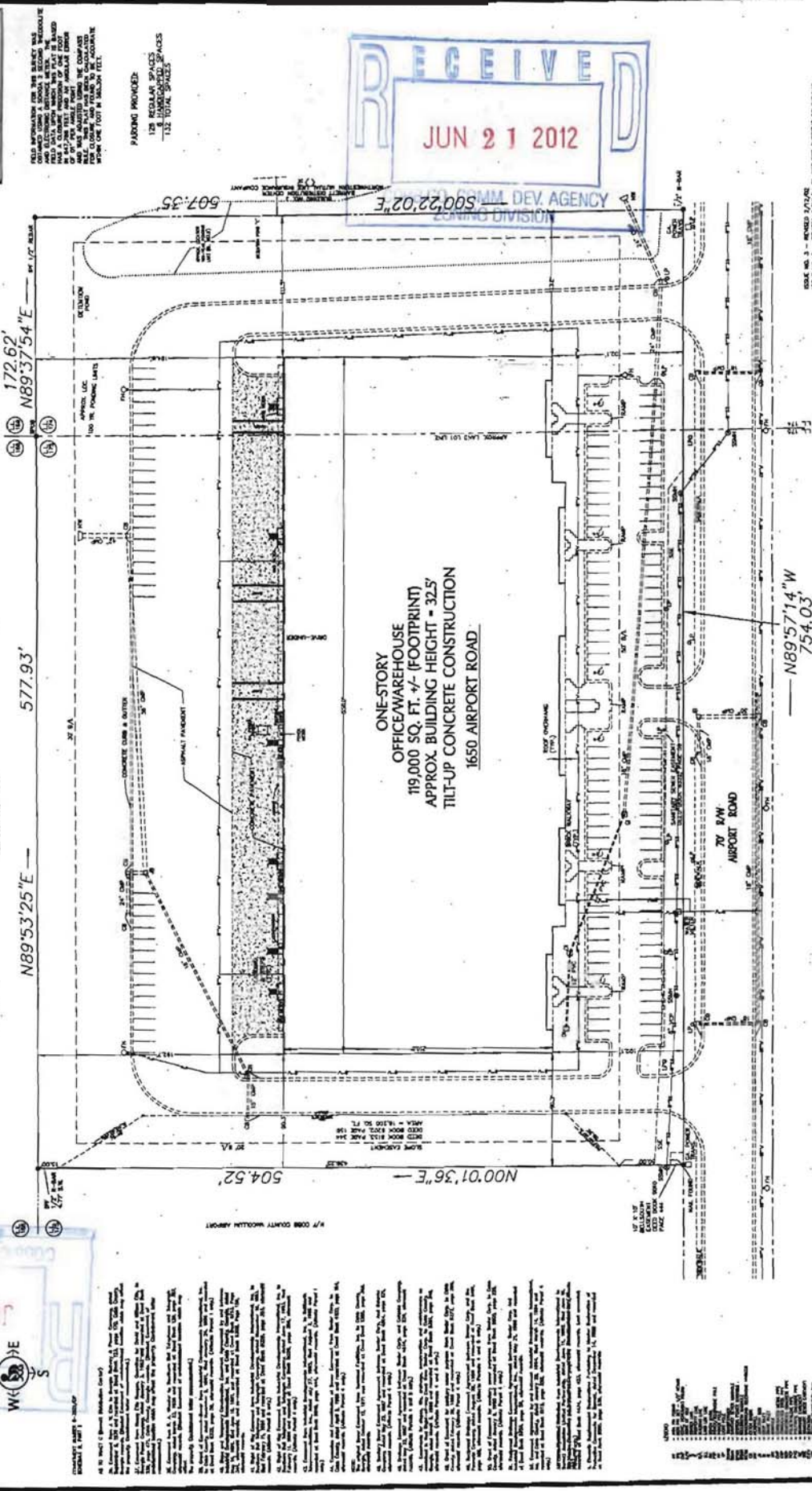

RECEIVED
JUN 21 2012

ONE-STORY
OFFICE/WAREHOUSE
119,000 SQ. FT. +/- (FOOTPRINT)
APPROX. BUILDING HEIGHT = 32.5'
TILT-UP CONCRETE CONSTRUCTION
1650 AIRPORT ROAD

ALTA/ACSM LAND TITLE SURVEY
BARRETT TITLE ASSURANCE COMPANY
BARRETT DISTRIBUTION CENTER
1650 AIRPORT ROAD
DALLAS, TEXAS 75243
COUNTY: DALLAS
SECTION: 2003, LAND DISTRICT: 888, F
DATE: 06/21/12

NO PART OF THIS SURVEY WAS OBTAINED FROM A SURVEY OF RECORDS...
NO PART OF THIS SURVEY WAS OBTAINED FROM A SURVEY OF RECORDS...
NO PART OF THIS SURVEY WAS OBTAINED FROM A SURVEY OF RECORDS...

NO PART OF THIS SURVEY WAS OBTAINED FROM A SURVEY OF RECORDS...
NO PART OF THIS SURVEY WAS OBTAINED FROM A SURVEY OF RECORDS...
NO PART OF THIS SURVEY WAS OBTAINED FROM A SURVEY OF RECORDS...

NO PART OF THIS SURVEY WAS OBTAINED FROM A SURVEY OF RECORDS...
NO PART OF THIS SURVEY WAS OBTAINED FROM A SURVEY OF RECORDS...
NO PART OF THIS SURVEY WAS OBTAINED FROM A SURVEY OF RECORDS...

NO PART OF THIS SURVEY WAS OBTAINED FROM A SURVEY OF RECORDS...
NO PART OF THIS SURVEY WAS OBTAINED FROM A SURVEY OF RECORDS...
NO PART OF THIS SURVEY WAS OBTAINED FROM A SURVEY OF RECORDS...

NO PART OF THIS SURVEY WAS OBTAINED FROM A SURVEY OF RECORDS...
NO PART OF THIS SURVEY WAS OBTAINED FROM A SURVEY OF RECORDS...
NO PART OF THIS SURVEY WAS OBTAINED FROM A SURVEY OF RECORDS...

NO PART OF THIS SURVEY WAS OBTAINED FROM A SURVEY OF RECORDS...
NO PART OF THIS SURVEY WAS OBTAINED FROM A SURVEY OF RECORDS...
NO PART OF THIS SURVEY WAS OBTAINED FROM A SURVEY OF RECORDS...

NO PART OF THIS SURVEY WAS OBTAINED FROM A SURVEY OF RECORDS...
NO PART OF THIS SURVEY WAS OBTAINED FROM A SURVEY OF RECORDS...
NO PART OF THIS SURVEY WAS OBTAINED FROM A SURVEY OF RECORDS...

APPLICANT: Maria L. VanVurst
(678) 283-2038

REPRESENTATIVE: Same

TITLEHOLDER: LIT/Hodges Industrial Trust

PROPERTY LOCATION: North side of Airport Road, east of Old 41 Highway
(1650 Airport Road #104)

ACCESS TO PROPERTY: Airport Road

PHYSICAL CHARACTERISTICS TO SITE: _____

CONTIGUOUS ZONING/DEVELOPMENT

PETITION NO: Z-32

HEARING DATE (PC): 08-07-12

HEARING DATE (BOC): 08-21-12

PRESENT ZONING: LI

PROPOSED ZONING: CRC

PROPOSED USE: Indoor Trampoline Park

SIZE OF TRACT: 8.73 ac

DISTRICT: 20

LAND LOT(S): 174,175

PARCEL(S): 34

TAXES: PAID X **DUE** _____

COMMISSION DISTRICT: 1

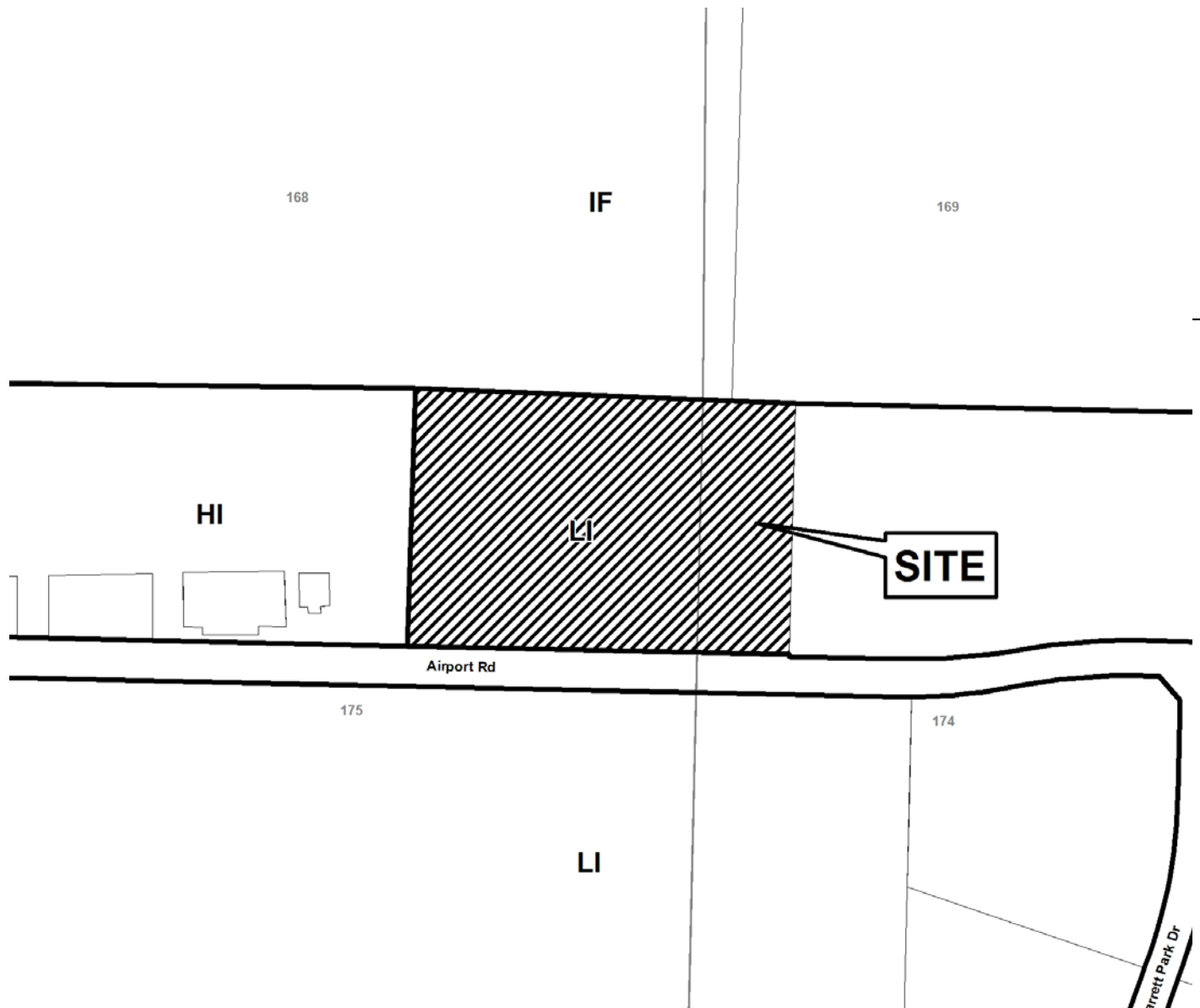



Application No. 2-32

Aug. 2012

Summary of Intent for Rezoning

.....
Part 1. Residential Rezoning Information (attach additional information if needed)

- a) Proposed unit square-footage(s): _____
- b) Proposed building architecture: _____
- c) Proposed selling prices(s): _____
- d) List all requested variances: _____

.....
Part 2. Non-residential Rezoning Information (attach additional information if needed)

- a) Proposed use(s): Sky Zone Indoor Trampoline Park
- b) Proposed building architecture: Industrial Warehouse with Light office space
- c) Proposed hours/days of operation: Tues-Thurs 3-8, Friday 12-11, Sat 10-12, Sun 12-7
Summer: Mon 10-8, Tues-Thurs 10-10, Fri 10-11, Sat 10-12, Sun 12-7
- d) List all requested variances: _____
LI to CRC

.....
Part 3. Other Pertinent Information (List or attach additional information if needed)

None

.....
Part 4. Is any of the property included on the proposed site plan owned by the Local, State, or Federal Government?

(Please list all Right-of-Ways, Government owned lots, County owned parcels and/or remnants, etc., and attach a plat clearly showing where these properties are located). no

