

SLUP-1(2013)
WITHDRAWN
WITHOUT
PREJUDICE



PLANNERS AND ENGINEERS COLLABORATIVE
WE PROVIDE SOLUTIONS
LANDSCAPE ARCHITECTURE & CIVIL ENGINEERING & LAND SURVEYING
555 RESEARCH COURT #1000 CHICO, GEORGIA 30924 (706) 871-2711 FAX (706) 871-1100 WWW.PEACOLLAB.COM

Riverview Landing - School Phase II

SLUP SITE PLAN

SCALE: 1" = 40' (AS SHOWN)
DATE: 1/28/13
PROJECT: RIVERVIEW LANDING - SCHOOL PHASE II

PLANNERS AND ENGINEERS COLLABORATIVE
555 RESEARCH COURT #1000 CHICO, GEORGIA 30924
(706) 871-2711 FAX (706) 871-1100 WWW.PEACOLLAB.COM

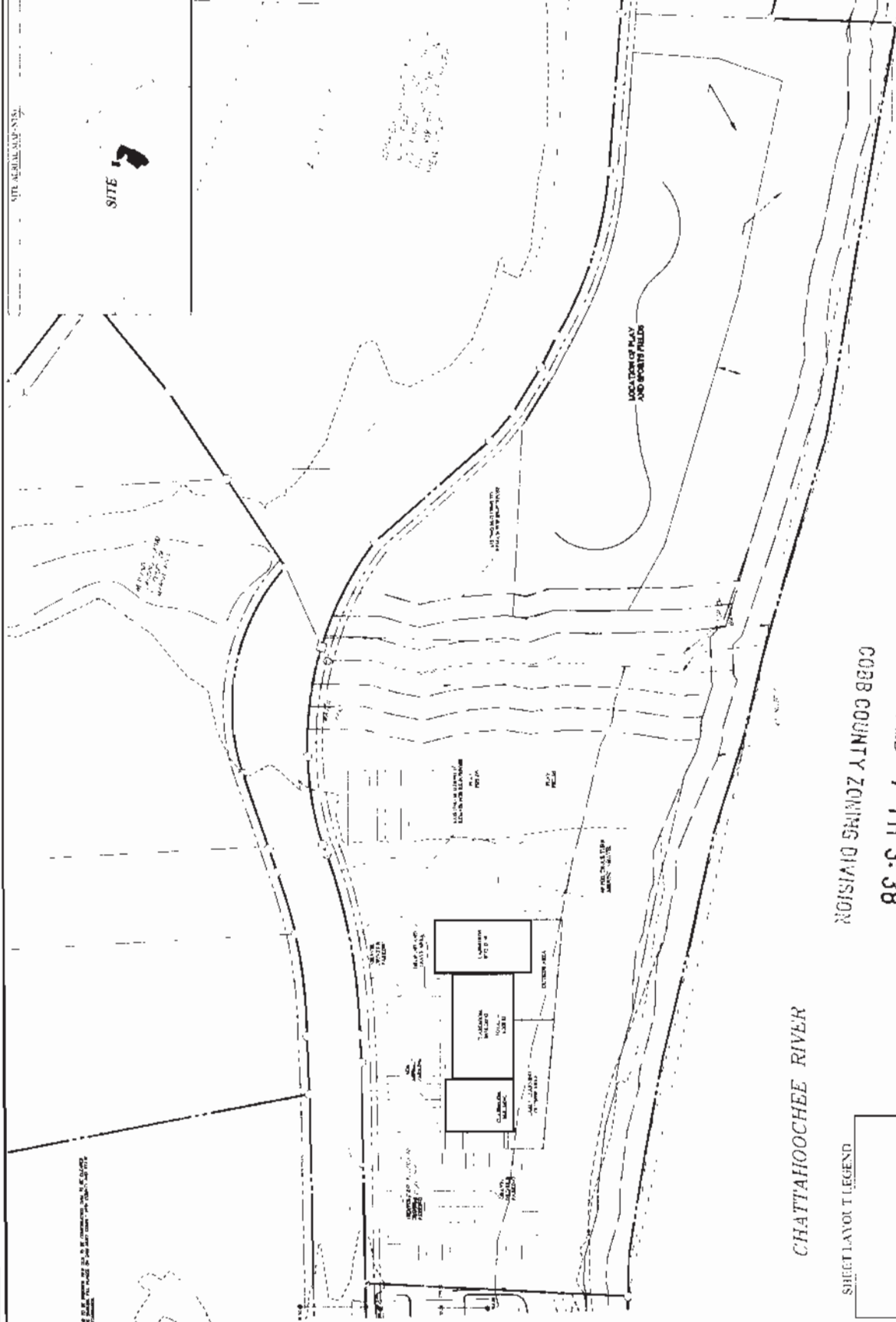
24 HOUR CONTACT.
MR. WALLER BROWN at 404-835-8223



COBB COUNTY GEORGIA
2013 FEB - 7 PM 3: 38
COBB COUNTY ZONING DIVISION

CHATTAHOOCHEE RIVER

SHEET LAYOUT LEGEND



SITE DATA

DATE: 1/28/13
DRAWN BY: W. J. BROWN
CHECKED BY: W. J. BROWN
SCALE: 1" = 40'

APPLICANT: The SAE School
(678) 270-8767

REPRESENTATIVE: Garvis L. Sams, Jr. (770) 422-7016
Sams, Larkin & Huff, LLP

TITLEHOLDER: Riverview Industries, L.P.

PROPERTY LOCATION: Southeasterly side of River View Road, at
its intersection with Dickerson Drive

ACCESS TO PROPERTY: River View Road

PHYSICAL CHARACTERISTICS TO SITE: _____

CONTIGUOUS ZONING/DEVELOPMENT

NORTH:
SOUTH:
EAST:
WEST:

PETITION NO: SLUP-1

HEARING DATE (PC): 04-02-13

HEARING DATE (BOC): 04-16-13

PRESENT ZONING: PVC

PROPOSED ZONING: Special Land
Use Permit

PROPOSED USE: Private School
(Pre-K through Eighth Grade)

SIZE OF TRACT: 12.526 acres

DISTRICT: 18

LAND LOT(S): 172

PARCEL(S): 5, 6, 7, 14, 15, 21, 22, 23

TAXES: PAID X DUE _____

COMMISSION DISTRICT: 4

**WITHDRAWN
WITHOUT PREJUDICE**

OPPOSITION: NO. OPPOSED _____ PETITION NO: _____ SPOKESMAN _____

PLANNING COMMISSION RECOMMENDATION

APPROVED _____ MOTION BY _____
REJECTED _____ SECONDED _____
HELD _____ CARRIED _____

BOARD OF COMMISSIONERS DECISION

APPROVED _____ MOTION BY _____
REJECTED _____ SECONDED _____
HELD _____ CARRIED _____

STIPULATIONS:

