

BANKHEAD TRANSFER STATION
 AN EXISTING INDUSTRIAL TRANSFER STATION

BANKHEAD TRANSFER STATION, L.L.C.
 1400 VETERANS MEMORIAL HIGHWAY
 MABLETON, GEORGIA 30126
 PHONE: 678-296-1888

WE PROVIDE SOLUTIONS™
PLANNERS AND ENGINEERS COLLABORATIVE
 PLANNING & LANDSCAPE ARCHITECTURE & CIVIL ENGINEERING & LAND SURVEYING
 RESEARCH COURT • NORCROSS, GEORGIA 30063 • (770) 451-2444 FAX: (770) 451-2885 • WWW/WELC.COM

**SLUP-10
(2011)**

NO.	DATE	BY	REVISION

SLUP PLAN

SCALE: 1" = 80'
 DATE: SEPTEMBER 1, 2011
 PROJECT: 11107.00

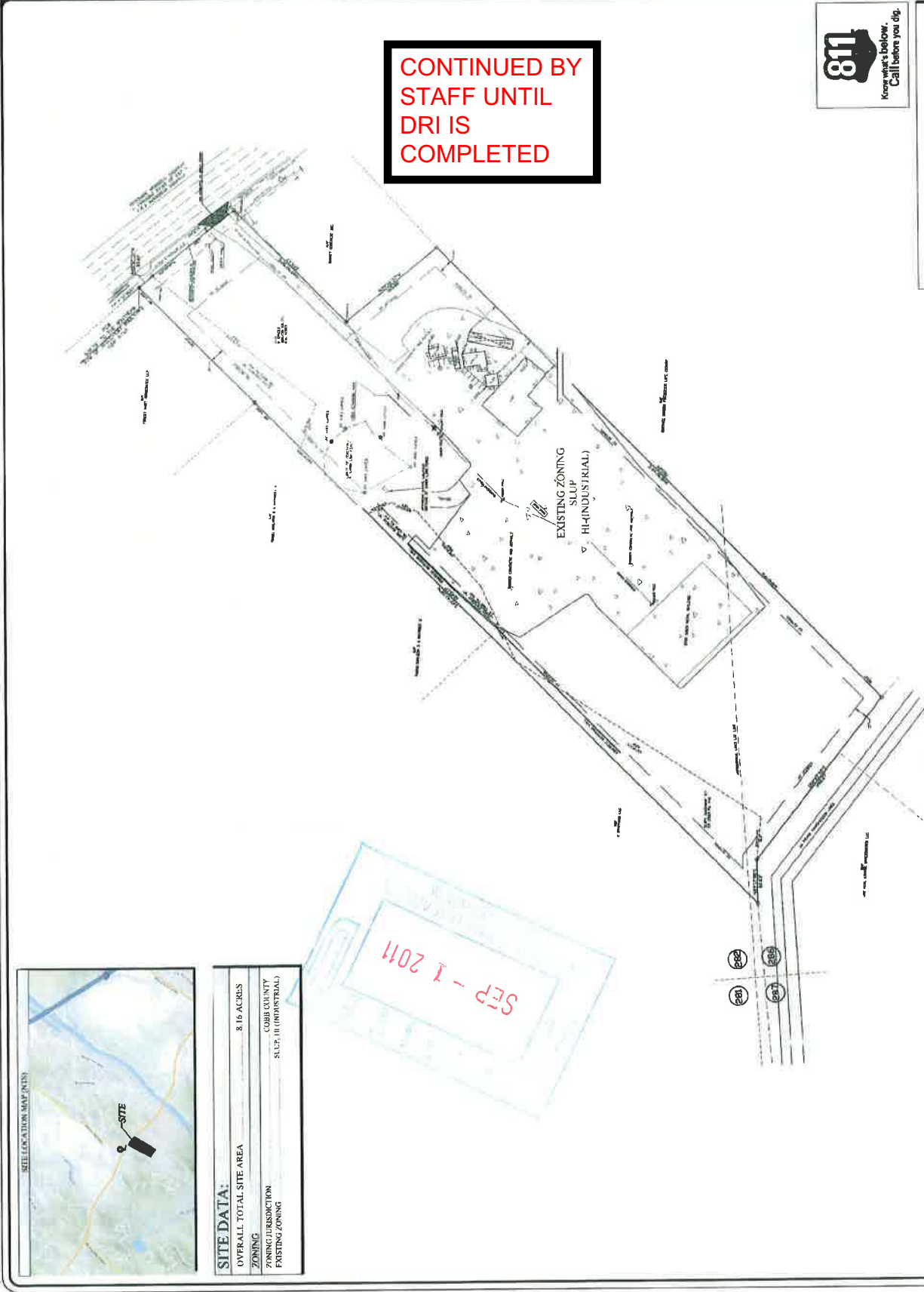

**CONTINUED BY
STAFF UNTIL
DRI IS
COMPLETED**



SITE DATA:

OVERALL TOTAL SITE AREA	8.16 ACRES
ZONING	CORB COUNTY
ZONING JURISDICTION	SLUP, HI (INDUSTRIAL)
EXISTING ZONING	



24 HOUR CONTACT:
TERRY NICHOLSON @ 678-296-1888

APPLICANT: Bankhead C & D Transfer Station, LLC

(678) 296-1888

REPRESENTATIVE: Garvis L. Sams, Jr. (770) 422-7016

Sams, Larkin & Huff, LLP

TITLEHOLDER: Bankhead C & D Transfer Station, LLC

PROPERTY LOCATION: On the southwest side of Veterans Memorial Highway, east of Discovery Boulevard

ACCESS TO PROPERTY: Veterans Memorial Highway

PHYSICAL CHARACTERISTICS TO SITE: Existing transfer station

PETITION NO: SLUP-10

HEARING DATE (PC): 11-01-2011

HEARING DATE (BOC): 11-15-2011

PRESENT ZONING: GC & HI

PROPOSED ZONING: Special Land Use Permit

PROPOSED USE: Expanding Existing Transfer Station

SIZE OF TRACT: 8.16 acres

DISTRICT: 18

LAND LOT(S): 282, 286

PARCEL(S): 8

TAXES: PAID X **DUE** _____

COMMISSION DISTRICT: 4

CONTIGUOUS ZONING/DEVELOPMENT

NORTH: CRC Developed Retail Center and HI/Undeveloped

SOUTH: HI/Developed Industrial Uses

EAST: HI/Developed Industrial Uses

WEST: CRC Developed Retail Center and HI/Undeveloped and Developed Industrial Uses

****CONTINUED BY STAFF UNTIL DRI IS COMPLETED****

OPPOSITION: NO. OPPOSED _____ **PETITION NO:** _____ **SPOKESMAN** _____

PLANNING COMMISSION RECOMMENDATION

APPROVED _____ **MOTION BY** _____

REJECTED _____ **SECONDED** _____

HELD _____ **CARRIED** _____

BOARD OF COMMISSIONERS DECISION

APPROVED _____ **MOTION BY** _____

REJECTED _____ **SECONDED** _____

HELD _____ **CARRIED** _____

STIPULATIONS:

