

AGENDA ITEM NO. 4

TO: Board of Commissioners

FROM: Rob Hosack
Director

DATE: October 18, 2011

PURPOSE

To conduct a public hearing to consider approval of a Chattahoochee Corridor Plan Certificate of Compliance for Samuel L. Jackson for construction of a single family residence at 3210 Farmington Drive in Land Lots 970 of the 17th District.

BACKGROUND

The subject property was submitted to the Atlanta Regional Commission for review and comment on the development as mandated by the Georgia Assembly Act No. 66, the Metropolitan River Protection Act of 1973. The basic process of certification under the Act requires that local governments review land-disturbing activity proposed in the Chattahoochee Corridor and certify those, which are consistent with the guidelines for development in the Atlanta Regional Commission's *Chattahoochee Corridor Plan*. The Atlanta Regional Commission staff has completed a preliminary review and found the development plans to be consistent with the guidelines of the *Chattahoochee Corridor Plan*.

FUNDING

Not Applicable.

RECOMMENDATION

The Board of Commissioners conducts a public hearing and considers approval of the Chattahoochee Corridor Certificate, subject to the rules and guidelines of the Metropolitan River Protection Act and all applicable Cobb County development standards and regulations.

ATTACHMENT

Site Map
Site Plan
ARC Finding



3210 Farmington Drive

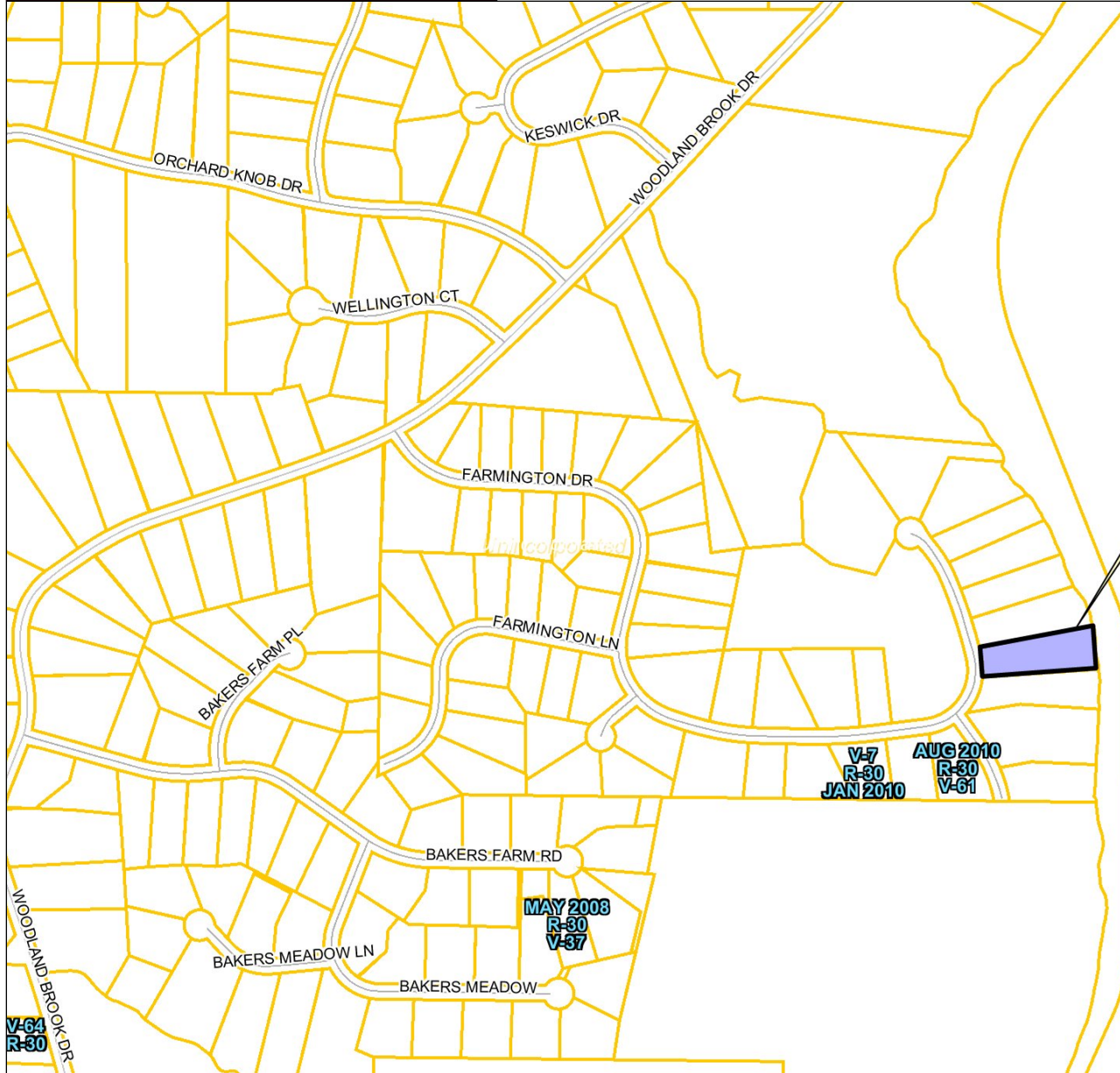

Map center: 33° 50' 59.4" N, 84° 27' 42.7" W

This map is a user generated static output from an Internet mapping site and is for general reference only. Data layers that appear on this map may or may not be accurate, current, or otherwise reliable. THIS MAP IS NOT TO BE USED FOR NAVIGATION.

Notes: October 18, 2011
Chattahoochee Corridor Certificate of Compliance



Scale: 1:6,535

OWNER CONTACT:
SAMUEL L. JACKSON
3210 FARMINGTON DRIVE
ATLANTA, GEORGIA 30339

ARCHITECT CONTACT:
JOHN F. RUBEL
3240 LARAMIE DRIVE
ATLANTA, GEORGIA 30339
PHONE: (770) 316-1493

ENGINEER CONTACT:
REX BRAY
PLANNERS & ENGINEERS
COLLABORATIVE
350 RESEARCH COURT
NORCROSS, GEORGIA 30092
PHONE: (678) 684-6209

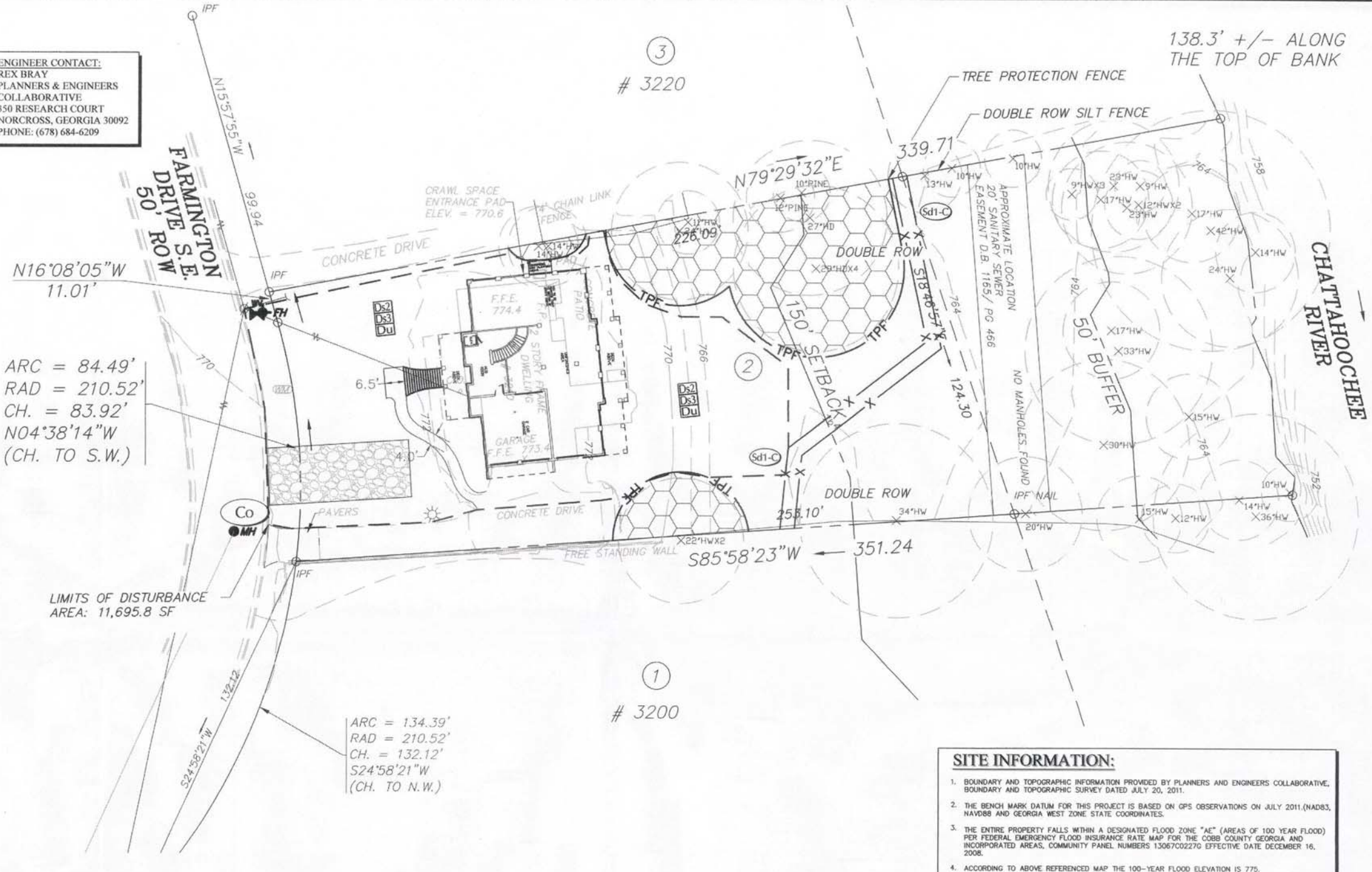
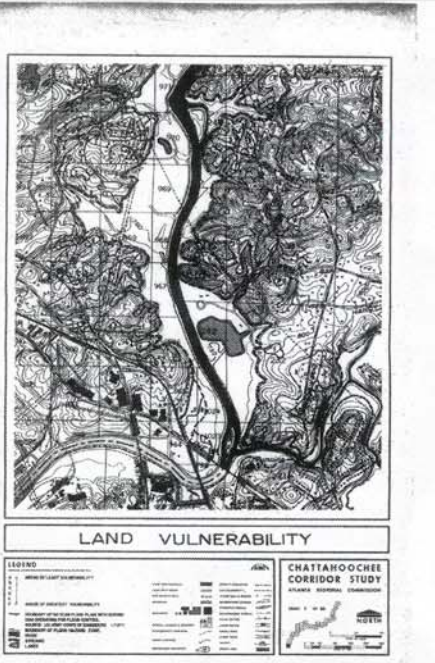

- SITE INFORMATION:**
- BOUNDARY AND TOPOGRAPHIC INFORMATION PROVIDED BY PLANNERS AND ENGINEERS COLLABORATIVE, BOUNDARY AND TOPOGRAPHIC SURVEY DATED JULY 20, 2011.
 - THE BENCH MARK DATUM FOR THIS PROJECT IS BASED ON GPS OBSERVATIONS ON JULY 2011 (NAD83, NAVD88 AND GEORGIA WEST ZONE STATE COORDINATES).
 - THE ENTIRE PROPERTY FALLS WITHIN A DESIGNATED FLOOD ZONE "AE" (AREAS OF 100 YEAR FLOOD) PER FEDERAL EMERGENCY FLOOD INSURANCE RATE MAP FOR THE COBB COUNTY GEORGIA AND INCORPORATED AREAS, COMMUNITY PANEL NUMBERS 13067C02270 EFFECTIVE DATE DECEMBER 16, 2008.
 - ACCORDING TO ABOVE REFERENCED MAP THE 100-YEAR FLOOD ELEVATION IS 775.

- SITE DATA:**
- SITE AREA: ± 0.895 ACRES (ENTIRE LOT IN ARC CORRIDOR)
 - ZONING USE: SINGLE FAMILY RESIDENTIAL
 - PARCEL ID #: 17097000070

- ARC DATA:**
- ENTIRE LOT IN VULNERABILITY AREA "E"
 - TOTAL LOT AREA: 0.895 ACRES 38,986 SF
 - EXISTING AS BUILT IMPERVIOUS AREA 4883.2 SF
 - ALLOWED IMPERVIOUS AREA: 15% X 38,986 SF= 5847.9 SF
 - PROPOSED IMPERVIOUS AREA 5847.5 SF*
 - ALLOWED AREA OF DISTURBANCE: 30% X 38,986 SF= 11,695.8 SF
 - PROPOSED AREA OF DISTURBANCE 11,695.8 SF
- *INCLUDES THE EXISTING DRIVEWAY

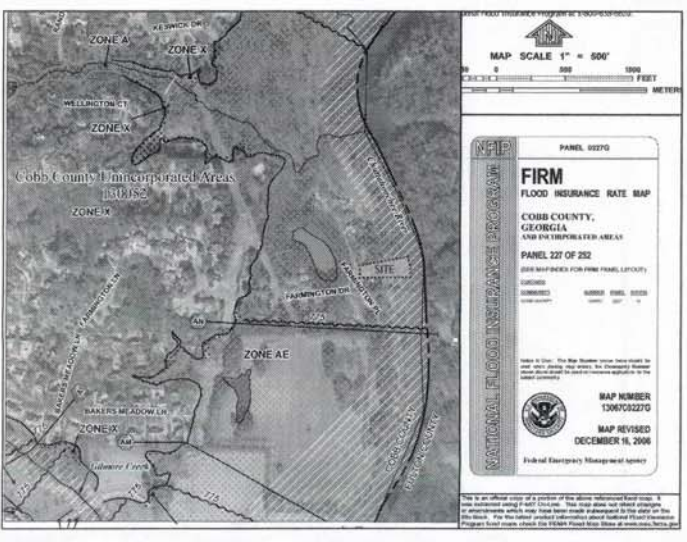
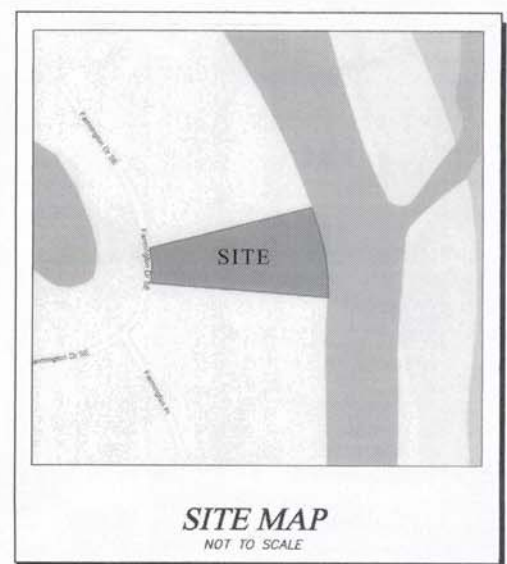

PLANNERS AND ENGINEERS COLLABORATIVE
SITE PLANNING | LANDSCAPE ARCHITECTURE | CIVIL ENGINEERING | LAND SURVEYING
350 RESEARCH COURT - NORCROSS, GEORGIA 30092 | (770) 451-2741 | FAX: (770) 451-3915 | WWW.PEACATL.COM

FOR SAMUEL L. JACKSON
3210 FARMINGTON DRIVE
ATLANTA, GEORGIA 30339
PHONE: 404-408-5122

THE PROVIDE SOLUTIONS™

REVISIONS:

NO.	DATE	BY	DESCRIPTION
-1	7-28-11	RKB	COUNTY COMMENT

This drawing is the property of Planners and Engineers Collaborative and is not to be copied in whole or in part. It is not to be used on any other project and is to be returned upon request. © Planners and Engineers Collaborative

SHEET TITLE
ARC STUDY PLAN

SCALE: 1" = 20'
DATE: JULY 19, 2011
PROJECT: 11088.00

THIS SEAL IS ONLY VALID IF COUNTER SIGNED AND DATED WITH AN ORIGINAL SIGNATURE.

7-28-2011

1 SHEET



REGIONAL REVIEW NOTIFICATION

Atlanta Regional Commission • 40 Courtland Street NE, Atlanta, Georgia 30303 • ph: 404.463.3100 • fax:404.463.3105 • www.atlantaregional.com

DATE: Aug 17 2011

ARC REVIEW CODE: V1108171

TO: Chairman Tim Lee
 ATTN TO: David Breden, Cobb County
 FROM: I. Emerson Bryan, Interim Executive Director *IEB*

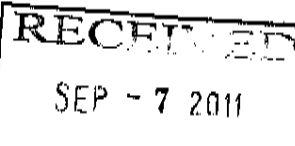

The Atlanta Regional Commission (ARC) has received the following proposal and is initiating a regional review to seek comments from potentially impacted jurisdictions and agencies. The ARC requests your comments related to the proposal not addressed by the Commission's regional plans and policies.

Name of Proposal: RC-11-02CB 3210 Farmington Drive

Review Type: Metro River

MRPA Code: RC-11-02CB

Description: An application for a Metropolitan River Protection Act Certificate for the construction of a single family home.

Preliminary Finding: The ARC staff has completed the review of the application for a Metro River Certificate for this proposed project in the Chattahoochee River Corridor. Our preliminary finding is that the proposed project is consistent with the Chattahoochee Corridor Plan.

Submitting Local Government: Cobb County

Land Lot: 970 District: 17

Date Opened: Aug 17 2011

Deadline for Comments: Aug 27 2011

Earliest the Regional Review can be Completed: Aug 27 2011

THE FOLLOWING LOCAL GOVERNMENTS AND AGENCIES ARE RECEIVING NOTICE OF THIS REVIEW:

ARC LAND USE PLANNING
 NATIONAL PARK SERVICE
 CITY OF SMYRNA

ARC ENVIRONMENTAL PLANNING
 GEORGIA DEPARTMENT OF NATURAL RESOURCES

UPPER CHATTAHOOCHEE RIVERKEEPER
 CITY OF ATLANTA

If you have any questions regarding this review, Please call Jon Tuley at (404) 463-3309. If the ARC staff does not receive comments from you by 2011-08-27, we will assume that your agency has no additional comments and we will close the review. Comments by email are strongly encouraged.

The ARC review website is located at: <http://www.atlantaregional.com/landuse>.

Attached is information concerning this review.