

Application for "Other Business" Cobb County, Georgia

APR 13 2010

(Cobb County Zoning Division - 770-528-2045)

BOC Hearing Date Requested: 05-18-10

Applicant: Integral Development LLC Phone #: 404.391
(applicant's name printed) 9909

Address: 60 Piedmont Avenue, NE E-Mail: _____

Daryl Jones Address: 60 Piedmont Avenue, NE, Atlanta, GA 30303
(representative's name printed)

[Signature] Phone #: 404-224-1883 E-Mail: djones@integral-online.com
(representative's signature)



Signed, sealed and delivered in presence of:

Yashika ABAKAH
Notary Public
FULTON COUNTY
My Comm. Exp. October 18, 2013
Notary Public

Titleholder(s): COBB INTERNATIONAL PROPERTIES LLC Phone #: 678-758-4677
(property owner's name printed)

Address: 10 ROCKY HILL WAY, Covington, GA 30014 E-Mail: will_sanders@Comcast.net

Will H. Sanders
(Property owner's signature)

Signed, sealed and delivered in presence of:

Jack Scott Odu My commission expires: My Commission Expires November 20, 2010
Notary Public

Commission District: 1 **Zoning Case:** Z-41

Date of Zoning Decision: 9-16-08 **Original Date of Hearing:** 9-16-08

Location: Saine Drive, Sandtown Road and Austell Road
(street address, if applicable; nearest intersection, etc.)

Land Lot(s): 0208 **District(s):** 17

State specifically the need or reason(s) for Other Business: _____

Amend Site Plan for RSL Zoning Designation.

(List or attach additional information if needed)

NO.	
1	
2	
3	
4	
5	
6	
7	
8	
9	
10	
11	
12	
13	
14	
15	
16	
17	
18	
19	
20	

THE DRAWING IS THE PROPERTY OF THE ENGINEER AND MAY BE REPRODUCED OR TRANSMITTED IN ANY FORM OR BY ANY MEANS WITHOUT THE WRITTEN PERMISSION OF THE ENGINEER.



Associates, Inc.
 100 Peachtree Ave., 13th Floor
 Atlanta, GA 30309
 404-251-1800

PROPOSED SITE PLAN
 INTERNAL DEVELOPMENT
 60 PEACHTREE AVE., 13TH FLOOR
 ATLANTA, GA 30309
 404-251-1800

DATE PLOTTED	04/13/2010
CHECKED BY	
DRAWN BY	
SCALE	1" = 30'
DATE	03/11/10
PROJECT NO.	1001000073
CLIENT	COLONY SENIOR HOMES
DATE	03/11/10
SHEET NO.	1
TOTAL SHEETS	1

SITE DATA

TOTAL SITE AREA -	5.611 AC
PHASE I	
SITE AREA	1.637 AC.
ZONING	RSL
NO. OF UNITS	70
BUILDING S.F.	77,000 S.F.
FAR	1.08
PARKING	35 CARS (0.50/D.U.)
PHASE II	
SITE AREA	3.974 AC.
ZONING	RSL
NO. OF UNITS	152
BUILDING S.F.	161,200 S.F.
FAR	0.92
PARKING	107 CARS (0.7/D.U.)
SETBACKS	
AUSTELL RD.	20'
SANDTOWN RD.	20'
SAINNE DR.	20'
RM ZONING	40'
ALL OTHERS	10'

APR 13 2010
 COLONY SENIOR HOMES
 700 SANDTOWN RD.

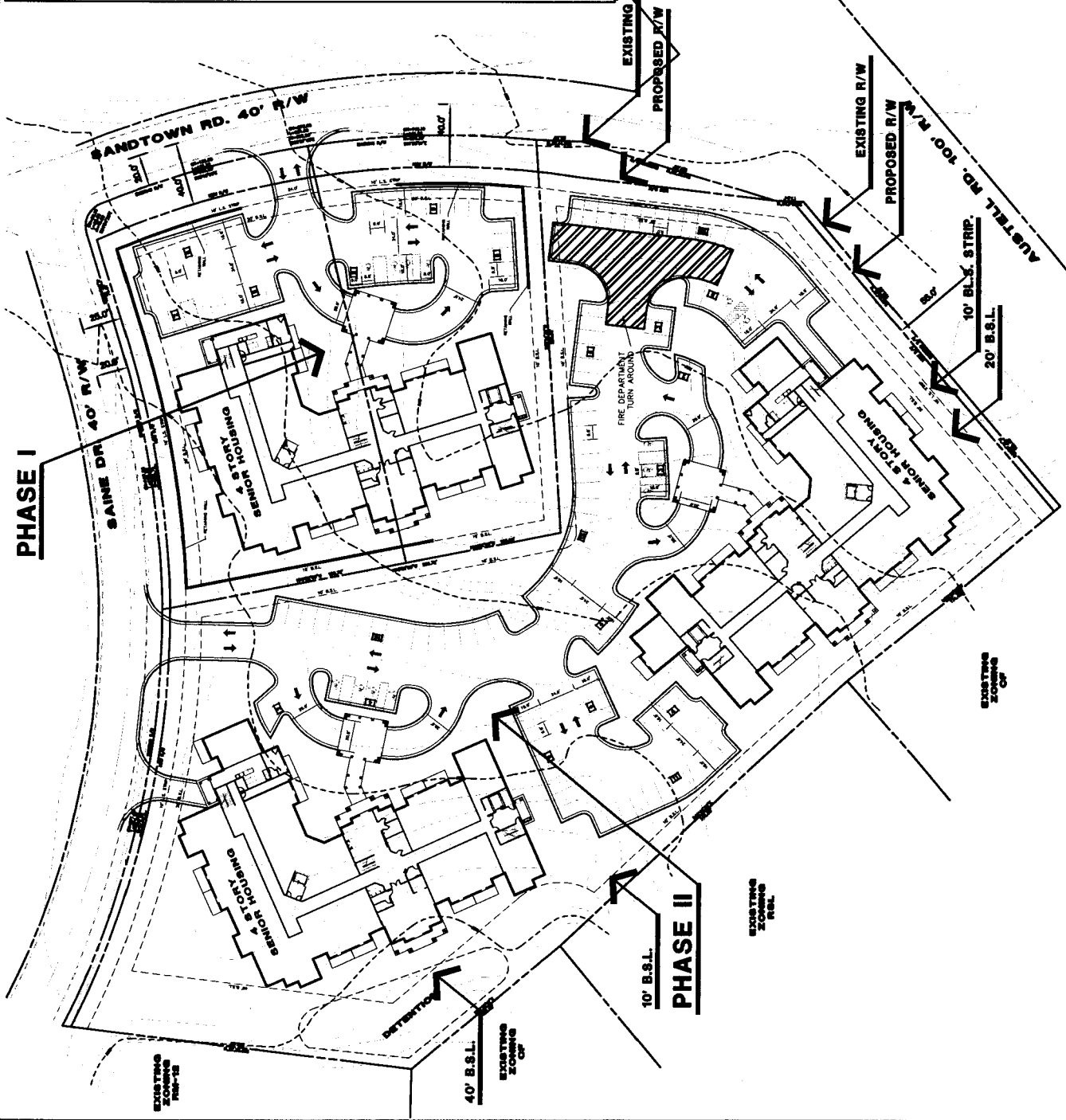
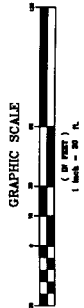

PHASE I

PHASE II

EXISTING ZONING RM-18

EXISTING ZONING CP

EXISTING ZONING RM-18

EXISTING ZONING CP