

BRANCH PROPERTIES, LLC
 1546 PEACOCKE ROAD, NE
 SUITE 2050
 ATLANTA, GEORGIA 30328
 OFFICE: 404-832-8900
 WWW.HIGHLANDENGINEERING.COM
 HIGHLAND ENGINEERING, INC.
 1546 PEACOCKE ROAD, NE
 SUITE 2050
 ATLANTA, GEORGIA 30328
 OFFICE: 404-832-8900
 WWW.HIGHLANDENGINEERING.COM

ZONING PLAN
 BUCKNER ROAD
 COBB COUNTY, GEORGIA
 LAND LOTS 88 & 185 - 18th DISTRICT - 2nd SECTION

Z-13
 Revision

NOTE:
 TOTAL SITE = 4.228 ACRES
 BM ELEVATION = 874.87, CITY/STATE BOLT ON FIRE HYDRANT

VERONIC W. HANDESON
 DB: 11177 P. 83
 ZONED R-20

VERONIC W. HANDESON
 DB: 11416 P. 5240
 ZONED R-20

VERONIC W. HANDESON
 DB: 11177 P. 83
 ZONED R-20

VERONIC W. HANDESON
 DB: 11416 P. 5240
 ZONED R-20

WITHDRAWN WITHOUT PREJUDICE

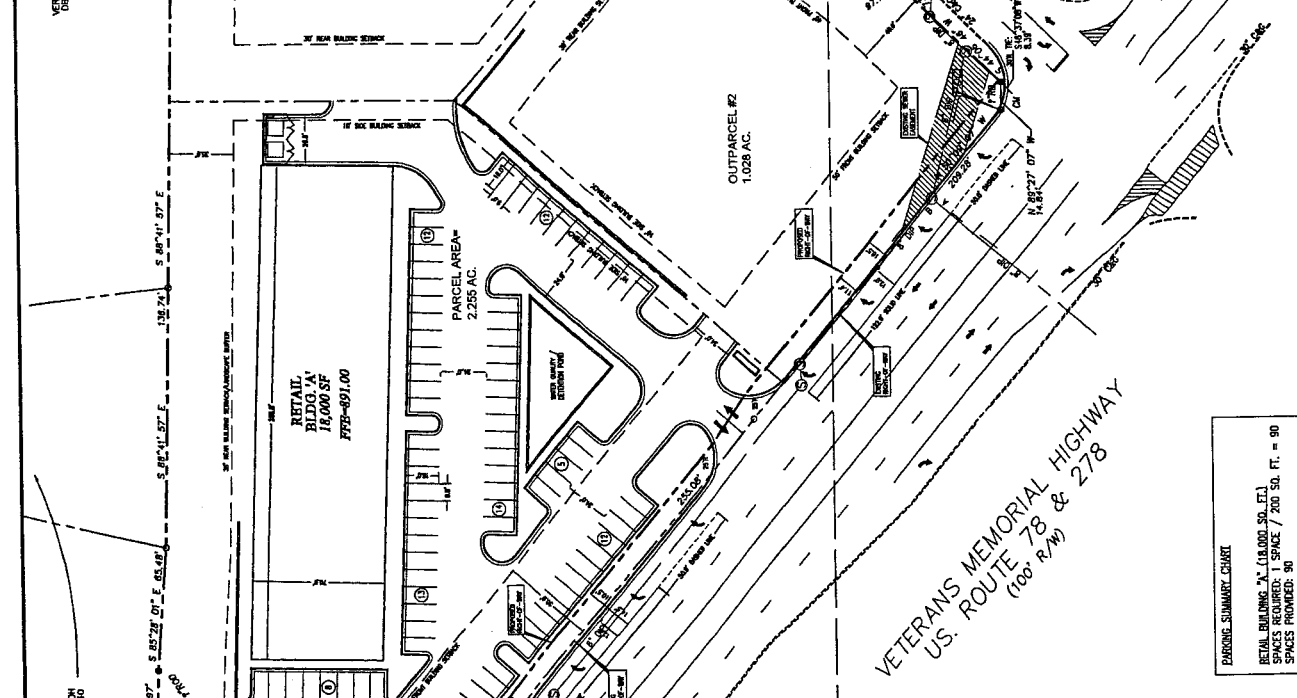

PARCEL AREA #1
 0.843 AC.

PARCEL AREA #2
 2.255 AC.

OUTPARCEL #2
 1.028 AC.

RETAIL
 18,000 SF
 FFPS-091.00

VETERANS MEMORIAL HIGHWAY
 US. ROUTE 78 & 278
 (100' R/W)

GRAPHIC SCALE
 1 inch = 30 ft.

NORTH

NO PROUDRY

BEFORE YOU USE GEORGIA...
 1-800-282-7411
 770-832-2222
 UNITED NORTHERN CORP.
 IT'S THE WAY.

CAUTION
 THE PLANT & SOME OTHER...
 CONTRACTOR'S RESPONSIBILITY TO...
 BY THE...

PAVING SUMMARY SHEET
 RETAIL BUILDING "X" (18,000 SQ. FT.)
 SPACES REQUIRED: 1 SPACE / 200 SQ. FT. = 90
 SPACES PROVIDED: 90

LOCATION MAP
 N.T.S.

FLOOD MAP
 1" = 1000'
 PROPERTY LOTS ARE IN THE COLOR CODE AS PER STATE RULE.
 (UNDESIGNED)

APPLICANT: Branch Development Services, LLC
404-832-8936

PETITION NO: Z-13

REPRESENTATIVE: Moore Ingram Johnson & Steele, LLP
John H. Moore 770-429-1499

HEARING DATE (PC): 03-04-08

HEARING DATE (BOC): 03-18-08

TITLEHOLDER: Arthur Andrew Schulte and William E. Gillan

PRESENT ZONING: R-20, NRC, GC

PROPERTY LOCATION: Located at the northwestern intersection
of Veterans Memorial Highway and Buckner Road.

PROPOSED ZONING: NRC

ACCESS TO PROPERTY: Veterans Memorial Highway and
Buckner Road

PROPOSED USE: Retail

PHYSICAL CHARACTERISTICS TO SITE: Vacant lots

SIZE OF TRACT: 4.228 acres

DISTRICT: 18

LAND LOT(S): 68, 165

PARCEL(S): 8, 2, 4

TAXES: PAID X DUE _____

COMMISSION DISTRICT: 4

CONTIGUOUS ZONING/DEVELOPMENT

WITHDRAWN WITHOUT PREJUDICE

- NORTH: NRC, RM-8/ wooded
- SOUTH: GC/ wooded, McDonalds, Starbucks
- EAST: R-20, GC/ Single-family house, Walgreens
- WEST: OI, NRC/ Graphic Communication Union, undeveloped

OPPOSITION: NO. OPPOSED _____ PETITION NO: _____ SPOKESMAN _____

PLANNING COMMISSION RECOMMENDATION

APPROVED _____ MOTION BY _____
 REJECTED _____ SECONDED _____
 HELD _____ CARRIED _____

BOARD OF COMMISSIONERS DECISION

APPROVED _____ MOTION BY _____
 REJECTED _____ SECONDED _____
 HELD _____ CARRIED _____

STIPULATIONS:

